

31Z SERIES

General purpose - 3-way - Direct Acting

31Z Series are NC and NO pinch valves designed for use in a variety of analytical, medical and industrial applications. These valves are suitable for use with highly aggressive or uncontaminable fluids thanks to the hermetic separation of the mechanical parts and the fluid.



TECHNICAL DATA

TUBING SIZE	9 mm	
RECOMMENDED TUBING MATERIAL	VMQ	
RECOMMENDED TUBING HARDNESS	55 ± 3 ShA	
FLUIDS	Liquid, gases	
TUBE Ø - COIL WIDTH - SERIES	ø 13 mm - 52 mm	GDV14 (class H)
INSTALLATION	As required, preferably with actuator upright	
PROTECTION DEGREE	IP65 EN 60529 (DIN 40050) with plug connector	

■ MOPD values are referred to "standard power" coil range. Please refer to coil chapter.

MATERIALS

BODY	Anodized Aluminum
ARMATURE TUBE	Stainless steel AISI series 300 + Brass - UNI EN 12165 CW617N
FIXED CORE	Stainless steel AISI Series 400
PLUNGER	Stainless steel AISI Series 400
SPRING	Stainless steel AISI Series 300
PINCHING DEVICE	POM

3/2 NC - NO

TUBING OD	TUBING ID	MINIMUM THICKNESS	COIL SERIES	PINCHING FORCE	CODE	DRAWING REFERENCE
Ø [mm]	Ø [mm]	[mm]		[kgf]		
9	6,4	1,3	GDV14	1,25	31Z30G3S95	1

■ Other sizing available on request. Please contact ODE.

■ **CE**
- 2014/35/EU (LVD)
- 2014/30/EU (EMC)

■ **UL** recognized and **VDE**
approved coils are available
for this series, please refer
to coil section.

■ Chemical compatibility between fluid and tubing material shall be assessed with tubing manufacturer.
■ MOPD is for reference only. Please contact tubing manufacturers for maximum working pressure and temperature.

3/2 - NC - NO

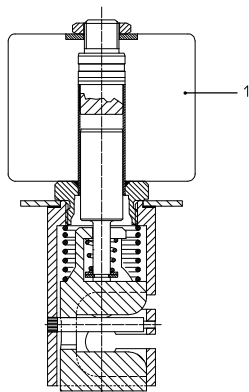

DRAWING 1

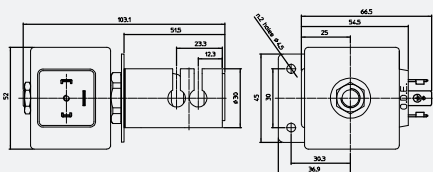

I

3

II

1

III

Z

IV

30

V

G

VI

3

VII

S

VIII

95

CODIFICATION

I. NUMBER OF WAYS
3 - 3-way

II. NUMBER OF ELEMENTS
1 - 1 element

III. SERIES
Z - pinch valves

IV. BODY DIAMETER [mm]

V. COIL TYPE
G - GDV, GDH Series

VI. VALVE TYPE
3 - 3/2 NC - NO

VII. TUBING MATERIAL
S - VMQ

VIII. TUBING SIZE CODE