

# 21WA-W - 21X -T5 SERIES

General Purpose, 2-way, Indirect Acting

**21WA-W** and **21X** are indirect acting solenoid valves. A minimum operating pressure differential of 0,1-0,2 bar is required for correct operation. A large selection of seal materials provides wide chemical compatibility. AC/DC interchangeability of the coil is possible for both NC and NO configurations. Slow closing, manual operator, NSF/ANSI 61-G versions are available on request.



## TECHNICAL DATA

PORT CONNECTION	G 3/8 ÷ 3				
SEALING MATERIALS	W, WA, X series		W, WA series		X series
	FKM	EPDM	NBR	HNBR	PTFE
FLUID TEMPERATURE	-10°C +140°C	-10°C +140°C	-10°C +90°C	-30°C +130°C	+60°C +180°C *
FLUIDS	oils, gasoline, diesel	water, steam	air, inert gases, water	air, inert gases, glycol	hot water, steam
VISCOSITY	max 12 cSt				
TUBE Ø - COIL WIDTH - SERIES	ø 10 mm - 22 mm		LB*2X (class F)		
	ø 10 mm - 22 mm		LB*05, LTA05 (class F), LBV05 (class H)		
	ø 13 mm - 30 mm		BDA08, BVA08 (class F), BDV08 (class H)		
INSTALLATION	as required, preferably with actuator upright				
PROTECTION DEGREE	IP65 EN 60529 (DIN 40050) with plug connector				

■ \*For a proper functioning of the solenoid valve the minimum temperature should not be less than +60°C; in order to ensure a long diaphragm life, steam filtration is recommended.

## MATERIALS

BODY, ORIFICE	Brass UNI EN 12165 CW617N or stainless steel AISI 316 Low lead brass for NSF 61 versions
ARMATURE TUBE	Stainless steel AISI Series 300
FIXED CORE	Stainless steel AISI Series 400
PLUNGER	Stainless steel AISI Series 400
PHASE DISPLACEMENT RING	Copper (Cu 99,9%) or gold plated copper
SPRING	Stainless steel AISI Series 300
SEALING	B=NBR, V=FKM, E=EPDM, F=HNBR, T=PTFE

### CE

- 2014/35/EU (LVD)  
- 2014/30/EU (EMC)  
- 2014/68/EU (PED)  
art. 4.3 - up to 1",  
cat. I module A - above 1" up to 2"  
cat. I module A (use only with  
gases of Group 2 or liquids) -  
above 2"

### INDUSTRIAL OXYGEN

Special versions suitable  
for contact with industrial  
oxygen are available.  
Please refer to codification options.

### UL recognized and VDE

approved coils are available  
for this series, please refer  
to coil section.

### EXPLOSION PROOF COILS

suitable for zone 2-22 are available  
for this series. Please refer to ATEX  
coil section for further details.

### NSF/ANSI 169 certification

(Special Food Equipment and Devices) is available  
for this series. Valves with NSF approval  
are in compliance with CE regulation  
1935/2004. List of certified product codes  
available in the following tables.

■ The fluids listed in the "technical data" tables should be considered as a recommendation.  
■ Please check the chemical compatibility of the fluids with the materials of the valve at RFQ stage.  
■ Operation with gases at high differential pressure can reduce the life of the diaphragm.  
■ For spare parts list, please refer to the dedicated chapter.

NC, BRASS

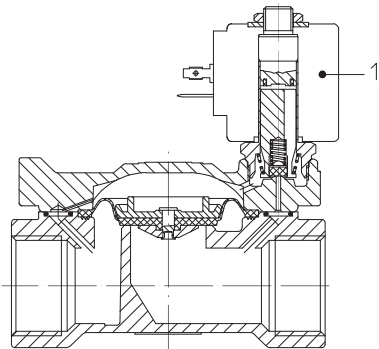

NC, STAINLESS STEEL,  
UP TO 3/4

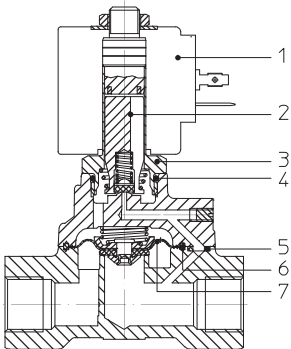

NC, BRASS,  
HIGH FLOW RATE

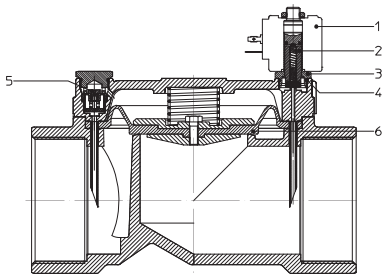

Solenoid Valves ■ General purpose ■ 2-way ■ Indirect Acting ■ **21WA-W - 21X SERIES**

DRAWING 1

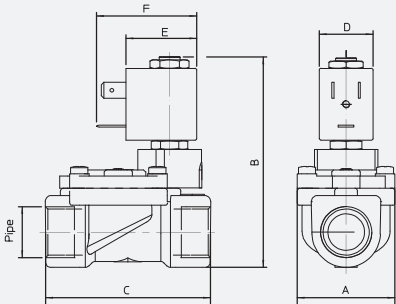

PIPE ISO 228/1	DIMENSIONS [mm]					
	A	B	C	D	E	F
G3/8	40	84,5	60	22	28±1	39,5
G1/2			66			

DRAWING 2

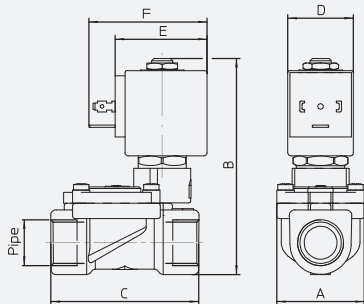

PIPE ISO 228/1	DIMENSIONS [mm]					
	A	B	C	D	E	F
G3/8	40	97	60	30	42	54
G1/2			66			

DRAWING 3

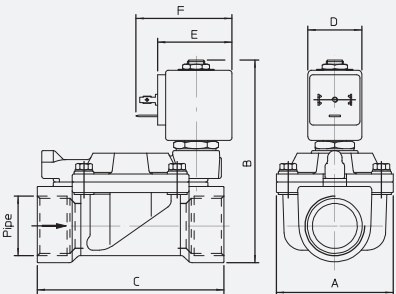

PIPE ISO 228/1	DIMENSIONS [mm]					
	A	B	C	D	E	F
G3/4	65	105	104	30	42	54
G1		112				
G1 1/4	98	125	144			
G1 1/2						
G2	118	141	172			

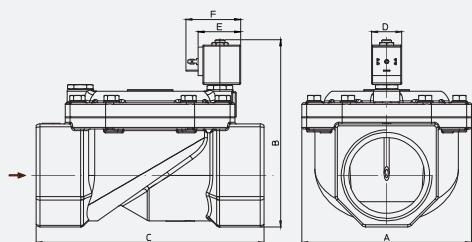
**DRAWING 4**

PIPE ISO 228/1	DIMENSIONS [mm]					
	A	B	C	D	E	F
G2 1/2	168	187	226	30	42	54
G3						

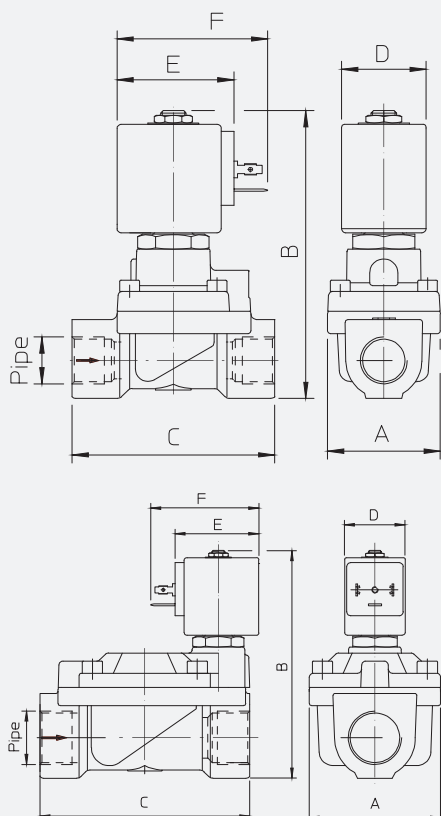
**DRAWING 5**

PIPE ISO 228/1	DIMENSIONS [mm]					
	A	B	C	D	E	F
G1/2	40	103	73	30	42	54
G3/4	65	115	104			
G1						

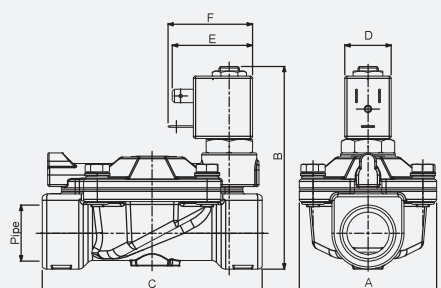
**DRAWING 6**

PIPE ISO 228/1	DIMENSIONS [mm]					
	A	B	C	D	E	F
G3/4	65	96	104	22	28±1	39,5
G1		105				

PIPE	ORIFICE SIZE	Kv	COIL SERIES	PRESSURE [bar]				CODE		DRAWING REFERENCE
ISO 228/1	Ø [mm]	[l/min]		MIN	MOPD (AIR, GASES)		PS	BRASS	STAINLESS STEEL	
					AC	DC				
G3/8	13	60	L**05	0,2	12	12	25	21WA3ROB130	-	1
			B**08	0,2	16	16	25	21WA3KOB130	-	2
G1/2	12	35	B**08	0,1	20	20	25	-	21X2KV120	5
	13	70	L**05	0,2	12	12	25	21WA4ROB130	-	1
			B**08	0,2	16	16	25	21WA4KOB130	-	2
G3/4	19	130	B**08	0,1	16	16	22	-	21X3KV190	5
		140	LB*2X	0,2	10	4	25	21W3RB190	-	6
			L**05	0,2	16	16	25	21W3RB190	-	6
			B**08	0,2	16	16	23	21W3KB190	-	3
G1	25	160	B**08	0,1	16	16	22	-	21X4KV250	5
		190	LB*2X	0,2	10	4	25	21W4RB250	-	6
			L**05	0,2	16	16	25	21W4RB250	-	6
			B**08	0,2	16	16	23	21W4KB250	-	3
G1 1/4	35	400	B**08	0,2	10	10	16	21W5KB350	-	3
G1 1/2	40	520	B**08	0,2	10	10	16	21W6KB400	-	3
G2	50	750	B**08	0,2	10	10	16	21W7KB500	-	3

■ For sealing different from NBR and FKM, replace the letter "B" and "V" with the ones corresponding to the other materials

Brass Body: V=FKM, B=NBR, E=EPDM, F=HNBR.

Stainless Steel Body: V=FKM, E=EPDM.

PIPE	ORIFICE SIZE	Kv	COIL SERIES	PRESSURE [bar]				CODE		DRAWING REFERENCE
ISO 228/1	Ø [mm]	[l/min]		MIN	MOPD (AIR, GASES)		PS	BRASS	STAINLESS STEEL	
					AC	DC				
G2 1/2	65	1250	B**08	0,3	5	5	20	21W8KB650	-	4
				3	15	15	20	21W8KB650-HP	-	4
G3	75	1400	B**08	0,3	5	5	20	21W9KB750	-	4
				3	15	15	20	21W9KB750-HP	-	4

■ The valve is delivered with assembled Ø1.2 mm nozzles.

■ Additional undersized and oversized nozzles are supplied to adjust opening and closing times.

■ High flow rate versions are available only with NBR diaphragm.

PIPE	ORIFICE SIZE	Kv	COIL SERIES	PRESSURE [bar]				CODE		DRAWING REFERENCE
ISO 228/1	Ø [mm]	[l/min]		MIN	MOPD (AIR, GASES)		PS	BRASS	STAINLESS STEEL	
					AC	DC				
G1/2	12	35	B**08	0,5	10	10	25	-	21X2KT120	5
G3/4	19	120	B**08	0,5	10	10	22	-	21X3KT190	5
G1	25	130	B**08	0,5	10	10	22	-	21X4KT250	5

■ Steam versions are available only with PTFE diaphragm.

■ \*For a proper functioning of the solenoid valve the minimum temperature should not be less than +60°C; in order to ensure a long diaphragm life, steam filtration is recommended.

2/2 NC





2/2 NC  
HIGH FLOW RATE2/2 NC  
FOR STEAM

## 2/2 NO

PIPE	ORIFICE SIZE	Kv	COIL SERIES	PRESSURE [bar]				CODE		DRAWING REFERENCE
ISO 228/1	Ø [mm]	[l/min]		MIN	MOPD (AIR, GASES)		PS	BRASS	STAINLESS STEEL	
					AC	DC				
G3/8	13	60	L**05	0,2	12	11	20	21WA3I0B130	-	1
			B**08	0,2	16	16	25	21WA3Z0B130	-	2
G1/2	12	35	B**08	0,1	20	20	25	-	21X2Z1V120D	5
	13	70	L**05	0,2	12	11	20	21WA4I0B130	-	1
			B**08	0,2	16	16	25	21WA4Z0B130	-	2
G3/4	19	140	B**08	0,1	16	16	25	-	21X3Z1V190D	5
			B**08	0,2	16	16	25	21W3ZB190	-	3
G1	25	160	B**08	0,1	16	16	25	-	21X4Z1V250D	5
		190	B**08	0,2	16	16	25	21W4ZB250	-	3
G1 1/4	35	400	B**08	0,2	10	10	16	21W5ZB350	-	3
G1 1/2	40	520	B**08	0,2	10	10	16	21W6ZB400	-	3
G2	50	750	B**08	0,2	10	10	16	21W7ZB500	-	3



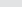

- For other sealing materials, replace the letter B or V with the ones corresponding to the required material.  
Brass Body: V=FKM, B=NBR, E=EPDM, F=HNBR.  
Stainless Steel Body: V=FKM, E=EPDM.

2/2 NC  
VALVES FOR  
DRINKING WATER  
SYSTEMS

PIPE	ORIFICE SIZE	Kv	COIL SERIES	PRESSURE [bar]				CODE		DRAWING REFERENCE
ISO 228/1	Ø [mm]	[l/min]		MIN	MOPD (AIR, GASES)		PS	BRASS	STAINLESS STEEL	
					AC	DC				
G3/8	13	60	B**08	0,2	16	16	25	21WA3K1E130-T5 	-	2
G1/2	13	70	B**08	0,2	16	16	25	21WA4K1E130-T5 	-	2
G3/4	19	140	B**08	0,2	16	16	25	21W3K1E190-T5 	-	3
G1	25	190	B**08	0,2	16	16	25	21W4K1E250-T5 	-	3

- Valves certified to NSF/ANSI 61-G, available with EPDM sealing.
- Available on request with minimum order quantity.

2/2 NO  
VALVES FOR  
DRINKING WATER  
SYSTEMS

PIPE	ORIFICE SIZE	Kv	COIL SERIES	PRESSURE [bar]				CODE		DRAWING REFERENCE
ISO 228/1	Ø [mm]	[l/min]		MIN	MOPD (AIR, GASES)		PS	BRASS	STAINLESS STEEL	
					AC	DC				
G3/8	13	60	B**08	0,2	16	16	23	21WA3Z1E130-T5 	-	2
G1/2	13	70	B**08	0,2	16	16	23	21WA4Z1E130-T5 	-	2
G3/4	19	140	B**08	0,2	16	16	23	21W3Z1E190-T5 	-	3
G1	25	190	B**08	0,2	16	16	23	21W4Z1E250-T5 	-	3

- Valves certified to NSF/ANSI 61-G, available with EPDM sealing.
- Available on request with minimum order quantity.

I	II	III	IV	V	VI	VII	VIII	IX	X	CODIFICATION
2	1		W	3	K		B	130	-	
I. NUMBER OF WAYS 2 - 2-way			VI. CORE TUBE TYPE K - for 2/2 NC valves, B**08 coil Z - for 2/2 NO valves, B**08 coil R - for 2/2 NC valves, LB*2X and L**05 coils I - for 2/2 NO valves, L**05 coil			IX. ORIFICE Ø [mm] MULTIPLIED BY 10				
II. NUMBER OF ELEMENTS 1 - 1 element			VII. PHASE DISP. RING MATERIAL O or blank - copper 1 - gold plated copper			X. OPTIONS PC - progressive closing M - manual override MR - manual override and closing speed adjustment MM - spring over diaphragm N - nickel plated body HP - high pressure OX - degreasing for industrial oxygen use T5 - NSF/ANSI 61 certification				
III. ARMATURE TUBE MATERIAL Blank - std 6 - AISI 316 (optional, valid for NC versions, brass body only)			VIII. SEALING MATERIAL V - FKM E - EPDM B - NBR F - HNBR T - PTFE*							
IV. SERIES WA - G3/8 and G1/2, brass body W - above G1/2, brass body X - StSt body										
V. CONNECTIONS for WA series 3 - G3/8 4 - G1/2 for W and X series 3 - G3/4 4 - G1 5 - G1 1/4 6 - G1 1/2 7 - G2 8 - G2 1/2 9 - G3										

\*available only for X series, steam version.

OPTION	VALVE TYPE	BODY MATERIAL	SEALING MATERIAL	COIL SERIES	VALVE SIZE/CONNECTIONS									NOTES
					G3/8	G1/2	G3/4	G1	G1 1/4	G1 1/2	G2	G2 1/2	G3	
PC	2/2 NC	Brass	B, V, E, F	B**08	X	X	X	X						
M	2/2 NC	Brass	B, V, E, F	LB*2X	X	X								
				L**05										
				B**08	X	X	X	X	X	X	X			
MR	2/2 NC	Brass	B, V, E, F	B**08			X	X	X	X	X			
MM	2/2 NC	Brass	B, V, E, F	LB*2X	X	X								
				L**05										
				B**08										
N	2/2 NC	Brass	B, V, E, F	B**08	X	X	X	X	X	X	X			
HP	2/2 NC	Brass	B, V, E, F	B**08								X	X	
OX	2/2 NC, NO	Brass	V	B**08	X	X	X	X	X	X	X			PS & MOPD limited to 25 bar. Shall not be used as safety valves
T5	2/2 NC, NO	Brass	E	B**08	X	X	X	X						Ref. to drinking water valves' section

# 21H SERIES

## General Purpose, 2-way, Indirect Acting

**21H** are indirect acting solenoid valves. The coil is positioned on the centre of the valve for maximum compactness. These valves require a minimum operating pressure of 0,1 bar. Silent closing version available. AC/DC interchangeability of the coil is possible for both NC and NO configurations.

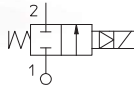

### TECHNICAL DATA

PORT CONNECTION	G3/8 to G3/4		
SEALING MATERIALS	NBR	FKM	EPDM
FLUID TEMPERATURE	-10°C +90°C	-10°C +140°C	-10°C +140°C
FLUIDS	Air, inert gas, water	oils, gasoline, diesel	Water, steam
VISCOSITY	max. 12 cSt		
TUBE Ø - COIL WIDTH - SERIES	ø 13 mm - 30 mm	BDA08, BVA08 (CLASS F), BDV08 (CLASS H)	
	ø 13 mm - 36 mm	UDV16 (CLASS H)	
	ø 13 mm - 52 mm	GDV14 (CLASS H)	
INSTALLATION	as required, preferably with actuator upright		
PROTECTION DEGREE	IP65 EN 60529 (DIN 40050) with plug connector		

■ MOPD values are referred to "standard power" coil range. Please refer to coil chapter.

### MATERIALS

<b>BODY, ORIFICE</b>	Brass UNI EN 12165 CW617N
<b>ARMATURE TUBE</b>	Stainless steel AISI Series 300
<b>FIXED CORE</b>	Stainless steel AISI Series 400
<b>PLUNGER</b>	Stainless steel AISI Series 400
<b>PHASE DISPLACEMENT RING</b>	Copper (Cu 99,9%) or gold plated copper
<b>SPRING</b>	Stainless steel AISI Series 300
<b>SEALING</b>	B=NBR, V=FKM, E=EPDM

#### ■ CE

- 2014/35/EU (LVD)  
- 2014/30/EU (EMC)  
- 2014/68/EU (PED)  
art. 4.3 up to 1"

#### ■ INDUSTRIAL OXYGEN

Special versions suitable for contact with industrial oxygen are available. Please refer to codification options.

#### ■ UL recognized and VDE

approved coils are available for this series, please refer to coil section.

#### ■ EXPLOSION PROOF COILS

suitable for zone 2-22 are available for this series. Please refer to ATEX coil section for further details.

- The fluids listed in the "technical data" tables should be considered as a recommendation. Please check the chemical compatibility of the fluids with the materials of the valve at RFQ stage.
- Operation with gases at high differential pressure can reduce the life of the diaphragm.
- For spare parts list, please refer to the dedicated chapter.

NC, G3/8 TO G1/2

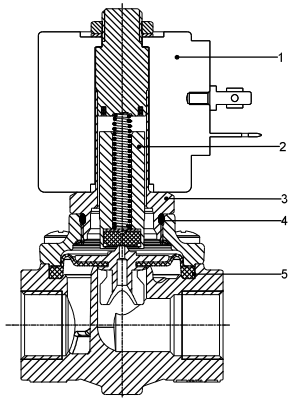

NC, G3/8 TO G1/2  
PROGRESSIVE CLOSING

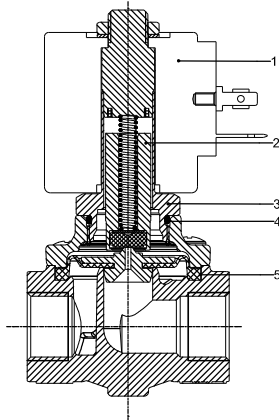

NC, G3/4

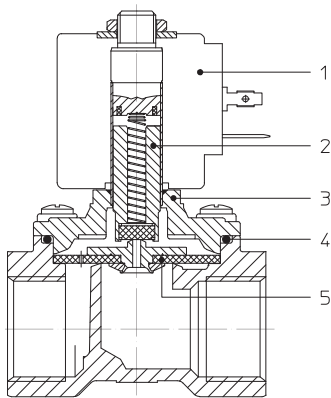

Solenoid Valves ■ General purpose ■ 2-way ■ Indirect Acting ■ **21H SERIES**

**DRAWING 1**

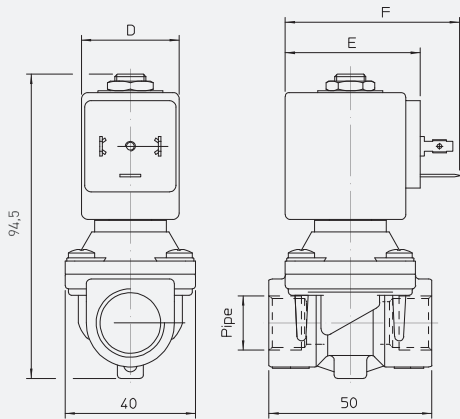

COIL SERIES	DIMENSIONS [mm]		
	D	E	F
B**08	30	42	54
UDV16	36	48	60
GDV14	52	55	67

**DRAWING 2**

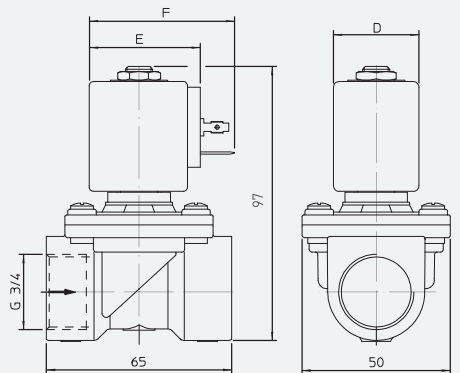



2/2 NC

PIPE	ORIFICE SIZE	Kv	COIL SERIES	PRESSURE [bar]				CODE		DRAWING REFERENCE
ISO 228/1	Ø [mm]	[l/min]		MIN	MOPD (LIQUIDS)		PS	BRASS	STAINLESS STEEL	
					AC	DC				
G3/8	12	35,0	B**08	0,1	20	10	20	21H7KV120	-	1
			UDV16	0,1	20	20	20	21H7KV120	-	1
			GDV14	0,1	20	20	20	21H7KV120	-	1
G1/2	12	45,0	B**08	0,1	20	10	20	21H8KV120	-	1
			UDV16	0,1	20	20	20	21H8KV120	-	1
			GDV14	0,1	20	20	20	21H8KV120	-	1
G3/4	18	50,0	B**08	0,1	16	3	16	21H9KV180	-	2
			UDV16	0,1	16	10	16	21H9KV180	-	2
			GDV14	0,1	16	16	16	21H9KV180	-	2

■ For sealing different from FKM, replace the letter "V" with the ones corresponding to the other materials.  
V=FKM, B = NBR, E = EPDM.

CODIFICATION

I	II	III	IV	V	VI	VII	VIII	IX
2	1	H	7	K		B	120	-

**I. NUMBER OF WAYS**  
2 - 2-way

**II. NUMBER OF ELEMENTS**  
1 - 1 element

**III. SERIES**  
H - indirect acting, compact body

**IV. CONNECTIONS**  
7 - G3/8  
8 - G1/2  
9 - G3/4

**V. CORE TUBE TYPE**  
KR - for 2/2 NC valves, 8 W coil

**VI. PHASE DISP. RING MATERIAL**  
O or blank - copper

**VII. SEALING MATERIAL**  
B - NBR  
V - FKM  
E - EPDM

**VIII. ORIFICE Ø [mm] MULTIPLIED BY 10**

**IX. OPTIONS**  
PC - progressive closing  
N - nickel plated body  
OX - oxygen version

OPTIONS AVAILABILITY

OPTION	VALVE TYPE	BODY MATERIAL	SEALING MATERIAL	VALVE SIZE/CONNECTIONS			NOTES
				G3/8	G1/2	G3/4	
PC	2/2 NC	Brass	B, V, E	X	X	X	
N	2/2 NC	Brass	B, V, E	X	X	X	
OX	2/2 NC	Brass	V	X	X		PS & MOPD limited to 25 bar. Shall not be used as safety valves.

■ Please contact ODE if you wish to combine more options.



# 21PW - 21A-PW SERIES

## General Purpose, 2-way, Indirect Acting

**21PW - 21A-PW** are indirect acting, piston solenoid valves. These valves require a minimum operating pressure of 0,3 bar. They are suitable for compressors. These solenoid valves are not suitable for stagnating fluids, or for fluids that being subject to evaporation may deposit solid, calcareous or similar residues. 2/2 NO valves are available also with 22 mm coils.



### TECHNICAL DATA

PORT CONNECTION	G 1/4		G 3/8 to G 1/2
SEALING MATERIALS	soft		hard
	FKM	hnbr	PTFE
FLUID TEMPERATURE	-10°C +140°C		
FLUIDS	Air, inert gas, water		
VISCOSITY	max. 12 cSt		
TUBE Ø - COIL WIDTH - SERIES	ø 10 mm - 22 mm		LBA05, LTA05 (class F), LBV05 (class H)
	ø 13 mm - 30 mm		BDA08, BVA08 (class F), BDV08 (class H)
	ø 13 mm - 30 mm		UDV16 (CLASS H)
	ø 13 mm - 30 mm		GDV14 (CLASS H)
INSTALLATION	as required, preferably with actuator upright		
PROTECTION DEGREE	IP65 EN 60529 (DIN 40050) with plug connector		

■ MOPD values are referred to "standard power" coil range. Please refer to coil chapter.

### MATERIALS

BODY, ORIFICE	Brass UNI EN 12165 CW617N
ARMATURE TUBE	Stainless steel AISI Series 300
FIXED CORE	Stainless steel AISI Series 400
PLUNGER	Stainless steel AISI Series 400
PHASE DISPLACEMENT RING	Copper (Cu 99.9%) or gold plated copper
SPRING	Stainless steel AISI Series 300
PISTON	Stainless steel AISI Series 300 + PPS (for G3/8 to G1/2)
PISTON SEAL	FKM (for G3/8 to G1/2)
SEALING	V=FKM, T=PTFE

■ **CE**  
- 2014/35/EU (LVD)  
- 2014/30/EU (EMC)  
- 2014/68/EU (PED),  
art. 4.3 up to 1"

■ **UL** recognized and **VDE**  
approved coils are available  
for this series, please refer  
to coil section.

■ **EXPLOSION PROOF COILS**  
suitable for zone 2-22 are available  
for this series. Please refer to ATEX  
coil section for further details.

■ The fluids listed in the "technical data" tables should be considered as a recommendation.  
Please check the chemical compatibility of the fluids with the materials of the valve at RFQ stage.  
■ For spare parts list please refer to the dedicated chapter.

NC, FKM, G3/8 AND G1/2

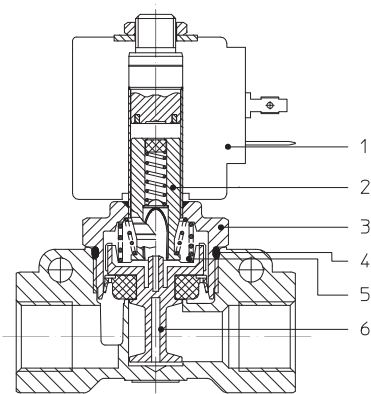

NO, PTFE, G3/8 AND G1/2 (SEZIONE PER 21PW SERIES)

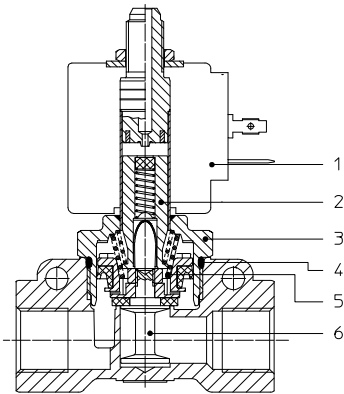

NO, G1/4

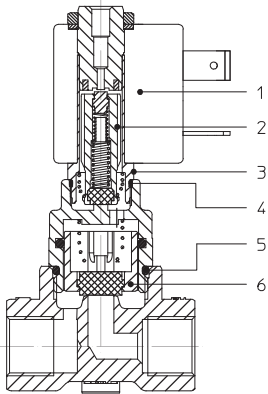

Solenoid Valves ■ General purpose ■ 2-way ■ Indirect Acting ■ 21PW - 21A-PW SERIES

DRAWING 1

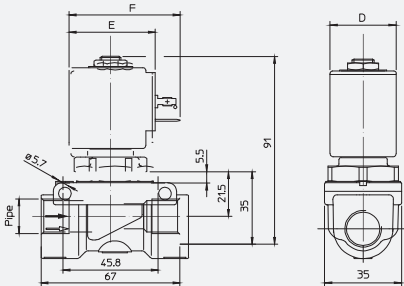

DRAWING 2

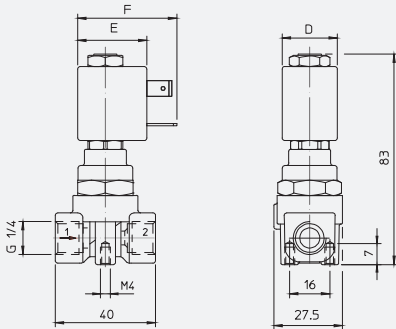

DRAWING 3

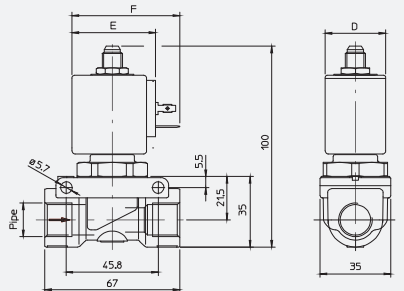

COIL SERIES	DIMENSIONS [mm]		
	D	E	F
L**05	22	28±1	39,5
B**08	30	42	54
UDV16	36	48	60
GDV14	52	55	67

2/2 NC WITH  
FKM SEALING

PIPE	ORIFICE SIZE	Kv	COIL SERIES	PRESSURE [bar]				CODE		DRAWING REFERENCE
ISO 228/1	Ø [mm]	[l/min]		MIN	MOPD		PS	BRASS	STAINLESS STEEL	
					AC	DC				
G3/8	12	32	B**08	0,3	15	-	25	21PW3K0V120	-	1
			UDV16	0,3	15	-	25	21PW3K0V120	-	1
			GDV14	0,3	15	10	25	21PW3K0V120	-	1
G1/2	12	38	B**08	0,3	15	-	25	21PW4K0V120	-	1
			UDV16	0,3	15	-	25	21PW4K0V120	-	1
			GDV14	0,3	15	10	25	21PW4K0V120	-	1

2/2 NC WITH  
PTFE SEALING

PIPE	ORIFICE SIZE	Kv	COIL SERIES	PRESSURE [bar]				CODE		DRAWING REFERENCE
ISO 228/1	Ø [mm]	[l/min]		MIN	MOPD		PS	BRASS	STAINLESS STEEL	
					AC	DC				
G3/8	12	32	B**08	0,5	18	-	25	21PW3K0T120	-	1
			UDV16	0,5	20	-	25	21PW3K0T120	-	1
			GDV14	0,5	20	15	25	21PW3K0T120	-	1
G1/2	12	38	B**08	0,5	18	-	25	21PW4K0T120	-	1
			UDV16	0,5	20	-	25	21PW4K0T120	-	1
			GDV14	0,5	20	15	25	21PW4K0T120	-	1

2/2 NO WITH  
SOFT SEALING

PIPE	ORIFICE SIZE	Kv	POWER RANGE	PRESSURE [bar]				CODE		DRAWING REFERENCE
ISO 228/1	Ø [mm]	[l/min]		MIN	MOPD		PS	BRASS	STAINLESS STEEL	
					AC	DC				
G1/4	5,5	9	L**05	0,5	12	-	25	21A2W0F55-PW	-	2
					15	-	25	21A2Y0F55-PW	-	2
G 3/8	12	32	B**08	0,3	15	15	25	21PW3FOV120	-	3
G 1/4	12	38	B**08	0,3	15	15	25	21PW4FOV120	-	3

2/2 NO WITH  
PTFE SEALING

PIPE	ORIFICE SIZE	Kv	POWER RANGE	PRESSURE [bar]				CODE		DRAWING REFERENCE
ISO 228/1	Ø [mm]	[l/min]		MIN	MOPD		PS	BRASS	STAINLESS STEEL	
					AC	DC				
G 3/8	12	32	B**08	0,5	18	18	25	21PW3F0T120	-	3
G 1/4	12	38	B**08	0,5	18	18	25	21PW3F0T120	-	3

I	II	III	IV	V	VI	VII	VIII	CODIFICATION 21 PW
2	1	PW	3	K	O	V	120	
I. NUMBER OF WAYS 2 - 2 - way		IV. CONNECTIONS 3 - G3/8 4 - G1/2		VI. SHADING COIL OPTIONS 0 - copper		VII. SEALING MATERIAL V - FKM T - PTFE		
II. NUMBER OF ELEMENTS 1 - 1 element		V. CORE TUBE TYPE K - for 2/2 NC valves F - for 2/2 NO valves		VIII. ORIFICE Ø [mm] MULTIPLIED BY 10				
III. SERIES PW - piston valve, up to G1/2								

I	II	III	IV	V	VI	VII	VIII		IX	CODIFICATION 21A - PW
2	1	A	2	Y	O	V	120	-	PW	
I. NUMBER OF WAYS 2 - 2 - way			V. CORE TUBE TYPE Y - for 2/2 NO 3rd way exhaust Ø1.2 mm W - for 2/2 NO 3rd way exhaust Ø1.5 mm			VIII. ORIFICE Ø [mm] MULTIPLIED BY 10				
II. NUMBER OF ELEMENTS 1 - 1 element			VI. PHASE DISP. RING MATERIAL O - copper			IX. VERSIONS PW - piston type				
III. SERIES A - piston valve, up to G1/4			VII. SEALING MATERIAL F - HNBR							
IV. CONNECTIONS 2 - G1/4										