

# **QUICK COUPLING FOR FLUIDS**

## EUROSTANDARD

### PLUS

**DIFFERENT RANGES WITH SECURITY  
SYSTEM AND ANTI-WHIPLASH,  
IN CONFORMITY WITH SAFETY  
STANDARDS**

---

**DIFFERENT MATERIALS  
FOR EVERY KIND OF APPLICATION**

---

**ARE INDICATED IN OXIDANT  
AND CORROSIVE ENVIROMENTS  
WITH VERSION IN AISI 316**

---

**EASY HANDLING  
AND CONNECTION/DISCONNECTION**

---

**AVAILABLE WITH FREE PASSAGE,  
SINGLE INTERCEPTED**





p. 534 /  
**EU-75N-M**



p. 534 /  
**EU-75N-H**



p. 534 /  
**EU-75N-E**



p. 535 /  
**EU-75N-PM**



p. 535 /  
**EU-75S-M**



p. 535 /  
**EU-75S-H**



p. 536 /  
**EU-75S-E**



p. 536 /  
**EU-75S-PM**



p. 536 /  
**AEU-75M**



p. 537 /  
**AEU-75H**



p. 537 /  
**AEU-75E**



p. 537 /  
**AEU-75PM**



GERMANY PROFILE

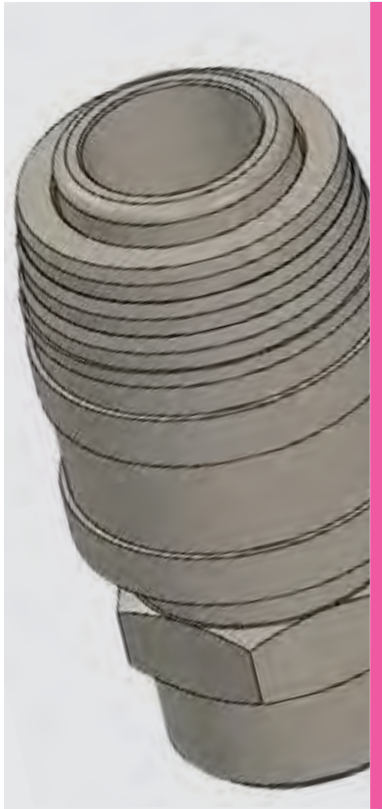

-  From -20°C to +100°C with NBR seal
-  From -20°C to +205°C with VITON seal
-  From -40°C to +130°C with EPDM seal
-  From -60°C to +200°C with SILICONE seal

 **Suggest:** From 0 to 12 Barr  
From 0 to 7 Bar for **SAFETY** version  
**Max:** 35 Bar

**FLOW**  
1125 l/min  
542 l/min for **SAFETY** version

 **DN** 7,6 mm

 Parallel BSPP from G1/4" to G1/2"  
Taper BSP from R1/4" to R1/2"

**CONFIGURATIONS**

PL (only for EUROSTANDARD no safety), SO



Products in compliance with the directive 2002/95/EC

**RoHS2**

Products in compliance with the directive 2011/65/EU

**FLOW DROP EUROSTANDARD**

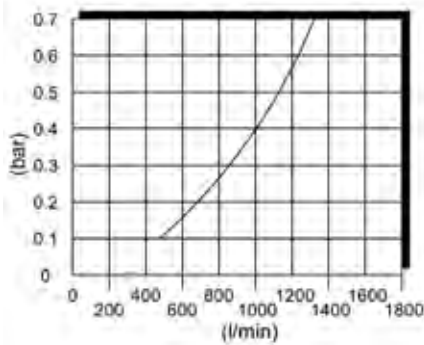

**FLOW DROP EUROSTANDARD SAFETY**

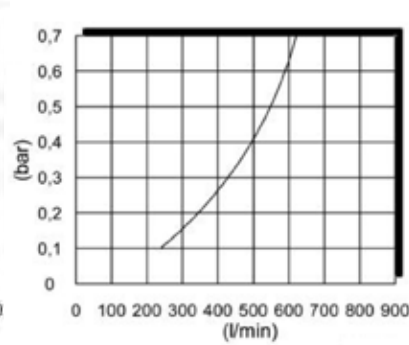

All charts have been created considering a pressure of 6 Bar with low drop of 0.5 bar and simple lock



Quick coupling Germany/European profile for pneumatic applications, in general for not aggressive and not oxidant fluids. They are indicated, especially for applications with pneumatic tools, compressed air equipment and industrial machineries. The version in AISI 316L is indicated in oxidant and corrosive environments and especially in sector as food, chemical, medical, analytical laboratories, instrumentation and desalinization of water. Easy handling, connection - disconnection with one hand.

Suitable for pneumatic applications in general. In conformity with the safety standards ISO 4414:2011. Especially suitable for applications with pneumatic tools, compressed air equipments and industrial machineries. Not suitable for direct connection to pneumatic devices. We recommend to use a tube of at least 30 cm length to absorb the device vibrations.



COMPONENTS	EU-75N	EU-75S	EU-75N-X	EU-75N-316
<b>Body</b>	Nickel-plated steel	Nickel-plated steel	Stainless steel AISI 303	Stainless steel AISI 316L
<b>Slide</b>	Nickel-plated steel	Nickel-plated steel	Stainless steel AISI 303	Stainless steel AISI 316L
<b>Adapter</b>	Nickel-plated brass	Nickel-plated brass	Stainless steel AISI 303	Stainless steel AISI 316L
<b>Valve</b>	Nickel-plated brass	Nickel-plated brass	Stainless steel AISI 303	Stainless steel AISI 316L
<b>Ball</b>	Chrome steel	Chrome steel	Stainless steel AISI 316	Stainless steel AISI 316
<b>Seal</b>	NBR, VITON, VITON (FDA), EPDM, SILICON	NBR	NBR, VITON, VITON (FDA), EPDM, SILICON	NBR, VITON, VITON (FDA), EPDM, SILICON
<b>Spring</b>	Stainless steel AISI 302	Stainless steel AISI 302	Stainless steel AISI 302	Stainless steel AISI 302
<b>Retaining ring</b>	Stainless steel AISI 302	Stainless steel AISI 302	Stainless steel AISI 302	Stainless steel AISI 302
CONNECTION	AEU-75	AEU-75-X	AEU-75-316	
<b>Body</b>	Nickel-plated steel	Stainless steel AISI 303	Stainless steel AISI 316L	



**EU-75N-M**

Male quick coupler



CODE	T	P	L	D	H
EU-75N-M1/4	R1/4"	24,4	51,7	21,5	19
EU-75N-M1/4-X	R1/4"	24,4	51,7	21,5	19
EU-75N-M1/4-316V	R1/4"	24,4	51,7	21,5	19
EU-75N-M3/8	R3/8"	24,4	52,7	21,5	19
EU-75N-M3/8-X	R3/8"	24,4	52,7	21,5	19
EU-75N-M3/8-316V	R3/8"	24,4	52,7	21,5	19
EU-75N-M1/2	R1/2"	24,4	57,2	24,6	22
EU-75N-M1/2-X	R1/2"	24,4	57,2	24,6	22
EU-75N-M1/2-316V	R1/2"	24,4	57,2	24,6	22
EU-75N-M1/2G	G1/2"	24,4	54,7	26,5	24

**EU-75N-H**

Female quick coupler



CODE	T	P	L	D	H
EU-75N-H1/4	G1/4"	24,4	49,7	21,5	19
EU-75N-H1/4-X	G1/4"	24,4	49,7	21,5	19
EU-75N-H1/4-316V	G1/4"	24,4	49,7	21,5	19
EU-75N-H3/8	G3/8"	24,4	51,2	24,6	22
EU-75N-H3/8-X	G3/8"	24,4	51,2	24,6	22
EU-75N-H3/8-316V	G3/8"	24,4	51,2	24,6	22
EU-75N-H1/2	G1/2"	24,4	55,4	27,5	25
EU-75N-H1/2-X	G1/2"	24,4	26,5	24	-
EU-75N-H1/2-316V	G1/2"	24,4	26,5	24	-

**EU-75N-E**

Quick coupler with barb connector



CODE	E	L	D	P	H
EU-75N-E6	7,20	59,2	21,5	24,4	19
EU-75N-E8	9,20	59,2	21,5	24,4	19
EU-75N-E8-X	9,20	59,2	21,5	24,4	19
EU-75N-E8-316V	9,20	59,2	21,5	24,4	19
EU-75N-E10	11,20	63,2	21,5	24,4	19
EU-75N-E10-X	11,20	63,2	21,5	24,4	19
EU-75N-E10-316V	11,20	63,2	21,5	24,4	19
EU-75N-E12	13,20	68,2	21,5	24,4	19
EU-75N-E12-X	13,20	-	21,5	24,4	19
EU-75N-E13	13,80	68,2	21,5	24,4	19



**EU-75N-PM**

Joint push-on fitting

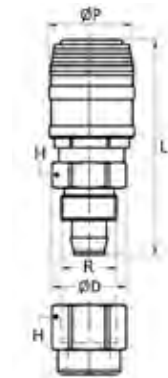

CODE	Ø TUBE	D	R	P	L	H
EU-75N-PM08	8X12	21,3	M16X1	24,4	61,9	19
EU-75N-PM10	10X15	24,3	M20X1	24,4	62,6	22

To used with PU-PVC

**EU-75S-M**

Safety male quick coupler

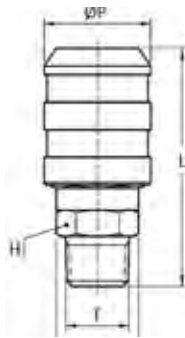

CODE	T	ØP	L	ØD	H
EU-75S-M1/4	R1/4"	28,5	53,6	21,5	19
EU-75S-M3/8	R3/8"	28,5	54,6	21,5	19
EU-75S-M1/2	R1/2"	28,5	59,1	24,6	22
EU-75S-M1/2G	G1/2"	28,5	56,6	26,5	24

**EU-75S-H**

Safety female quick coupler

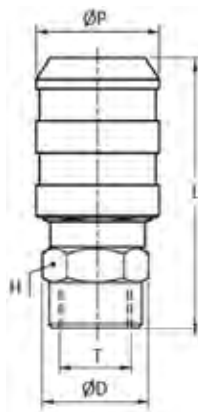

CODE	T	ØP	L	ØD	H
EU-75S-H1/4	G1/4"	28,5	51,6	21,5	19
EU-75S-H3/8	G3/8"	28,5	53,1	24,6	22
EU-75S-H1/2	G1/2"	28,5	57,3	27,5	25



**EU-75S-E**

Safety quick coupler with barb connector

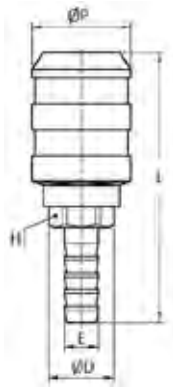

CODE	ØE	L	ØD	ØP	H
EU-75S-E6	7,20	61,1	21,5	28,5	19
EU-75S-E8	9,20	61,1	21,5	28,5	19
EU-75S-E10	11,2	65,1	21,5	28,5	19
EU-75S-E12	13,2	70,1	21,5	28,5	19
EU-75S-E13	13,8	70,1	21,5	28,5	19

**EU-75S-PM**

Joint push-on fitting

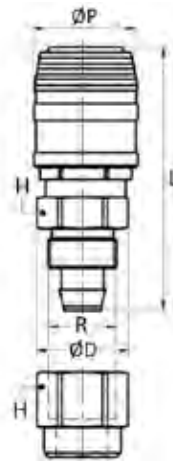

CODE	Ø TUBE	D	R	P	L	H
EU-75S-PM08	8X12	21,3	M16X1	28,5	65,2	19
EU-75S-PM10	10X15	24,3	M20X1	28,5	70	22

To used with PU-PVC

**AEU-75M**

Male connection

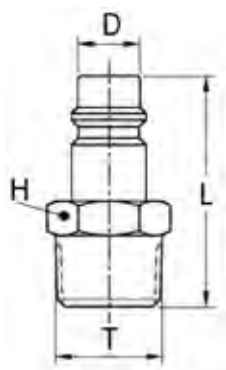

CODE	T	D	L	H
AEU-75M	R1/4"	10	36,5	14
AEU-75M-X	R1/4"	10	36,5	14
AEU-75M-316	R1/4"	10	36,5	14
AEU-75M38	R3/8"	10	37,0	17
AEU-75M38-316	R3/8"	10	37,0	17
AEU-75M12	R1/2"	10	42,0	22
AEU-75M12-316	R1/2"	10	42,0	22



### AEU-75H

Female connection

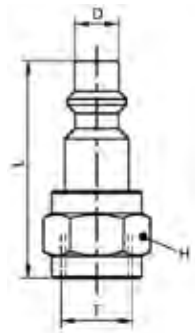

CODE	T	D	L	H
AEU-75H	G1/4"	10	34,0	17
AEU-75H-X	G1/4"	10	34,0	17
AEU-75H-316	G1/4"	10	34,0	17
AEU-75H38	G3/8"	10	34,5	20
AEU-75H38-316	G3/8"	10	34,5	22
AEU-75H12	G1/2"	10	40,0	24
AEU-75H12-316	G1/2"	10	40,0	24

### AEU-75E

Connection with barb connector

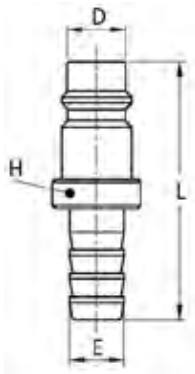

CODE	E	D	L	H
AEU-75E	9,2	10	44,0	15,0
AEU-75E-X	9,2	10	44,0	15,0
AEU-75E-10	11,2	10	48,0	15,0
AEU-75E-10-316	11,2	10	48,0	15,0
AEU-75E12	13,2	10	48,0	17,0
AEU-75E-12-316	13,2	10	48,0	17,0

### AEU-75PM

Connection with push-on fitting

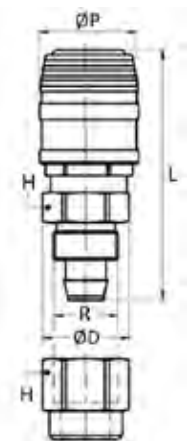

CODE	Ø TUBE	D	R	L	H
AEU-75PM08	8X12	10	M16X1	46,7	19
AEU-75PM10	10X15	10	M20X1	51,5	22

To used with PU-PVC



