

INNESTI RAPIDI INOX AISI 316 • *push-in fittings INOX AISI 316*

LEGENDA CODICE • *Model designation*

Filetto Conico BSPT - *BSPT Thread*

SXC	04	R01
SXC	04	M5
SXC	04	G01
↓	↓	↓
Codice Code	Diametro Tubo tube diameter	Filetto thread size

Code	Size
04	4mm
06	6mm
08	8mm
10	10mm
12	12mm
14	14mm

Conico BSPT BSPT thread	
01	R1/8"
02	R1/4"
03	R3/8"
04	R1/2"

Metrico Metric Thread	
M5	M5

Cilindrico BSPP BSPP thread	
01	G1/8"
02	G1/4"
03	G3/8"
04	G1/2"

TOLLERANZA DIAMETRO ESTERNO TUBO • *Outer diameter tube tolerance*

Tubo • tube	Ø 4mm	Ø 6mm	Ø 8mm	Ø 10mm	Ø 12mm	Ø 14mm
PTFE-C	± 0,1	± 0,1	± 0,1	± 0,1	± 0,1	± 0,1
FEP	± 0,1	± 0,1	± 0,1	/	/	/

SEZIONE INTERNA • *Construction*

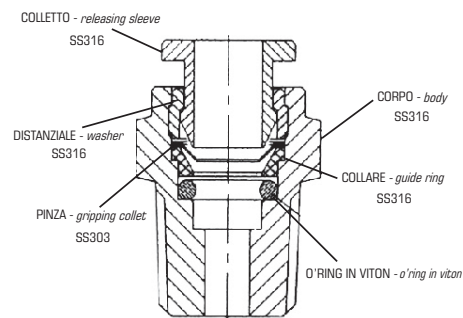

DATI TECNICI

Applicazioni	Pneumatica, Fluidi & Settore Alimentare, Chimico, Medicale Farmaceutico e Nautico
Materiali utilizzati	Corpo: acciaio Inox AISI 316 ASTM A-479: SXC, SXMM, SXUC, SXGJ, SXTR ASTM A-182: tutti gli altri raccordi Colletto (pinza di sgancio): Acciaio inox AISI 316 Pinza di Tenuta: inox AISI 303 O'Ring : Viton
Filettature	Gas Conica ISO 7 BSPT da 1/8" a 1/2" Gas Cilindrica ISO 228 BSPP da 1/8" a 1/2" Metrica M5
Trattamento della superficie	Ogni componente in acciaio inox subisce un trattamento di elettropulitura che garantisce la passivazione e la creazione di un rivestimento di ossido di cromo resistente alla corrosione
Pressione d'esercizio	20 Bar a 20°C
Temperatura d'esercizio	da -20°C a +150°C
Tubi compatibili	Polietilene (PE) Teflon Calibrato PTFE Fluoropolimero FEP 140 Tubo in Acciaio Inox (solo con scanalatura per aggancio pinza con attrezzo codice SX01UT)
Caratteristiche	I raccordi di questa serie sono idonei al contatto con fluidi aggressivi

Technical specifications

applications	<i>pneumatics, fluids, food, chemical, medical, pharmaceutical & marine applications</i>
materials used	<i>body: stainless steel AISI 316 ASTM A-479: SXC, SXMM, SXUC, SXGJ, SXTR ASTM A-182: all the other fittings collet: stainless steel AISI 316 lock claw: stainless steel AISI 303 o'ring: Viton</i>
threads	<i>Taper Gas Thread ISO 7 from 1/8" to 1/2" Cylindrical Gas ISO 228 from 1/8" to 1/2" Metric M5</i>
surface treatment	<i>each and every steel components of push-in fittings are electropolished to ensure a corrosion resistant surface layer of chromide oxide which is passive</i>
working pressure	<i>20 Bar at 20°C</i>
working temperature	<i>from -20°C to +150°C</i>
compatible tubes	<i>Polyethylene (PE) Calibrated Teflon PTFE Fluoropolymer FEP 140 Stainless steel tube when grooved with pre-grooving tool code (SX01UT)</i>
advantages	<i>the fittings of this range are also suitable for the contact with aggressive fluids</i>

INNESTI RAPIDI INOX AISI 316 • push-in fittings INOX AISI 316

diritto maschio conico BSPT • male connector BSPT thread

SXC



CODE	ØD	T	ØP	L1	L2	H(Hex)	Peso Weight(g)	
SXC 04R01	4	R1/8"	9,8	18,6	8,5	11,1	10,0	1
SXC 04R02		R1/4"		23,0	12,5	14,2	19,0	1
SXC 06R01	6	R1/8"	12,5	23,7	8,5	12,7	13,0	1
SXC 06R02		R1/4"		23,7	12,5	14,2	17,0	1
SXC 08R01	8	R1/8"	14,2	26,7	8,5	14,2	16,0	1
SXC 08R02		R1/4"		27,7	12,5	14,2	19,0	1
SXC 08R03		R3/8"		27,1	12,5	17,4	33,0	1
SXC 10R02	10	R1/4"	16,4	29,0	12,5	17,4	26,0	1
SXC 10R03		R3/8"		27,7	12,5	17,4	28,0	1
SXC 12R02	12	R1/4"	19,0	32,4	12,5	20,6	40,0	1
SXC 12R03		R3/8"		30,9	12,5	20,6	42,0	1
SXC 12R04		R1/2"		32,4	16,5	22,2	58,0	1
SXC 14R04 new	14	R1/2"	21,8	34,4	16,5	22,2	54,0	1

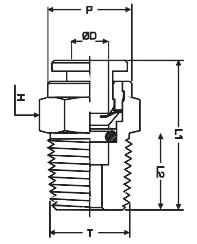

diritto maschio cilindrico BSPP & metrico • male connector BSPP & metric thread

CODE	ØD	T	ØP	L1	L2	H(Hex)	Peso Weight(g)	
SXC 04M5	4	M5	9,8	24,4	7,5	11,1	10,0	1
SXC 04G01		G1/8"		22,6	8,0	14,2	17,0	1
SXC 04G02		G1/4"		24,1	10,0	17,4	24,0	1
SXC 06M5 new	6	M5	12,5	24,8	5,5	12,7	10,0	1
SXC 06G01		G1/8"		24,6	8,0	14,2	16,0	1
SXC 06G02		G1/4"		24,6	10,0	17,4	23,0	1
SXC 08G01	8	G1/8"	14,2	27,6	8,0	14,2	17,0	1
SXC 08G02		G1/4"		26,6	10,0	17,4	24,0	1
SXC 08G03		G3/8"		26,7	10,0	20,6	37,0	1
SXC 10G02	10	G1/4"	16,4	29,6	10,0	17,4	28,0	1
SXC 10G03		G3/8"		26,8	10,0	20,6	35,0	1
SXC 12G02	12	G1/4"	19,0	31,0	10,0	20,6	35,0	1
SXC 12G03		G3/8"		31,0	10,0	20,6	40,0	1
SXC 12G04		G1/2"		30,5	12,0	27,0	64,0	1
SXC 14G04 new	14	G1/2"	21,8	31,5	12,0	27,0	103,0	1

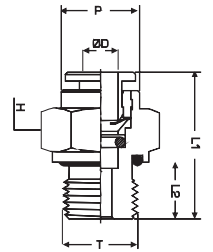

gomito maschio girevole conico BSPT • swivel male elbow BSPT thread

SXL



CODE	ØD	T	ØP	L1	L2	L3	H1(Hex)	H2(Hex)	Peso Weight(g)	
SXL 04R01	4	R1/8"	9,8	17,1	26,7	8,5	11,1	11,1	27,0	1
SXL 04R02		R1/4"		17,1	29,8	12,5	11,1	14,2	38,0	1
SXL 06R01	6	R1/8"	12,5	20,6	27,7	8,5	12,7	12,7	36,0	1
SXL 06R02		R1/4"		20,6	30,7	12,5	12,7	14,2	42,0	1
SXL 08R01	8	R1/8"	14,2	21,4	28,7	8,5	14,2	14,2	44,0	1
SXL 08R02		R1/4"		21,4	32,7	12,5	14,2	14,2	48,0	1
SXL 08R03		R3/8"		21,4	32,7	12,5	14,2	17,4	61,0	1
SXL 10R02	10	R1/4"	16,4	24,6	33,9	12,5	17,4	17,4	72,0	1
SXL 10R03		R3/8"		24,6	34,1	12,5	17,4	17,4	78,0	1
SXL 12R02	12	R1/4"	19,0	25,6	37,3	12,5	20,6	20,6	105,0	1
SXL 12R03		R3/8"		25,6	37,3	12,5	20,6	20,6	106,0	1
SXL 12R04		R1/2"		25,6	39,8	16,5	20,6	22,2	124,0	1
SXL 14R04 new	14	R1/2"	21,8	27,5	42,6	16,5	22,2	22,2	151,0	1

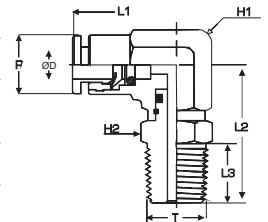

gomito maschio girevole cilindrico BSPP & metrico • swivel male elbow BSPP & metric thread

CODE	ØD	T	ØP	L1	L2	L3	H1(Hex)	H2(Hex)	Peso Weight(g)	
SXL 04M5	4	M5	9,8	17,1	26,5	7,5	11,1	11,1	27,0	1
SXL 04G01		G1/8"		17,1	26,9	8,0	11,1	14,2	31,0	1
SXL 04G02		G1/4"		17,1	28,9	10,0	11,1	17,4	41,0	1
SXL 06M5 new	6	M5	12,5	20,6	25,8	5,5	12,7	12,7	27,0	1
SXL 06G01		G1/8"		20,6	27,8	8,0	12,7	14,2	35,0	1
SXL 06G02		G1/4"		20,6	30,0	10,0	12,7	17,4	45,0	1
SXL 08G01	8	G1/8"	14,2	21,4	29,8	8,0	14,2	14,2	45,0	1
SXL 08G02		G1/4"		21,4	32,0	10,0	14,2	17,4	53,0	1
SXL 08G03		G3/8"		21,4	32,0	10,0	14,2	20,6	63,0	1
SXL 10G02	10	G1/4"	16,4	24,6	33,1	10,0	17,4	17,4	75,0	1
SXL 10G03		G3/8"		24,6	33,1	10,0	17,4	20,6	80,0	1
SXL 12G02	12	G1/4"	19,0	25,6	35,3	10,0	20,6	19,0	103,0	1
SXL 12G03		G3/8"		25,6	35,8	10,0	20,6	20,6	103,0	1
SXL 12G04		G1/2"		25,6	38,8	12,0	20,6	27,0	132,0	1
SXL 14G04 new	14	G1/2"	21,8	27,5	40,8	12,0	22,2	27,0	162,0	1

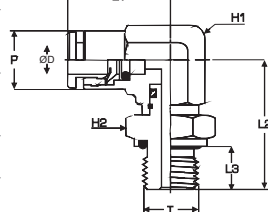

INNESTI RAPIDI INOX AISI 316 • push-in fittings INOX AISI 316

gomito maschio fisso conico BSPT • fixed male elbow BSPT thread

SXME

CODE	ØD	T	ØP	L1	L2	L3	H(Hex)	Peso Weight(g)	
SXME 04R01	4	R1/8"	9,8	16,4	17,3	8,5	11,1	20,0	1
SXME 04R02		R1/4"		18,0	23,5	12,5	14,2	45,0	1
SXME 06R01	6	R1/8"	12,5	20,6	18,0	8,5	12,7	30,0	1
SXME 06R02		R1/4"		21,4	23,5	12,5	14,2	42,0	1
SXME 08R01	8	R1/8"	14,2	21,4	19,5	8,5	14,2	33,0	1
SXME 08R02		R1/4"		21,4	23,5	12,5	14,2	39,0	1
SXME 08R03		R3/8"		24,6	25,2	12,5	17,4	64,0	1
SXME 10R02	10	R1/4"	16,4	24,6	25,2	12,5	17,4	88,0	1
SXME 10R03		R3/8"		24,6	25,2	12,5	17,4	64,0	1
SXME 12R02	12	R1/4"	19,0	25,6	26,9	12,5	20,6	82,0	1
SXME 12R03		R3/8"		25,6	26,9	12,5	20,6	88,0	1
SXME 12R04		R1/2"		25,6	30,9	16,5	20,6	127,0	1

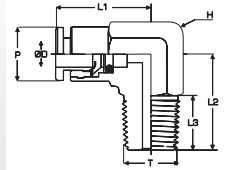

49

INNESTI RAPIDI • push-in fittings

T maschio girevole conico BSPT • swivel male tee BSPT thread

SXT

CODE	ØD	T	ØP	L1	L2	L3	H1(Hex)	H2(Hex)	Peso Weight(g)	
SXT 04R01	4	R1/8"	9,8	34,2	26,7	8,5	11,1	11,1	35,0	1
SXT 04R02		R1/4"		34,2	29,8	12,5	11,1	14,2	48,0	1
SXT 06R01	6	R1/8"	12,5	41,2	27,7	8,5	12,7	12,7	42,0	1
SXT 06R02		R1/4"		41,2	30,7	12,5	12,7	14,2	48,0	1
SXT 08R01	8	R1/8"	14,2	42,8	28,7	8,5	14,2	14,2	53,0	1
SXT 08R02		R1/4"		42,8	32,7	12,5	14,2	14,2	59,0	1
SXT 08R03		R3/8"		42,8	32,7	12,5	14,2	17,4	70,0	1
SXT 10R02	10	R1/4"	16,4	49,2	33,9	12,5	17,4	17,4	86,0	1
SXT 10R03		R3/8"		49,2	34,1	12,5	17,4	17,4	93,0	1
SXT 12R02	12	R1/4"	19,0	51,2	37,3	12,5	20,6	20,6	123,0	1
SXT 12R03		R3/8"		51,2	37,3	12,5	20,6	20,6	128,0	1
SXT 12R04		R1/2"		51,2	39,8	16,5	20,6	22,2	145,0	1

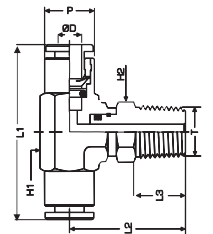

T maschio girevole cilindrico BSPP & metrico • swivel male tee BSPP & metric thread

CODE	ØD	T	ØP	L1	L2	L3	H1(Hex)	H2(Hex)	Peso Weight(g)	
SXT 04M5	4	M5	9,8	34,2	26,5	7,5	11,1	11,1	31,0	1
SXT 04G01		G1/8"		34,2	26,9	8,0	11,1	14,2	36,0	1
SXT 04G02	6	G1/4"	12,5	34,2	28,9	10,0	11,1	17,4	44,0	1
SXT 06G01		G1/8"		41,2	27,8	8,0	12,7	14,2	45,0	1
SXT 06G02	8	G1/4"	14,2	41,2	30,0	10,0	12,7	17,4	53,0	1
SXT 08G01		G1/8"		42,8	29,8	8,0	14,2	14,2	53,0	1
SXT 08G02	10	G1/4"	16,4	42,8	32,0	10,0	14,2	17,4	60,0	1
SXT 08G03		G3/8"		42,8	32,0	10,0	14,2	20,6	72,0	1
SXT 10G02	12	G1/4"	19,0	49,2	33,1	10,0	17,4	17,4	84,0	1
SXT 10G03		G3/8"		49,2	33,1	10,0	17,4	20,6	91,0	1
SXT 12G02	12	G1/4"	19,0	51,2	35,3	10,0	20,6	19,0	122,0	1
SXT 12G03		G3/8"		51,2	35,8	10,0	20,6	20,6	129,0	1
SXT 12G04		G1/2"		51,2	38,8	12,0	20,6	27,0	149,0	1

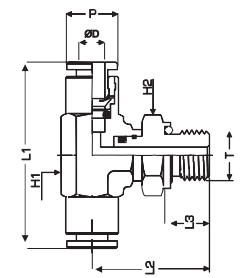

T laterale maschio girevole conico BSPT • swivel lateral male tee BSPT thread

SXST

CODE	ØD	T	ØP	L1	L2	L3	H1(Hex)	H2(Hex)	Peso Weight(g)	
SXST 04R01	4	R1/8"	9,8	17,1	26,7	8,5	11,1	11,1	35,0	1
SXST 04R02		R1/4"		17,1	29,8	12,5	11,1	14,2	48,0	1
SXST 06R01	6	R1/8"	12,5	20,6	27,7	8,5	12,7	12,7	42,0	1
SXST 06R02		R1/4"		20,6	30,7	12,5	12,7	14,2	48,0	1
SXST 08R01	8	R1/8"	14,2	21,4	28,7	8,5	14,2	14,2	53,0	1
SXST 08R02		R1/4"		21,4	32,7	12,5	14,2	14,2	59,0	1
SXST 08R03		R3/8"		21,4	32,7	12,5	14,2	17,4	70,0	1
SXST 10R02	10	R1/4"	16,4	24,6	33,9	12,5	17,4	17,4	86,0	1
SXST 10R03		R3/8"		24,6	34,1	12,5	17,4	17,4	93,0	1
SXST 12R02	12	R1/4"	19,0	25,6	37,3	12,5	20,6	20,6	123,0	1
SXST 12R03		R3/8"		25,6	37,3	12,5	20,6	20,6	128,0	1
SXST 12R04		R1/2"		25,6	39,8	16,5	20,6	22,2	145,0	1

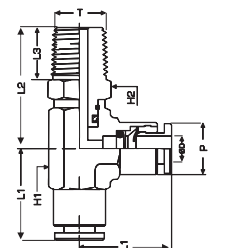

INNESTI RAPIDI INOX AISI 316 • push-in fittings INOX AISI 316

passaparete • bulkhead connector

SXMM

CODE	ØD	T	ØP	L	A max	H(Hex)	Peso Weight(g)	
SXMM 0400	4	M11X0,75	9,8	32,7	6,0	14,2	24,0	1
SXMM 0600	6	M13X1	12,5	35,7	6,0	19,0	38,0	1
SXMM 0800	8	M16X1,25	14,2	36,7	6,0	20,6	45,0	1
SXMM 1000	10	M18X1	16,4	43,2	8,0	22,2	64,0	1
SXMM 1200	12	M22X1,5	19,0	46,8	10,0	27,0	100,0	1

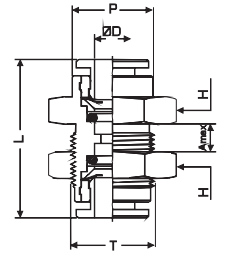

50

INNESTI RAPIDI • push-in fittings

intermedio diritto • union connector

SXUC

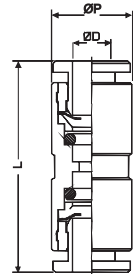

CODE	ØD	ØP	L	Peso Weight(g)	
SXUC 0400	4	9,8	29,2	14,0	1
SXUC 0600	6	12,5	34,6	20,0	1
SXUC 0800	8	14,2	34,6	21,0	1
SXUC 1000	10	16,4	35,7	30,0	1
SXUC 1200	12	19,0	37,8	40,0	1
SXUC 1400 new	14	21,8	40,8	53,0	1



intermedio a gomito • union elbow

SXUL

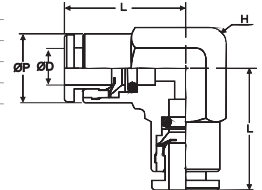

CODE	ØD	ØP	L	H(Hex)	Peso Weight(g)	
SXUL 0400	4	9,8	16,4	11,1	21,0	1
SXUL 0600	6	12,5	20,6	12,7	27,0	1
SXUL 0800	8	14,2	21,4	14,2	35,0	1
SXUL 1000	10	16,4	24,6	17,4	58,0	1
SXUL 1200	12	19,0	25,6	20,6	83,0	1
SXUL 1400 new	14	21,8	27,5	22,2	107,0	1



intermedio a T • union tee

SXUT

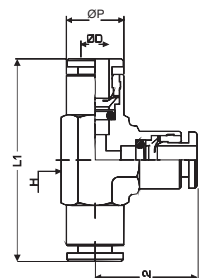
CODE	ØD	ØP	L1	L2	H(Hex)	Peso Weight(g)	
SXUT 0400	4	9,8	32,8	16,4	11,1	27,0	1
SXUT 0600	6	12,5	41,2	20,6	12,7	37,0	1
SXUT 0800	8	14,2	42,8	21,4	14,2	43,0	1
SXUT 1000	10	16,4	49,2	24,6	17,4	68,0	1
SXUT 1200	12	19,0	51,2	25,6	20,6	99,0	1
SXUT 1400 new	14	21,8	55,0	27,5	22,2	129,0	1



INNESTI RAPIDI INOX AISI 316 • push-in fittings INOX AISI 316

riduzione • reducer

SXGJ

CODE	ØD1	ØD2	P	L	Peso Weight(g)	
SXGJ 0604	6	4	9,8	35,6	11,0	1
SXGJ 0804	8	4	9,8	35,6	14,0	1
SXGJ 0806	8	6	12,5	42,1	17,0	1
SXGJ 1006	10	6	12,5	43,1	23,0	1
SXGJ 1008	10	8	14,2	43,1	23,0	1
SXGJ 1208	12	8	14,2	46,1	31,0	1
SXGJ 1210	12	10	16,4	46,6	31,0	1
SXGJ 1412	14	12	19,0	50,0	40,0	1

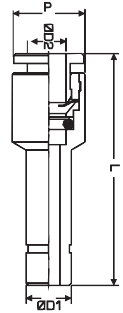

51

INNESTI RAPIDI • push-in fittings

SXTR

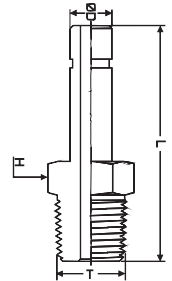

adattatore conico BSPT • adapter BSPT thread

CODE	ØD	T	L	H(Hex)	Peso Weight(g)	
SXTR 04R01	4	R1/8"	35,0	11,1	11,0	1
SXTR 04R02	4	R1/4"	39,0	14,2	20,0	1
SXTR 06R01	6	R1/8"	40,0	11,1	11,0	1
SXTR 06R02	6	R1/4"	44,0	14,2	22,0	1
SXTR 08R01	8	R1/8"	40,0	11,1	13,0	1
SXTR 08R02	8	R1/4"	44,0	14,2	23,0	1
SXTR 08R03	8	R3/8"	44,0	17,4	35,0	1
SXTR 10R02	10	R1/4"	47,5	14,2	24,0	1
SXTR 10R03	10	R3/8"	47,5	17,4	37,0	1

SXTA

adattatore cilindrico BSPP & metrico • adapter BSPP & metric thread

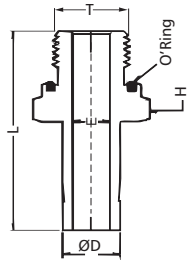
CODE	ØD	T	L1	H(Hex)	Peso Weight(g)	
SXTA 04M5	4	M5	35,7	11,1	8,0	1
SXTA 04G01	4	G1/8"	36,2	14,2	15,0	1
SXTA 04G02	4	G1/4"	38,2	17,4	25,0	1
SXTA 06G01	6	G1/8"	41,2	14,2	16,0	1
SXTA 06G02	6	G1/4"	43,2	17,4	27,0	1
SXTA 08G01	8	G1/8"	41,2	14,2	18,0	1
SXTA 08G02	8	G1/4"	43,2	17,4	28,0	1
SXTA 10G02	10	G1/4"	46,8	17,4	30,0	1
SXTA 10G03	10	G3/8"	46,8	20,6	44,0	1
SXTA 12G02	12	G1/4"	48,8	20,6	37,0	1
SXTA 12G03	12	G3/8"	48,8	20,6	45,0	1



utensile manuale per scanalatura tubo inox • pre-grooving tool for stainless steel tubing

SX01UT

CODE	K	I	L	Peso Weight(g)	
SX01UT	25	30	105	290	1

Questo utensile viene utilizzato per garantire un perfetto aggraffaggio del tubo inox con il raccordo serie SX. Una scala graduata permette di scanalare i tubi dal Ø esterno 4mm al Ø esterno 12mm.
 This tooling is used to guarantee a correct gripping between the stainless steel tubing and push-in fitting.
 A graduated scale allow to make the pre-grooving mark from outside diameter 4mm up to 12mm.

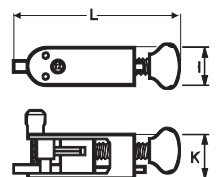
NEW

