

## SERBATOI • tanks

### LEGENDA CODICE • Model designation

### NEW RANGE

SB	304	TR	100	190	STU
↓	↓		↓	↓	↓
Codice code	Materiale AISI 304 material AISI 304		Diametro diameter	Altezza height	Tipo di fissaggio type fixing

Serbatoio per aria compressa in Acciaio Inox AISI 304 per uso alimentare.

Qualifica di saldatura bureau veritas WPAR n° 2374, n° 2375, n° 2376 secondo norma EN 15614-1/1418/287-1

*Tank for compressed air in Stainless Steel AISI 304 for food.*

*Qualification welding bureau veritas WPAR No. 2374, No. 2375, No. 2376 according to standard EN 15614-1/1418/287-1*



**A**

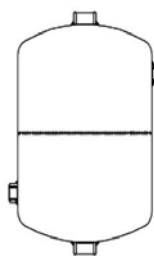

**B**

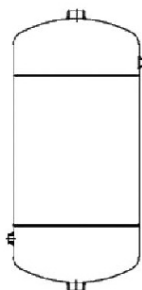

**A:** Serbatoio a due calotte, una bordata ed una rifilata con saldatura al TIG (2 pezzi)

**B:** Serbatoio a due calotte bordate con mantello centrale saldato al TIG longitudinale (3 pezzi)

*A: tank two caps, a fishing trip and a cropped with the TIG welding (2 pieces)*

*B: tank caps to two trips with cloak central to TIG welded longitudinal (3 pieces)*

**STL**

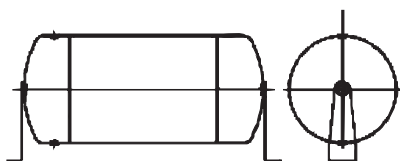

Staffa fornita a parte  
bracket provided separately

**STU**

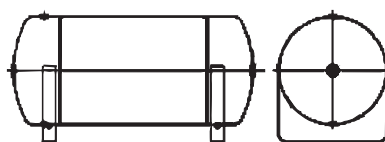

Staffa fornita già montata  
bracket provided already mounted

**STC**

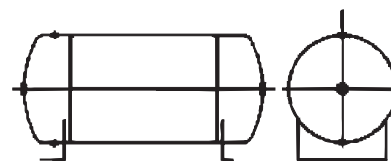

Staffa fornita già montata  
bracket provided already mounted

#### A richiesta si costruiscono serbatoi speciali:

- a disegno del cliente
- PN 20
- In AISI 316
- Con lucidatura a specchio
- Con decapaggio per settore farmaceutico / medicale.
- Sgrassato per utilizzo con ossigeno

#### Available on demand:

- on customer's drawing
- PN 20
- In AISI 316
- with polishing mirror
- with pickling for the medical / pharmaceutical sector
- de-greased for use with oxigene

Prodotti conformi alla direttiva 2002/95/EC **RoHS**

products in conformity with the directive 2002/95/EC **RoHS**

I dati tecnici e le quote non sono vincolanti • drawings and technical data are not binding

SERBATOI • tanks

serbatoio in Acciaio INOX AISI 304 • tank stainless steel AISI 304

SB304TR

CODE	Fig.	Ø	H	Vol Lt.	L	M	A	D	C	PN	Peso Weight(g)	
SB304TR088200	A	88	200	1	-	-	100	-	1/4"	10 Bar	500	1
SB304TR100190	A	100	190	1,4	-	-	95	-	1/4"	10 Bar	500	1
SB304TR130100	A	130	100	1	-	-	50	-	1/4"	10 Bar	1600	1
SB304TR130130	A	130	130	1,5	-	-	75	-	1/4"	10 Bar	1800	1
SB304TR130175	A	130	175	2	40	-	88	1/4"(1)	1/4"	10 Bar	2000	1
SB304TR150350	A	150	350	6	50	-	175	1/4"(2)	1/2"	10 Bar	2000	1
SB304TR160220	A	160	220	4,5	50	-	110	1/4"(2)	1/2"	10 Bar	1600	1
SB304TR190330	A	190	330	9	70	-	165	1/4"(2)	1/2"	10 Bar	2500	1
SB304TR190420	B	190	420	12	70	90	165	1/4"(2)	1/2"	10 Bar	3000	1
SB304TR220540	B	220	550	20	70	260	145	1/4"(2)	1/2"	10 Bar	3500	1
SB304TR245400	A	245	400	19	70	-	200	1/4"(2)	1/2"	10 Bar	4200	1
SB304TR245540	B	245	540	24	70	330	-	1/4"(2)	1/2"	8 Bar	6500	1
SB304TR330590	B	330	590	50	150	350	115	1/4"(2)	1/2"	8 Bar	11000	1

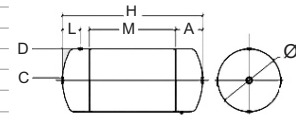

staffa a L per serbatoio in Acciaio INOX AISI 304 • L-bracket for stainless steel AISI 304 tank

STL

CODE	Compatibile con suitable for	Fig.	Ø	H	L	M	A	D	C	G	P	O	Peso Weight(g)
STL130	SB304TR130100	A	130							40	130	38	1
	SB304TR130130	A	130	2	123	103	29	60	15	40	160	38	108
	SB304TR130175	A	130							40	205	38	1
	SB304TR150350	A	150							40	380	55	1
STL190	SB304TR160220	A	160							40	250	50	1
	SB304TR190330	A	190	2	150	133	29	60	15	40	360	38	125
	SB304TR190420	B	190							40	450	38	1
STL245	SB304TR220540	B	220							40	580	46	1
	SB304TR245400	A	245	2	178	158	29	60	15	40	430	38	178
	SB304TR245540	B	245							40	570	38	1

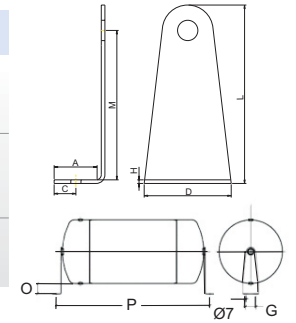

staffa e serbatoio forniti non assemblati • bracket and tank supplied not assembled

serbatoio in Acciaio INOX AISI 304 con staffa a U • tank stainless steel AISI 304 with U-brackets

SB304TR-STU

CODE	Fig.	Ø	H	Vol Lt.	L	M	A	D	C	G	P	O	PN	Peso Weight(g)
SB304TR160220-STU	A	160	220	4,5	50	-	110	1/4"	1/2"	100	110	38	10 Bar	1600
SB304TR190330-STU	A	190	330	9	70	-	165	1/4"	1/2"	120	200	38	10 Bar	2500
SB304TR190420-STU	B	190	420	12	70	90	165	1/4"	1/2"	120	200	38	10 Bar	3000
SB304TR220540-STU	B	220	550	20	70	260	145	1/4"	1/2"	150	380	38	10 Bar	3500
SB304TR245400-STU	A	245	400	19	70	-	200	1/4"	1/2"	-	300	38	10 Bar	4200
SB304TR245540-STU	B	245	540	24	70	330	-	1/4"	1/2"	150	380	38	8 Bar	6500

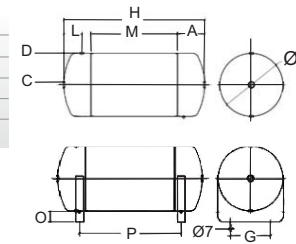

serbatoio in Acciaio INOX AISI 304 con staffa a culla • tank stainless steel AISI 304 with cradle bracket

SB304TR-STC

CODE	Fig.	Ø	H	Vol Lt.	L	M	A	D	C	G	P	O	PN	Peso Weight(g)
SB304TR190420-STC	B	190	420	12	70	90	165	1/4"	1/2"	120	200	38	10 Bar	3000
SB304TR220540-STC	B	220	540	20	70	260	145	1/4"	1/2"	120	300	38	10 Bar	3500
SB304TR245540-STC	B	245	540	24	70	330	-	1/4"	1/2"	150	420	38	8 Bar	6500
SB304TR330590-STC	B	330	590	50	150	350	115	1/4"	1/2"	230	440	38	8 Bar	11000

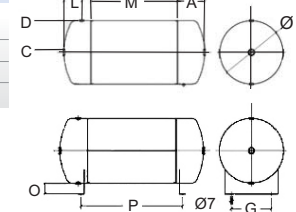

PRODOTTI CORRELATI • correlated products

- 1105TR14 nipplo cilindrico BSPP 1/4" - nipple BSPP thread 1/4"
- 1105TR12 nipplo cilindrico BSPP 1/2" - nipple BSPP thread 1/2"
- 1149TR14 tappo M cilindrico 1/4" BSPP con brugola e OR - M plug 1/4" BSPP thread with exagon embedded and OR
- 1149TR12 tappo M cilindrico 1/2" BSPP con brugola e OR - M plug 1/2" BSPP thread with exagon embedded and OR
- 1461TR14 tappo M brugola conico 1/4" BSPT piatto - M flat plug 1/4" BSPT thread exagon embedded
- 1461TR12 tappo M brugola conico 1/2" BSPT piatto - M flat plug 1/2" BSPT thread exagon embedded
- 1205TR14 curva F 1/4" cilindrica BSPP / M conica BSPT - F 1/4" BSPP thread / M BSPT thread elbow
- 1205TR12 curva F 1/2" cilindrica BSPP / M conica BSPT - F 1/2" BSPP thread / M BSPT thread elbow
- 1485TR14 curva F 1/4" cilindrica BSPP / M conica BSPT in AISI 316 - F 1/4" BSPP thread / M BSPT thread elbow in AISI 316
- 1485TR12 curva F 1/2" cilindrica BSPP / M conica BSPT in AISI 316 - F 1/2" BSPP thread / M BSPT thread elbow in AISI 316
- 9180TR14 valvola a sfera mini M/F 1/4" inox AISI 316 - mini ball valve M/F 1/4" inox AISI 316
- 9180TR12 valvola a sfera mini M/F 1/2" inox AISI 316 - mini ball valve M/F 1/2" inox AISI 316
- 9230TR14 valvola a sfera a passaggio totale inox AISI 316, attacchi filettati 1/4" BSPP F/F - full bore ball valve inox AISI 316, threaded ends 1/4" BSPP F/F
- 9230TR12 valvola a sfera a passaggio totale inox AISI 316, attacchi filettati 1/2" BSPP F/F - full bore ball valve inox AISI 316, threaded ends 1/2" BSPP F/F
- MXXR63G0239 manometro tutto inox a secco per la chimica, cassa INOX AISI 304, perno e molla in INOX AISI 316, attacco radiale, filetto cilindrico 1/4" BSPP stainless steel unfilled pressure gauge for the chemistry with INOX AISI 304 case, spring & hub in INOX AISI 316, bottom connection, BSPP 1/4" thread
- MXXP63G0239 manometro tutto inox a secco per la chimica, cassa INOX AISI 304, perno e molla in INOX AISI 316, attacco posteriore, filetto cilindrico 1/4" BSPP stainless steel unfilled pressure gauge for the chemistry with INOX AISI 304 case, spring & hub in INOX AISI 316, back connection, BSPP 1/4" thread