

SILENZIATORI DI SCARICO • *silencers*

LEGENDA CODICE • *Model designation*

6100TR

 ↓
Codice
code

18

 ↓
Filetto
thread size

Metrico <i>metric thread</i>	
M5	M5

Cilindrico BSPP <i>BSPP thread</i>	
18	G 1/8"
14	G 1/4"
38	G 3/8"
12	G 1/2"
34	G 3/4"
1	G 1"



DATI TECNICI

Fluidi compatibili	Aria compressa
Materiali utilizzati	Bronzo sinterizzato sferico con base in acciaio ramato per i codici 6100, 6150, 6550 e 6600 Bronzo sinterizzato sferico con base in ottone per i codici 6200, 6250, 6300, 6350, 6400, 6650 e 6670 Filo acciaio con base in ottone per i codici 6450 e 6500 Plastica per i codici 6700, 6750 Polietilene per il codice 6780 Filo acciaio su base in nylon per il codice 6820 Filo acciaio su base inox per il codice 6850 Rete e base in acciaio inox AISI 316L per il codice 6880
Filettature	Gas Cilindrica BSPP ISO 228 da G1/8" a G1" Metrica ISO R/262 M5
Pressione d'esercizio	sino a 10 Bar sino a 6 Bar per il codice 6780
Temperature d'esercizio	da -20°C a +80°C da -20°C a +300°C per il codice 6880

Technical specifications

fluid types	compressed air
construction materials	sinterized spheric bronze powder on the coppered steel base for codes 6100, 6150, 6550 and 6600. sinterized spheric bronze powder on the brass base for codes 6200, 6250, 6300, 6350, 6400, 6650 & 6670. stainless steel wire on the brass base for codes 6450 & 6500. plastic for codes 6700 & 6750 polyethylene for code 6780 stainless steel wire on nylon base for code 6820 stainless steel wire on stainless steel base for code 6850 stainless steel AISI 316L wire & body for code 6880
threads	parallel gas BSPP ISO 228 from G1/8" to G1" metric ISO R/262 M5
working pressure	up to 10 bar up to 6 bar for code 6780
temperature pressure	from -20°C to +80°C from -20°C to +300°C for code 6880

 Prodotti conformi alla direttiva 2002/95/EC 

 Prodotti conformi alla direttiva 1907/2006 

 products in compliance with the directive 2002/95/EC 

 products in compliance with the directive 1907/2006 

I dati tecnici e le quote non sono vincolanti – drawings and technical data are not binding

SILENZIATORI DI SCARICO • silencers

silenziatore bronzo sferico sinterizzato a cono su base esagonale in acciaio ramato
cone-shaped silencer of sinterized spherical bronze with hex. coppered steel base

6100



CODE	T	ØP	I	F	L	H(Hex)	Peso weight (g)	
6100TRM5	M5	5,5	3,5	4,0	17,0	7	2,0	100
6100TR18	G1/8"	10,5	4,5	3,8	21,0	12	6,0	100
6100TR14	G1/4"	12,5	6,0	4,5	27,0	15	12,5	100
6100TR38	G3/8"	17,0	7,0	5,4	35,0	19	23,0	50
6100TR12	G1/2"	20,5	8,0	6,0	40,5	23	39,0	50
6100TR34	G3/4"	26,5	9,0	7,5	51,5	30	78,5	25
6100TR1	G1"	33,0	11,0	9,0	66,0	36	149,5	20

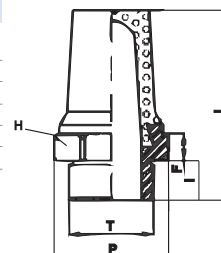

silenziatore bronzo sferico sinterizzato a cono esagono in testa su base circolare acciaio ramato
hexagonal head cone-shaped silencer of sinterized spherical bronze with circular coppered steel base

6150



CODE	T	ØP	I	L1	L2	H(Hex)	Peso weight (g)	
6150TR18	G1/8"	11,5	4,5	21,5	17,0	8	6,5	100
6150TR14	G1/4"	15,0	6,0	28,0	22,0	10	12,5	100
6150TR38	G3/8"	19,0	7,0	36,0	29,0	13	23,5	50
6150TR12	G1/2"	23,0	8,0	43,0	35,0	15	39,0	50
6150TR34	G3/4"	30,0	9,0	56,0	47,0	19	77,5	25
6150TR1	G1"	37,0	11,0	69,0	58,0	24	139,0	20

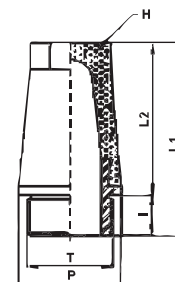

silenziatore bronzo sferico sinterizzato a cono ribattuto su base esagonale ottone
cone-shaped silencer of sinterized spherical bronze riveted on hexagonal brass base

6200



CODE	T	ØP	I	F	L	H(Hex)	Peso weight (g)	
6200TRM5	M5	7,5	4,0	4,0	17,0	8	2,5	100
6200TR18	G1/8"	12,5	6,0	3,8	29,0	13	9,5	100
6200TR14	G1/4"	14,5	7,0	4,5	32,0	16	16,5	100
6200TR38	G3/8"	19,0	8,0	5,4	40,0	19	26,5	50
6200TR12	G1/2"	22,5	9,0	6,0	45,0	24	46,5	50
6200TR34	G3/4"	28,5	10,0	7,5	56,0	30	81,5	25
6200TR1	G1"	35,0	12,0	9,0	66,0	36	134,0	20

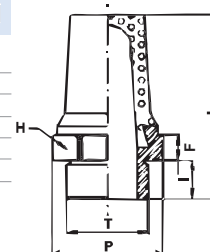

silenziatore bronzo sferico sinterizzato a cono c/esagono in testa ribattuto su base circolare ottone
hexagonal head cone-shaped silencer of sinterized spherical bronze riveted on circular brass base

6250



CODE	T	ØP	I	L1	L2	H(Hex)		
6250TR18	G1/8"	13,5	6,0	25,0	19,0	8	100	
6250TR14	G1/4"	17,0	7,0	30,0	23,0	10	100	
6250TR38	G3/8"	21,0	8,0	38,0	30,0	13	50	
6250TR12	G1/2"	25,0	10,0	43,0	33,0	15	50	
6250TR34	G3/4"	33,0	10,0	52,0	42,0	19	25	
6250TR1	G1"	40,0	12,0	65,0	53,0	24	20	

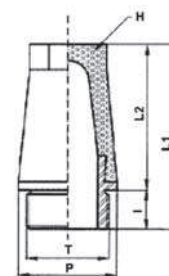

silenziatore bronzo sferico sinterizzato con pastiglia ribattuta su base esagonale ottone
silencer of sinterized spherical bronze riveted on hexagonal brass pastille base

6300



CODE	T	ØP	I	L	H(Hex)	Peso Weight (g)	
6300TRM5	M5	6,5	3,5	8,0	8	2,0	100
6300TR18	G1/8"	11,0	6,0	13,0	13	6,5	100
6300TR14	G1/4"	14,0	8,0	16,0	16	11,0	100
6300TR38	G3/8"	17,0	9,0	18,0	19	16,5	50
6300TR12	G1/2"	22,0	11,0	18,0	24	26,0	50
6300TR34	G3/4"	28,0	13,0	22,0	30	39,5	25
6300TR1	G1"	34,0	15,0	23,0	36	60,0	20

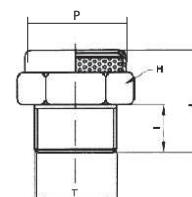

SILENZIATORI DI SCARICO • *silencers*

silenziatore bronzo sferico sinterizzato con pastiglia ribattuta su base circolare zigrinata ottone
silencer of sinterized spherical bronze riveted on circular knurled brass pastille base

6350



CODE	T	ØP	I	L1	L2	Peso Weight (g)	
6350TR18	G1/8"	11,0	6,0	12,0	6,0	7,0	100
6350TR14	G1/4"	14,0	7,0	13,0	6,0	7,0	100
6350TR38	G3/8"	17,0	8,0	17,0	9,0	10,0	50
6350TR12	G1/2"	22,0	10,0	18,0	8,0	10,0	50
6350TR34	G3/4"	28,0	10,0	20,0	10,0	12,0	25
6350TR1	G1"	34,0	12,0	21,0	9,0	12,0	20

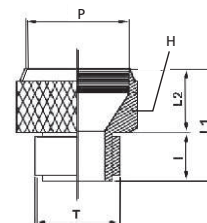

silenziatore bronzo sferico sinterizzato a cono ribattuto su base circolare zigrinata ottone
cone-shaped silencer of sinterized spherical bronze riveted on circular knurled brass base

6400



CODE	T	P	I	B	E	L	
6400TR18	G1/8"	13,0	4,5	8,5	3,0	25,0	100
6400TR14	G1/4"	16,0	6,0	11,0	3,0	30,0	100
6400TR38	G3/8"	20,0	7,0	14,0	4,0	38,0	50
6400TR12	G1/2"	23,0	8,0	17,0	4,0	42,0	50
6400TR34	G3/4"	29,0	9,0	21,0	5,0	52,0	25
6400TR1	G1"	36,0	11,0	26,5	5,0	65,0	20

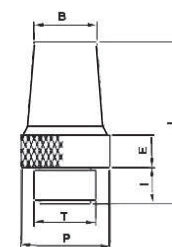

silenziatore con filo acciaio su esagono in ottone • *stainless steel wire silencers on hexagonal brass base*

6450



CODE	T	I	L	H(Hex)	Peso weight (g)	
6450TRM5	M5	4,0	8,0	8	1,5	100
6450TR18	G1/8"	6,0	15,0	13	6,0	100
6450TR14	G1/4"	7,0	18,0	16	10,5	100
6450TR38	G3/8"	8,0	20,0	19	16,5	50
6450TR12	G1/2"	10,0	22,0	24	24,5	50
6450TR34	G3/4"	10,0	26,0	30	37,0	25
6450TR1	G1"	12,0	28,0	36	56,5	20

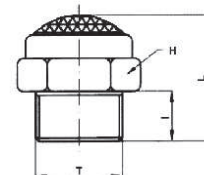

silenziatore con filo acciaio su base circolare zigrinata in ottone
silencer of stainless steel wire riveted on circular knurled brass base

6500



CODE	T	ØP	I	L	
6500TR18	G1/8"	12,0	6,0	13,0	100
6500TR14	G1/4"	16,0	7,0	14,0	100
6500TR38	G3/8"	19,0	8,0	18,0	50
6500TR12	G1/2"	23,0	10,0	19,0	50
6500TR34	G3/4"	29,0	10,0	22,0	25
6500TR1	G1"	36,0	12,0	23,0	20

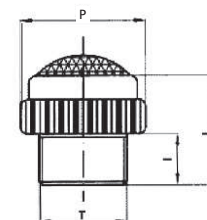

silenziatore bronzo sferico sinterizzato a cono su base circolare acciaio ramato
cone e-shaped silencer of sinterized spherical bronze with circular coppered steel base

6550



CODE	T	ØP	I	L1	L2	Peso weight (g)	
6550TR18	G1/8"	11,5	4,5	21,0	16,5	6,0	100
6550TR14	G1/4"	15,0	6,0	25,0	19,0	11,5	100
6550TR38	G3/8"	19,0	7,0	34,5	27,5	24,0	50
6550TR12	G1/2"	23,0	8,0	43,0	35,0	44,5	50
6550TR34	G3/4"	30,0	9,0	50,0	41,0	73,0	25
6550TR1	G1"	37,0	11,0	60,5	49,5	137,5	20

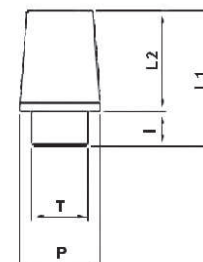

SILENZIATORI DI SCARICO • *silencers*

silenziatore bronzo sferico sinterizzato a cono con taglio a cacciavite su base circolare acciaio ramato
cone e-shaped silencer of sinterized spherical bronze with circular brass coppered and screwdriver

6600



CODE	T	ØP	I	L	
6600TR18	G1/8"	11,5	4,5	21,0	100
6600TR14	G1/4"	15,0	6,0	25,0	100
6600TR38	G3/8"	19,0	7,0	34,5	50
6600TR12	G1/2"	23,0	8,0	43,0	50
6600TR34	G3/4"	30,0	9,0	50,0	25
6600TR1	G1"	37,0	11,0	60,5	20

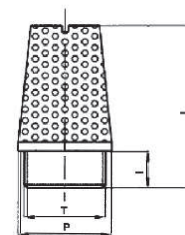

silenziatore con pastiglia di bronzo sinterizzato a regolazione di flusso
silencer of sinterized bronze pastille with flow control

6650



CODE	T	L min	L max	I	H (Hex)	Peso weight (g)	
6650TR18	G1/8"	26,0	28,0	6,0	13	16,0	100
6650TR14	G1/4"	30,0	32,0	8,0	15	23,0	100
6650TR38	G3/8"	35,0	38,0	10,0	22	48,0	50
6650TR12	G1/2"	37,0	40,0	11,0	22	59,0	50

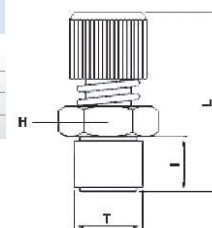

silenziatore sferico sinterizzato a pastiglia con taglio a cacciavite
cone-shaped silencer of sinterized spherical pastille with screwdriver

6670



CODE	T	ØP	L	Peso weight (g)	
6670TR18	G1/8"	6,0	5,0	1,37	100
6670TR14	G1/4"	8,0	6,0	2,91	100
6670TR38	G3/8"	10,0	7,0	6,33	50
6670TR12	G1/2"	15,0	8,0	11,69	50
6670TR34	G3/4"	20,0	9,0	14,56	25
6670TR1	G1"	26,0	10,0	28,26	20

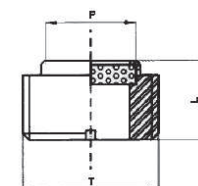

silenziatore plastico dinamico con sfere • *plastic dynamic silencer with balls*

6700



CODE	T	ØP	I	L1	L2	Peso weight (g)	
6700TR18	G1/8"	15,0	6	32,5	26,5	4,0	100
6700TR14	G1/4"	19,5	8	43,0	35,0	8,0	100
6700TR38	G3/8"	24,5	11	58,0	47,0	18,0	50
6700TR12	G1/2"	24,5	11	58,0	47,0	19,0	30
6700TR34	G3/4"	48,0	18	115,0	97,0	115,0	20
6700TR1	G1"	48,0	18	115,0	97,0	115,0	10

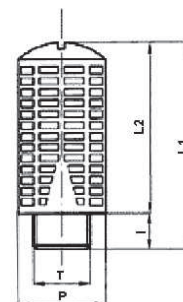

silenziatore plastico statico con feltro • *static plastic silencer with felt*

6750



CODE	T	ØP	I	L1	L2	H (Hex)	Peso weight (g)	
6750TR18	G1/8"	16,0	6,0	34,0	28,0	12	4,0	100
6750TR14	G1/4"	19,0	8,0	44,0	36,0	12	7,0	100
6750TR38	G3/8"	24,0	10,0	56,0	46,0	17	14,0	50
6750TR12	G1/2"	24,0	10,0	56,0	46,0	17	15,0	30

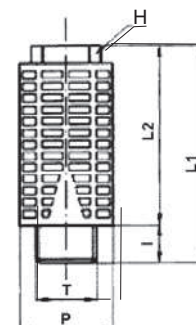

SILENZIATORI DI SCARICO • *silencers*

silenziatore a supposta in polietilene • *noise silencer in polyethylene*

6780



CODE	T	ØP	I	L1	L2	Peso weight (g)	
6780TRM5	M5	7,0	4,0	24,5	20,5	2,8	100
6780TR18	G1/8"	13,0	7,5	32,5	25,0	3,7	100
6780TR14	G1/4"	17,0	8,0	39,0	31,0	10,0	100
6780TR38	G3/8"	25,0	11,0	65,0	54,0	13,5	50
6780TR12	G1/2"	25,0	11,0	69,0	58,0	37,0	50
6780TR34	G3/4"	37,0	15,5	138,0	122,5	47,0	25
6780TR1	G1"	47,0	19,5	157,0	137,5	90,0	20

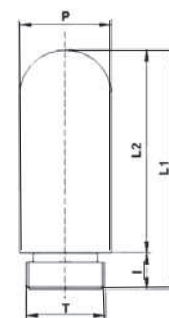

215

RACCORDI STANDARD • standard fittings

6820



silenziatore filo inox su base in nylon • *inox wire silencer on nylon base*

CODE	T	I	L	H (Hex)	Peso weight (g)	
6820TR18	G1/8"	6,0	15,0	13	1,5	100
6820TR14	G1/4"	7,0	18,0	16	2,8	100
6820TR38	G3/8"	8,0	20,0	19	4,5	100
6820TR12	G1/2"	10,0	22,0	24	7,5	100

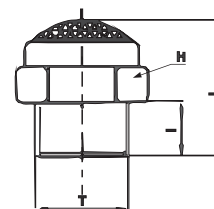

6850



silenziatore filo inox • *inox wire silencer*

CODE	T	I	L	H (Hex)	Peso weight (g)	
6850TR18	G1/8"	6,0	15,0	13	5,0	10
6850TR14	G1/4"	7,0	18,0	16	10,0	10
6850TR38	G3/8"	8,0	20,0	19	15,0	10
6850TR12	G1/2"	10,0	22,0	24	25,0	5
6850TR34	G3/4"	10,0	26,0	30	40,0	5
6850TR1	G1"	12,0	28,0	36	95,0	5

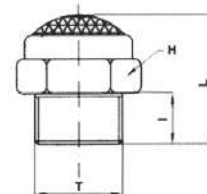

6880



silenziatore rete inox AISI 316L su base inox AISI 316L • *inox AISI 316L wire silencer on inox aisi 316L base*

CODE	T	ØD	B	F	L	H (Hex)	Peso weight (g)	
6880TR18	G1/8"	6,0	9,0	8,0	15,0	14	8,0	10
6880TR14	G1/4"	8,0	13,0	8,0	15,0	17	12,0	10
6880TR38	G3/8"	12,0	18,0	10,0	18,0	22	20,0	10
6880TR12	G1/2"	15,0	22,5	12,0	22,0	27	38,0	5
6880TR34	G3/4"	20,0	28,0	15,0	27,0	32	62,0	5
6880TR1	G1"	26,0	34,0	18,0	32,0	41	118,0	5

AISI 316L

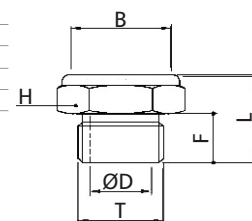

NEW

6882



silenziatore rete inox AISI 316L su base inox AISI 316L filetto NPT • *inox AISI 316L wire silencer on inox aisi 316L base NPT thread*

CODE	T	ØD	B	F	L	H (Hex)	Peso weight (g)	
6882TR18	N1/8"	6,0	9,0	8,0	15,0	14	8,0	10
6882TR14	N1/4"	8,0	13,0	8,0	15,0	17	12,0	10
6882TR38	N3/8"	12,0	18,0	10,0	18,0	22	20,0	10
6882TR12	N1/2"	15,0	22,5	12,0	22,0	27	38,0	5
6882TR34	N3/4"	20,0	28,0	15,0	27,0	32	62,0	5
6882TR1	N1"	26,0	34,0	18,0	32,0	41	118,0	5

AISI 316L

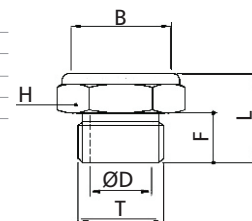

NEW

