

MICROVALVOLE A SFERA IN OTTONE

brass micro ball valves

MICROVALVOLE A SFERA - *micro ball valves*

Microvalvola a sfera con comando manual ON/OFF con leva. Si chiude e si apre girando la leva da 1/4 di giro fino a fine corsa
Micro valve with manual command ON/OFF with lever. Open and close by turning the lever of 1/4 turn, till the end of the stroke.

DATI TECNICI

Applicazioni	Aria Compressa, Aria Compressa Lubrificata, Gas Vari, Liquidi in genere
Materiali utilizzati	Corpo: Ottone CW 617N Ghiera: Ottone CW 614N Asta: Ottone CW 614N Sfera: Ottone CW 614N nichelato Guarnizione della sfera: PTFE (Teflon) Vite: Acciaio Anello di tenuta asta: O'Ring in NBR 70. A richiesta VITON Leva: Nylon 6.6 Tappo: Nylon 6.6
Finitura esterna	Nichelatura
Direzione flusso	Bidirezionale
Filettature	Gas Conica R ISO 7 Gas Cilindrica UNI ISO 228/1
Pressione d'esercizio max	10 Bar
Temperatura d'esercizio	-5°C +70°C

Prodotti conformi alla direttiva 2002/95/EC **RoHS**

Technical specifications

<i>applications</i>	<i>compressed air, lubricated compressed air, various gasses and liquids</i>
<i>materials used</i>	<i>body: brass CW 617N retainer: brass CW 614N stem: brass CW 614N ball: brass CW 614N nickel plated ball gasket: PTFE (TEFLON) screw: steel stem sealing ring: o'ring in NBR 70. On demand VITON lever: nylon 6.6 button: nylon 6.6</i>
<i>surface finishing</i>	<i>nickel plated</i>
<i>direction of the flow</i>	<i>bidirectional</i>
<i>threads</i>	<i>taper gas R ISO 7 cylindrical gas UNI ISO 228/1</i>
<i>max working pressure</i>	<i>10 BAR</i>
<i>working temperature</i>	<i>-5°C +70°C</i>

*products in conformity with the directive 2002/95/EC **RoHS***

MICROVALVOLE A SFERA IN OTTONE • brass micro ball valves

microvalvola a sfera F/F leva nera • micro ball valve F/F black lever

9142



CODE	T1	T2	D	E	C	L1	L2	L3	Peso weight(g)	
9142TR18	G1/8"	G1/8"	6	24	23	34	8,0	8,0	35,0	30
9142TR14	G1/4"	G1/4"	6	24	23	38	9,5	9,5	39,0	30
9142TR38	G3/8"	G3/8"	8	24	24	43	10,5	10,5	55,0	30
9142TR12	G1/2"	G1/2"	10	34	27	49	12,0	12,0	93,0	30

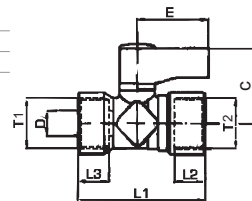

NEW

microvalvola a sfera M/M leva nera • micro ball valve M/M black lever

9152



CODE	T1	T2	D	E	C	L1	L2	L3	Peso weight(g)	
9152TR18	R1/8"	R1/8"	6	24	23	34	7,0	7,5	32,0	30
9152TR14	R1/4"	R1/4"	6	24	23	38	8,0	11,0	36,0	30
9152TR38	R3/8"	R3/8"	8	24	24	40	9,0	11,5	51,0	30
9152TR12	R1/2"	R1/2"	10	34	27	46	10,0	15,0	87,0	30

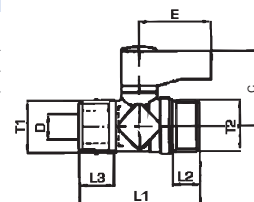

NEW

microvalvola a sfera M/F leva nera • micro ball valve M/F black lever

9162



CODE	T1	T2	D	E	C	L1	L2	L3	Peso weight(g)	
9162TR18	R1/8"	G1/8"	6	24	23	34	8,0	7,5	0,32	30
9162TR14	R1/4"	G1/4"	6	24	23	39	9,5	11,0	0,36	30
9162TR38	R3/8"	G3/8"	8	24	24	43	10,5	11,5	0,51	30
9162TR12	R1/2"	G1/2"	10	24	27	50	12,0	15,0	0,87	30

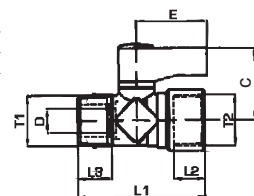

NEW

microvalvola a sfera M con attacco ogiva per tubo rame o alluminio leva nera
micro ball valve M with ogive connection for copper or aluminium tube black lever

9168



CODE	T	D	R	E	C	L1	L2	Peso weight(g)	
9168TR186	R1/8"	6	6	24	23	41	7,5	38,0	30
9168TR148	R1/4"	8	6	24	23	46	11,0	46,0	30

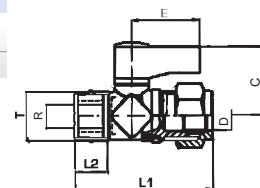

NEW