

## GIUNTI AUTOMATICI • *quick couplings*

**PAG 227** GIUNTI AUTOMATICI PER ARIA COMPRESSA  
*quick couplings for compressed air*

**PAG 241** GIUNTI AUTOMATICI PER FLUIDI  
*quick couplings for fluids*

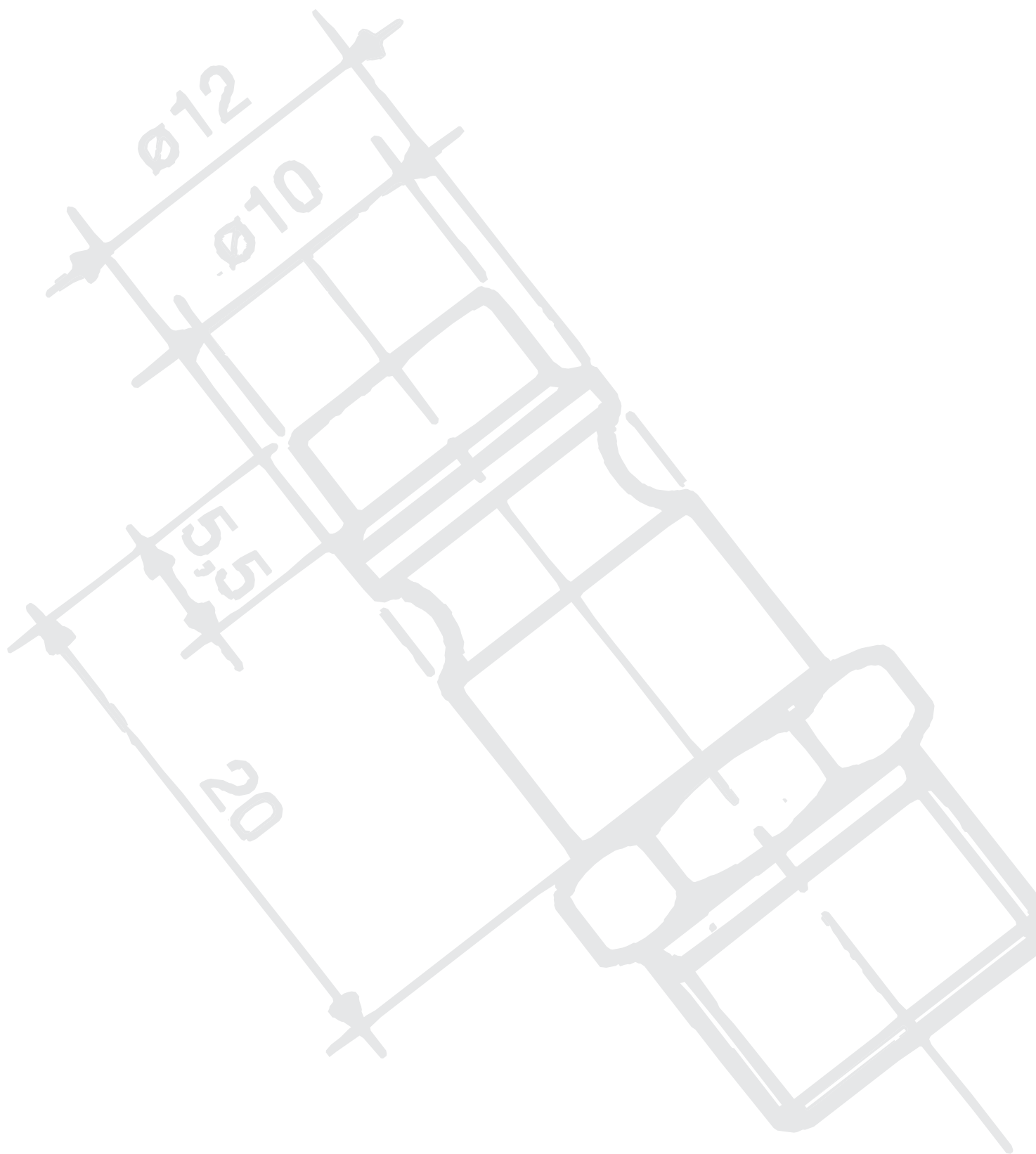



## GIUNTI AUTOMATICI PER ARIA COMPRESSA *quick couplings for compressed air*

---

PAG 228 SERIE MINI • *Mini series*

PAG 230 SERIE ITALIA • *Italy series*

PAG 232 SERIE ITALIA GIGANTE • *Large Italy series*

PAG 234 SERIE GERMANIA • *Germany series*

PAG 236 SERIE UNIVERSALE • *Universal series*

PAG 238 SERIE AMERICA • *America series*

PAG 239 SERIE SVIZZERA • *Swiss series*

PAG 240 SERIE GIAPPONE • *Japan series*

# GIUNTI AUTOMATICI PER ARIA COMPRESSA SERIE MINI

## quick couplings MINI series for compressed air

### DATI TECNICI

Applicazioni	Pneumatica & Aria Compressa
Filettature	Gas conica Gas cilindrica
Pressione d'esercizio	da 0 a 8 Bar

### Technical specifications

applications	pneumatics & compressed air
threads	taper gas cylindrical gas
working pressure	from 0 to 8 Bar

Prodotti conformi alla direttiva 2002/95/EC **RoHS**

products in conformity with the directive 2002/95/EC **RoHS**

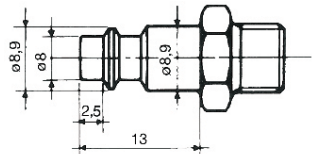

diametro foro interno 4.8 mm

I.D. hole 4.8 mm

I dati tecnici e le quote non sono vincolanti • drawings and technical data are not binding

228

GIUNTI AUTOMATICI • quick couplings

giunto maschio • male quick coupler

### 8110FM



CODE	T	L	H(Hex)	
8110FM01	R1/8"	38,9	14	10
8110FM02	R1/4"	37,7	14	10

giunto femmina • female quick coupler

### 8120FF



CODE	T	L	H(Hex)	
8120FF01	G1/8"	38,9	14	10
8120FF02	G1/4"	40,7	15	10

giunto a calzamento • push-on quick coupler

### 8140CA



CODE	Ø	L	H(Hex)	
8140CA46	4x6	42,9	14	10
8140CA68	6x8	43,6	14	10
8140CA810	8x10	45,0	14	10

giunto con molla • quick coupler with spring

### 8150MO



CODE	Ø	L	H1(Hex)	H2(Hex)	
8150MO46	4x6	115,6	14	12	10
8150MO68	6x8	128,3	14	13	10
8150MO810	8x10	129,2	14	15	10

giunto femmina passaparete • bulkhead female quick coupler

**8155BU**

CODE	Ø	L	H(Hex)	
8155BU46	4x6	57,7	14	10

**NEW**

innesto maschio • male connection

**8160MM**

CODE	T	L	H(Hex)	
8160MM01	R1/8"	26,0	12	10
8160MM02	R1/4"	28,4	14	10

innesto femmina • female connection

**8170FM**

CODE	T	L	H(Hex)	
8170FM01	G1/8"	24,6	12	10
8170FM02	G1/4"	27,9	15	10

innesto a resca • connection with barb connector

**8180RE**

CODE	Ø	L	
8180RE06	6	33,0	10
8180RE08	8	34,5	10

**NEW**

innesto a calzamento • push-on connection

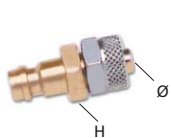
**8190CA**

CODE	Ø	L	H(Hex)	
8190CA46	4x6	32,5	12	10
8190CA68	6x8	33,1	12	10
8190CA810	8x10	34,7	14	10

innesto con molla • connection with spring

**8195MO**

CODE	Ø	L	H1(Hex)	H2(Hex)	
8195MO46	4x6	104,3	12	12	10
8195MO68	6x8	117,0	12	12	10
8195MO810	8x10	120,4	14	15	10

# GIUNTI AUTOMATICI PER ARIA COMPRESSA SERIE ITALIA

## quick couplings ITALY series for compressed air



### DATI TECNICI

Applicazioni	Pneumatica & Aria Compressa
Filettature	Gas conica
	Gas cilindrica
Pressione d'esercizio	da 0 a 8 Bar

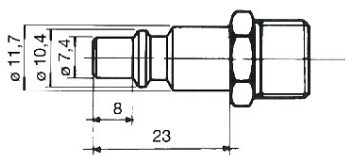
 Prodotti conformi alla direttiva 2002/95/EC **RoHS**

diametro foro interno 4.8 mm

*I.D. hole 4.8 mm*

I dati tecnici e le quote non sono vincolanti • drawings and technical data are not binding

### Technical specifications

<i>applications</i>	<i>pneumatics &amp; compressed air</i>
<i>threads</i>	<i>taper gas</i>
	<i>cylindrical gas</i>
<i>working pressure</i>	<i>from 0 to 8 Bar</i>

 products in conformity with the directive 2002/95/EC **RoHS**

230

GIUNTI AUTOMATICI • quick couplings

giunto maschio • male quick coupler

### 8210FM



CODE	T	L	H(Hex)	
8210FM01	R1/8"	51,9	19	10
8210FM02	R1/4"	52,1	19	10
8210FM03	R3/8"	52,2	19	10
8210FM04	R1/2"	55,5	22	10

giunto femmina • female quick coupler

### 8220FF



CODE	T	L	H(Hex)	
8220FF02	G1/4"	52,2	19	10
8220FF03	G3/8"	58,0	19	10
8220FF04	G1/2"	58,1	25	10

giunto portagomma • hose connector quick coupler

### 8240PO



CODE	Ø	L	H1(Hex)	H2(Hex)	
8240PO610	6x10	70,5	19	15	10
8240PO612	6x12	72,0	19	15	10
8240PO613	6x13	70,5	19	16	10
8240PO614	6x14	70,5	19	17	10
8240PO716	7x16	73,2	19	19	10
8240PO812 <b>new</b>	8x12	70,5	19	15	10
8240PO813 <b>new</b>	8x13	70,5	19	15	10
8240PO815 <b>new</b>	8x15	70,5	19	15	10
8240PO817	8x17	71,1	19	20	10
8240PO1017	10x17	76,2	19	18	10
8240PO1019	10x19	77,8	19	20	10

giunto con molla • quick coupler with spring

**8250MO**

CODE	Ø	L	H1 (Hex)	H2 (Hex)	
8250MO46	4x6	131,1	19	12	10
8250MO58 <b>new</b>	5x8	140,5	19	13	10
8250MO68	6x8	138,7	19	12	10
8250MO6510 <b>new</b>	6,5x10	140,0	19	15	10
8250MO810	8x10	144,3	19	15	10
8250MO1012	10x12	148,7	19	17	10

innesto maschio • male connection

**8260MM**

CODE	T	L	H (Hex)	
8260MM01	R1/8"	34,7	13	10
8260MM02	R1/4"	37,9	14	10
8260MM03	R3/8"	38,2	17	10
8260MM04	R1/2"	42,1	22	10

innesto femmina • female connection

**8270FM**



CODE	T	L	H (Hex)	
8270FM01	G1/8"	29,0	13	10
8270FM02	G1/4"	37,0	15	10
8270FM03	G3/8"	38,1	19	10
8270FM04 <b>new</b>	G1/2"	42,0	25	10

innesto portagomma • connection with hose connector

**8230PO**

CODE	Ø	L	H1 (Hex)	H2 (Hex)	
8230PO610	6x10	55,5	13	15	10
8230PO612	6x12	55,5	13	15	10
8230PO613	6x13	54,8	13	16	10
8230PO614	6x14	55,7	12	17	10
8230PO716	7x16	55,1	13	19	10
8230PO812 <b>new</b>	8x12	55,0	13	15	10
8230PO813 <b>new</b>	8x13	55,0	13	16	10
8230PO815 <b>new</b>	8x15	55,0	13	18	10
8230PO817	8x17	55,4	13	20	10
8230PO1017	10x17	57,9	13	20	10
8230PO1019	10x19	59,8	13	22	10

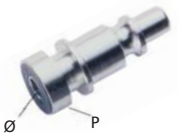
innesto maschio a baionetta • bayonet male connection

**8285BM**

CODE	Ø	L	P	
8285BM55	5,5	155,8	15	10

**NEW**

innesto con molla • connection with spring

**8295MO**

CODE	Ø	L	H1 (Hex)	H2 (Hex)	
8295MO46	4x6	112,1	12	12	10
8295MO58 <b>new</b>	5x8	125,5	13	13	10
8295MO68	6x8	124,9	13	13	10
8295MO6510 <b>new</b>	6,5x10	126,0	13	15	10
8295MO810	8x10	123,7	13	15	10
8295MO812 <b>new</b>	8x12	125,5	15	17	10
8295MO1012	10x12	127,5	15	17	10

# GIUNTI AUTOMATICI PER ARIA COMPRESSA SERIE ITALIA GIGANTE

## quick couplings LARGE ITALY series for compressed air



### DATI TECNICI

Applicazioni	Pneumatica & Aria Compressa
Filettature	Gas conica
	Gas cilindrica
Pressione d'esercizio	da 0 a 8 Bar

Prodotti conformi alla direttiva 2002/95/EC **RoHS**

### Technical specifications

<i>applications</i>	<i>pneumatics &amp; compressed air</i>
<i>threads</i>	<i>taper gas</i>
	<i>cylindrical gas</i>
<i>working pressure</i>	<i>from 0 to 8 Bar</i>

products in conformity with the directive 2002/95/EC **RoHS**

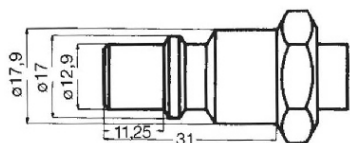

diametro foro interno 9,2 mm  
I.D. hole 9,2 mm

I dati tecnici e le quote non sono vincolanti • drawings and technical data are not binding

giunto maschio gigante • large male quick coupler

### 8215FM



CODE	T	L	H(Hex)	
8215FM03	R3/8"	62,5	26	10
8215FM04	R1/2"	65,0	26	10

**NEW**

giunto femmina gigante • large female quick coupler

### 8225FF



CODE	T	L	H(Hex)	
8225FF03	G3/8"	62,0	26	10
8225FF04	G1/2"	65,0	26	10

**NEW**

giunto portagomma gigante • large quick coupler with hose connector

### 8235PO



CODE	Ø	L	H1(Hex)	H2(Hex)	
8235PO1019	10x19	80,0	22	25	10
8235PO1021	10x21	80,0	22	25	10
8235PO1023	10x23	81,0	22	27	10
8235PO1319	13x19	82,0	22	25	10
8235PO1320	13x20	82,0	22	25	10
8235PO1321	13x21	82,0	22	25	10
8235PO1323	13x23	82,0	22	27	10
8235PO1325	13x25	82,0	22	30	10

**NEW**



innesto portagomma gigante • large connection with hose connector

## 8245PO



CODE	Ø	L	H1 (Hex)	H2 (Hex)	
8245PO1019	10x19	95,0	26	25	10
8245PO1021	10x21	96,0	26	25	10
8245PO1023	10x23	96,0	26	27	10
8245PO1319	13x19	97,5	26	25	10
8245PO1320	13x20	97,5	26	25	10
8245PO1321	13x21	97,5	26	25	10
8245PO1323	13x23	97,5	26	27	10
8245PO1325	13x25	97,5	26	30	10

**NEW**

innesto maschio gigante • large male connection

## 8255MM



CODE	T	L	H1 (Hex)	
8255MM03	R3/8"	47,5	19	10
8255MM04	R1/2"	50,5	22	10

**NEW**

# GIUNTI AUTOMATICI PER ARIA COMPRESSA SERIE GERMANIA

## quick couplings GERMANY series for compressed air



### DATI TECNICI

Applicazioni	Pneumatica & Aria Compressa
Filettature	Gas conica
	Gas cilindrica
Pressione d'esercizio	da 0 a 8 Bar

Prodotti conformi alla direttiva 2002/95/EC **RoHS**

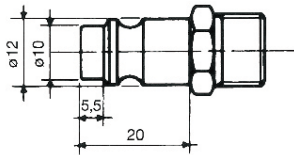

diametro foro interno 7,0 mm

I.D. hole 7,0 mm

I dati tecnici e le quote non sono vincolanti • drawings and technical data are not binding

### Technical specifications

applications	pneumatics & compressed air
threads	taper gas
	cylindrical gas
working pressure	from 0 to 8 Bar

products in conformity with the directive 2002/95/EC **RoHS**

giunto maschio • male quick coupler

### 8310FM



CODE	T	L	H(Hex)	
8310FM02	R1/4"	51,5	19	10
8310FM03	R3/8"	51,5	19	10
8310FM04	R1/2"	54,5	22	10

giunto femmina • female quick coupler

### 8320FF



CODE	T	L	H(Hex)	
8320FF02	G1/4"	51,4	19	10
8320FF03	G3/8"	57,0	19	10
8320FF04	G1/2"	54,3	25	10

giunto a resca • barb connector quick coupler

### 8330RE

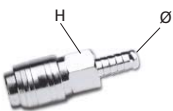

CODE	Ø	L	H(Hex)	
8330RE06	6	38,5	19	10
8330RE07	7	61,5	19	10
8330RE08	8	63,1	19	10
8330RE09	9	63,3	19	10
8330RE10	10	65,7	19	10
8330RE12	12	66,7	19	10
8330RE13	13	66,3	19	10

giunto portagomma • hose connector quick coupler

### 8390PO



CODE	Ø	L	H1(Hex)	H2(Hex)	
8390PO610 <b>new</b>	6x10	72,5	19	15	10
8390PO612	6x12	72,5	19	15	10
8390PO614	6x14	73,2	19	20	10
8390PO812 <b>new</b>	8x12	70,0	19	15	10
8390PO817	8x17	70,3	19	20	10
8390PO1019	10x19	76,4	19	20	10

giunto con molla • quick coupler with spring

## 8350MO



CODE	Ø	L	H1 (Hex)	H2 (Hex)	
8350MO46	4x6	129,0	19	12	10
8350MO58 <b>new</b>	5x8	139,0	19	13	10
8350MO68	6x8	137,9	19	13	10
8350MO6510 <b>new</b>	6,5x10	140,0	19	15	10
8350MO810	8x10	139,5	19	15	10
8350MO1012	10x12	144,7	19	17	10

**NEW**

innesto maschio • male connection

## 8360MM



CODE	T	L	H (Hex)	
8360MM02	R1/4"	33,5	14	10
8360MM03	R3/8"	35,5	17	10
8360MM04	R1/2"	38,4	22	10

innesto femmina • female connection

## 8370FM



CODE	T	L	H (Hex)	
8370FM02	G1/4"	33,1	15	10
8370FM03	G3/8"	35,0	19	10
8370FM04	G1/2"	38,0	25	10

innesto portagomma • connection with hose connector

## 8340PO



CODE	Ø	L	H1 (Hex)	H2 (Hex)	
8340PO610 <b>new</b>	6x10	51,4	13	15	10
8340PO612	6x12	51,4	13	15	10
8340PO614	6x14	51,4	13	17	10
8340PO817	8x17	52,5	13	18	10
8340PO1019	10x19	55,4	12	22	10

innesto a resca • connection with barb connector

## 8380RE

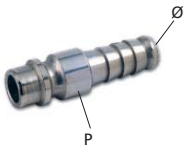

CODE	Ø	P	
8380RE06	6	38,2	10
8380RE07	7	40,0	10
8380RE08	8	40,2	10
8380RE09	9	40,9	10
8380RE10	10	39,4	10
8380RE12	12	44,6	10
8380RE13	13	45,6	10

innesto con molla • connection with spring

## 8395MO



CODE	Ø	L	H1 (Hex)	H2 (Hex)	
8395MO46	4x6	103,2	13	12	10
8395MO58 <b>new</b>	5x8	119,5	13	13	10
8395MO68	6x8	124,3	13	13	10
8395MO6510 <b>new</b>	6,5x10	120,5	13	15	10
8395MO810	8x10	123,2	13	15	10
8395MO1012	10x12	123,2	15	17	10

## GIUNTI AUTOMATICI PER ARIA COMPRESSA SERIE UNIVERSALE

### quick couplings UNIVERSAL series for compressed air



#### DATI TECNICI

Applicazioni	Pneumatica & Aria Compressa
Filettature	Gas conica
	Gas cilindrica
Pressione d'esercizio	da 0 a 8 Bar

Prodotti conformi alla direttiva 2002/95/EC **RoHS**

#### Technical specifications

<i>applications</i>	<i>pneumatics &amp; compressed air</i>
<i>threads</i>	<i>taper gas</i>
	<i>cylindrical gas</i>
<i>working pressure</i>	<i>from 0 to 8 Bar</i>

*products in conformity with the directive 2002/95/EC* **RoHS**

I dati tecnici e le quote non sono vincolanti • drawings and technical data are not binding

236

GIUNTI AUTOMATICI • quick couplings

### 8410FM



giunto maschio • male quick coupler

CODE	T	L	H(Hex)	
8410FM01	R1/8"	53,2	19	10
8410FM02	R1/4"	52,0	19	10
8410FM03	R3/8"	52,2	19	10
8410FM04	R1/2"	55,4	22	10

### 8420FF



giunto femmina • female quick coupler

CODE	T	L	H(Hex)	
8420FF01	G1/8"	52,0	19	10
8420FF02	G1/4"	52,0	19	10
8420FF03	G3/8"	55,1	19	10
8420FF04	G1/2"	54,8	25	10

### 8430RE





giunto a resca • barb connector quick coupler

CODE	Ø	L	H(Hex)	
8430RE06	6	62,3	19	10
8430RE07	7	62,5	19	10
8430RE08	8	66,6	19	10
8430RE09 <i>new</i>	9	64,2	19	10
8430RE10	10	64,0	19	10
8430RE12	12	67,5	19	10
8430RE13 <i>new</i>	13	68,5	19	10
8430RE14	14	70,4	19	10

giunto portagomma • hose connector quick coupler

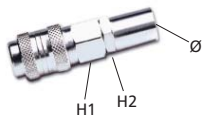
## 8440PO



CODE	Ø	L	H1 (Hex)	H2 (Hex)	
8440PO610 <i>new</i>	6x10	70,5	19	15	10
8440PO612	6x12	70,5	19	15	10
8440PO613 <i>new</i>	6x13	70,8	19	16	10
8440PO614	6x14	70,5	19	17	10
8440PO716	7x16	72,8	19	19	10
8440PO812 <i>new</i>	8x12	71,0	19	15	10
8440PO813 <i>new</i>	8x13	70,5	19	16	10
8440PO815	8x15	74,1	19	16	10
8440PO817	8x17	70,8	19	20	10
8440PO1015 <i>new</i>	10x15	75,8	19	18	10
8440PO1017	10x17	76,0	19	18	10
8440PO1019	10x19	78,0	19	22	10

giunto con molla • quick coupler with spring

## 8450MO



CODE	Ø	L	H1 (Hex)	H2 (Hex)	
8450MO46	4x6	126,4	19	12	10
8450MO58 <i>new</i>	5x8	140,0	19	13	10
8450MO68	6x8	141,2	19	13	10
8450MO6510 <i>new</i>	6,5x10	139,0	19	15	10
8450MO810	8x10	140,7	19	15	10
8450MO1012	10x12	145,5	19	17	10

# GIUNTI AUTOMATICI PER ARIA COMPRESSA SERIE AMERICA

## quick couplings AMERICA series for compressed air



### DATI TECNICI

Applicazioni	Pneumatica & Aria Compressa
Filettature	Gas conica
	Gas cilindrica
Pressione d'esercizio	da 0 a 8 Bar

Prodotti conformi alla direttiva 2002/95/EC **RoHS**

### Technical specifications

<i>applications</i>	<i>pneumatics &amp; compressed air</i>
<i>threads</i>	<i>taper gas</i>
	<i>cylindrical gas</i>
<i>working pressure</i>	<i>from 0 to 8 Bar</i>

products in conformity with the directive 2002/95/EC **RoHS**

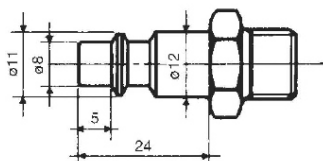

diametro foro interno 5,0 mm

I.D. hole 5,0 mm

I dati tecnici e le quote non sono vincolanti • drawings and technical data are not binding

GIUNTI AUTOMATICI • quick couplings

238

## 8060MM



innesto maschio • male connection

CODE	T	L	H(Hex)	
8060MM02	R1/4"	37,0	14	10
8060MM03	R3/8"	38,0	17	10
8060MM04	R1/2"	42,0	22	10

**NEW**

## 8070FM



innesto femmina • female connection

CODE	T	L	H(Hex)	
8070FM02	G1/4"	37,5	15	10
8070FM03	G3/8"	39,0	19	10
8070FM04	G1/2"	42,0	25	10

**NEW**

## GIUNTI AUTOMATICI PER ARIA COMPRESSA SERIE SVIZZERA quick couplings SWISS series for compressed air



### DATI TECNICI

Applicazioni	Pneumatica & Aria Compressa
Filettature	Gas conica
	Gas cilindrica
Pressione d'esercizio	da 0 a 8 Bar

Prodotti conformi alla direttiva 2002/95/EC **RoHS**

### Technical specifications

<i>applications</i>	<i>pneumatics &amp; compressed air</i>
<i>threads</i>	<i>taper gas</i>
	<i>cylindrical gas</i>
<i>working pressure</i>	<i>from 0 to 8 Bar</i>

products in conformity with the directive 2002/95/EC **RoHS**

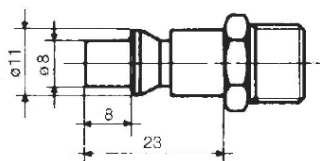

diametro foro interno 5,0 mm

I.D. hole 5,0 mm

I dati tecnici e le quote non sono vincolanti • drawings and technical data are not binding

innesto maschio • male connection

### 8460MM



CODE	T	L	H(Hex)	
8460MM02	R1/4"	36,5	14	10
8460MM03	R3/8"	37,5	17	10
8460MM04	R1/2"	41,0	22	10

**NEW**

innesto femmina • female connection

### 8470FM



CODE	T	L	H(Hex)	
8470FM02	G1/4"	35,7	15	10
8470FM03	G3/8"	36,0	19	10
8470FM04	G1/2"	41,0	25	10

**NEW**

# GIUNTI AUTOMATICI PER ARIA COMPRESSA SERIE GIAPPONE

## quick couplings JAPAN series for compressed air



### DATI TECNICI

Applicazioni	Pneumatica & Aria Compressa
Filettature	Gas conica Gas cilindrica
Pressione d'esercizio	da 0 a 8 Bar

### Technical specifications

applications	pneumatics & compressed air
threads	taper gas cylindrical gas
working pressure	from 0 to 8 Bar

Prodotti conformi alla direttiva 2002/95/EC **RoHS**

products in conformity with the directive 2002/95/EC **RoHS**

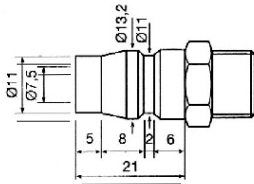

diametro foro interno 7,5 mm  
I.D. hole 7,5 mm

I dati tecnici e le quote non sono vincolanti • drawings and technical data are not binding

GIUNTI AUTOMATICI • quick couplings

240

## 8910FM

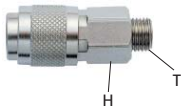

giunto maschio • male quick coupler

CODE	T	L	H(Hex)	
8910FM02	R1/4"	58,5	20	10
8910FM03	R3/8"	58,5	20	10

**NEW**

## 8920FF

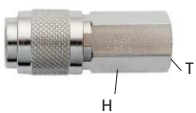

giunto femmina • female quick coupler

CODE	T	L	H(Hex)	
8920FF02	G1/4"	62,0	20	10
8920FF03	G3/8"	62,0	20	10

**NEW**

## 8960MM



innesto maschio • male connection

CODE	T	L	H(Hex)	
8960MM02	R1/4"	34,5	14	10
8960MM03	R3/8"	35,5	17	10

**NEW**

## 8970FM



innesto femmina • female connection

CODE	T	L	H(Hex)	
8970FM02	G1/4"	34,5	15	10
8970FM03	G3/8"	35,5	19	10

**NEW**