

NEW



RACCORDI PORTAGOMMA IN HDPE

HDPE barb connectors

LEGENDA CODICE • model designation

5030PE

↓
Codice
code

6

↓
Diametro Tubo I.D.
I.D. tube diameter

Codice code	Misure sizes
4	4mm
6	6mm
8	8mm



DATI TECNICI

Fluidi compatibili	Aria compressa, acqua, fluidi compatibili con i materiali costruttivi
Materiali costruttivi	Polietilene ad alta intensità (HDPE)
Pressione d'esercizio	sino a 14 Bar a 20°C
Temperatura d'esercizio	da 0°C a +70°C
Tubi utilizzabili	Tubi in poliuretano, silicone e PVC morbido
Caratteristiche	Il polimero di base è biologicamente inerte e la sua composizione chimica è conforme alle normative relative al materiale a contatto con alimenti dei seguenti paesi: Germania, Regno Unito, Olanda, Belgio, Francia, Spagna, Italia, Norvegia, Finlandia, Danimarca, Svezia, Austria, USA, nonché alle normative sovranazionali della Comunità Europea.

Technical specifications

fluid types	compressed air, water, fluids suitable with construction materials
construction materials	high density polyethylene (HDPE)
working pressure	up to 14 Bar at 20 °C
working temperature	from 0 °C to +70 °C
applicable tubes	polyurethane tubes, silicon tubes and soft PVC tubes
features	The compound is biologically inactive and its chemical composition is in compliance with the regulations related to the material in contact with food for the following countries: Germany, United Kingdom, Netherlands, Belgium, France, Spain, Italy, Norway, Finland, Denmark, Sweden, Austria, USA. It is moreover in compliance with the European Community regulations.

Prodotti conformi alla direttiva 2002/95/EC **RoHS**

Prodotti conformi alla direttiva 1907/2006



products in compliance with the directive 2002/95/EC **RoHS**

products in compliance with the directive 1907/2006



portagomma intermedio a gomito • union elbow barb connector

5030PE



NEW

CODE	Ø Interno tubo Ø internal tube mm inch	ØA	ØB	ØC	ØD	L1	L2	CH	weight (g)	25
5030PE4	4 5/32"	2,8	5,2	4,8	4,0	22,0	22,0	6,3	0,5	25
5030PE6	6 1/4"	4,0	8,0	7,5	6,0	31,2	31,2	7,8	1,4	25
5030PE8	8 5/16"	5,7	10,0	9,2	8,0	36,0	36,0	10,3	2,4	25

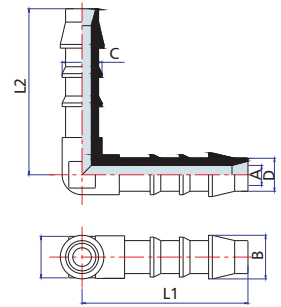

5040PE



NEW

portagomma intermedio diritto • union barb connector

CODE	Ø Interno tubo Ø internal tube mm inch	ØA	ØB	ØC	ØD	L1	L2	CH	weight (g)	25
5040PE4	4 5/32"	2,8	5,2	4,8	4,0	36	18	6,0	0,4	25
5040PE6	6 1/4"	4,0	8,0	7,5	6,0	53,6	26,8	6,0	1	25
5040PE8	8 5/16"	5,7	10,0	9,2	8,0	59,0	29,5	10,0	1,7	25

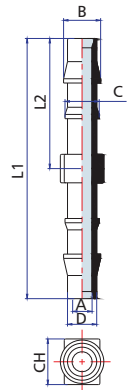

5050PE



NEW

portagomma intermedio a T • union tee barb connector

CODE	Ø Interno tubo Ø internal tube mm inch	ØA	ØB	ØC	ØD	L1	L2	CH	weight (g)	25
5050PE4	4 5/32"	2,8	5,2	4,8	4,0	39,0	21,2	6,3	0,7	25
5050PE6	6 1/4"	4,0	8,0	7,5	6,0	56,4	31,0	7,8	1,8	25
5050PE8	8 5/16"	5,7	10,0	9,2	8,0	61,5	33,0	10,3	2,7	25

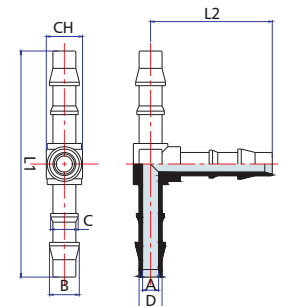

5060PE



NEW

portagomma intermedio a Y • Y barb connector

CODE	Ø Interno tubo Ø internal tube mm inch	ØA	ØB	ØC	ØD	L1	L2	CH	weight (g)	25
5060PE4	4 5/32"	2,8	5,2	4,8	4,0	20,0	20,0	6,3	0,6	25
5060PE6	6 1/4"	4,0	8,0	7,5	6,0	29,0	29,0	7,8	1,8	25
5060PE8	8 5/16"	5,7	10,0	9,2	8,0	31,2	31,2	10,3	2,7	25

