

RACCORDO PORTAGOMMA IN OTTONE • *brass barb connector*

1165



portagomma maschio cilindrico BSPP • *male barb connector BSPP thread*

| CODE | T | Ø D | I | L1 | L2 | H(Hex) | Cresta Barb | Peso Weight(g) |  |
|-----------------------|-------|-----|----|------|----|--------|-------------|----------------|---|
| 1165TRM545 new | M5 | 4,5 | 4 | 22,5 | 15 | 8 | 5,00 | 6,0 | 100 |
| 1165TRM56 | M5 | | 4 | 22,0 | 19 | 8 | 6,15 | 3,0 | 100 |
| 1165TRM66 | M6 | | 4 | 22,0 | 19 | 8 | 6,15 | 4,0 | 100 |
| 1165TR186 | G1/8" | 6 | 6 | 29,5 | 19 | 12 | 6,15 | 8,0 | 100 |
| 1165TR146 | G1/4" | | 8 | 32,0 | 19 | 14 | 6,15 | 12,0 | 100 |
| 1165TRM57 | M5 | | 4 | 22,2 | 19 | 8 | 7,15 | 3,0 | 100 |
| 1165TRM67 | M6 | | 5 | 22,0 | 19 | 8 | 7,15 | 4,0 | 100 |
| 1165TR187 | G1/8" | 7 | 6 | 29,5 | 19 | 12 | 7,15 | 8,0 | 100 |
| 1165TR147 | G1/4" | | 8 | 32,0 | 19 | 14 | 7,15 | 14,0 | 100 |
| 1165TR188 | G1/8" | 6 | 6 | 29,5 | 19 | 12 | 8,15 | 8,0 | 100 |
| 1165TR148 | G1/4" | 8 | 8 | 32,0 | 19 | 14 | 8,15 | 14,0 | 100 |
| 1165TR388 | G3/8" | 9 | 9 | 33,0 | 19 | 19 | 8,15 | 22,0 | 50 |
| 1165TR189 | G1/8" | 6 | 6 | 29,5 | 19 | 12 | 9,20 | 10,0 | 100 |
| 1165TR149 | G1/4" | 9 | 8 | 32,0 | 19 | 14 | 9,20 | 14,0 | 100 |
| 1165TR389 | G3/8" | 9 | 9 | 33,0 | 19 | 19 | 9,20 | 22,0 | 50 |
| 1165TR1810 | G1/8" | 6 | 6 | 30,5 | 20 | 12 | 10,20 | 10,0 | 100 |
| 1165TR1410 | G1/4" | 10 | 8 | 33,0 | 20 | 14 | 10,20 | 14,0 | 100 |
| 1165TR3810 | G3/8" | 9 | 9 | 34,0 | 20 | 19 | 10,20 | 23,0 | 50 |
| 1165TR1412 | G1/4" | 8 | 8 | 33,0 | 20 | 14 | 12,20 | 16,0 | 100 |
| 1165TR3812 | G3/8" | 12 | 9 | 34,0 | 20 | 19 | 12,20 | 24,0 | 50 |
| 1165TR1212 | G1/2" | 10 | 10 | 35,5 | 20 | 22 | 12,20 | 32,0 | 25 |
| 1165TR3814 | G3/8" | 14 | 9 | 36,0 | 22 | 19 | 14,25 | 26,0 | 50 |
| 1165TR1214 | G1/2" | 10 | 10 | 37,5 | 22 | 22 | 14,25 | 34,0 | 25 |
| 1165TR3817 | G3/8" | 17 | 9 | 38,0 | 24 | 19 | 17,30 | 30,0 | 25 |
| 1165TR1217 | G1/2" | 10 | 10 | 39,5 | 24 | 22 | 17,30 | 38,0 | 25 |
| 1165TR3418 | G3/4" | 18 | 11 | 41,5 | 24 | 30 | 18,50 | 58,0 | 25 |
| 1165TR1220 | G1/2" | 20 | 10 | 39,5 | 24 | 22 | 20,60 | 40,0 | 25 |
| 1165TR3420 | G3/4" | 20 | 11 | 41,5 | 24 | 30 | 20,60 | 60,0 | 25 |

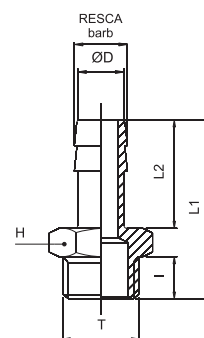

1167



portagomma maschio cilindrico BSPP con OR • *male barb connector BSPP thread with OR*

| CODE | T | Ø D | I | L1 | L2 | H(Hex) | Cresta Barb | Peso Weight(g) |  |
|-----------------------|-------|-----|------|------|----|--------|-------------|----------------|---|
| 1167TRM545 new | M5 | 4,5 | 4,5 | 23,0 | 15 | 8 | 5,00 | 6,0 | 100 |
| 1167TR186 | G1/8" | 6 | 6,5 | 30,0 | 19 | 14 | 6,15 | 10,0 | 100 |
| 1167TR146 | G1/4" | 6 | 8,0 | 32,0 | 19 | 17 | 6,15 | 16,0 | 100 |
| 1167TR187 | G1/8" | 7 | 6,5 | 30,0 | 19 | 14 | 7,15 | 10,0 | 100 |
| 1167TR147 | G1/4" | 7 | 8,0 | 32,0 | 19 | 17 | 7,15 | 16,0 | 100 |
| 1167TR188 | G1/8" | 8 | 6,5 | 30,0 | 19 | 14 | 8,15 | 12,0 | 100 |
| 1167TR148 | G1/4" | 8 | 8,0 | 32,0 | 19 | 17 | 8,15 | 17,0 | 100 |
| 1167TR189 | G1/8" | 9 | 6,5 | 30,0 | 19 | 14 | 9,20 | 14,0 | 100 |
| 1167TR149 | G1/4" | 9 | 8,0 | 32,0 | 19 | 17 | 9,20 | 16,0 | 100 |
| 1167TR389 | G3/8" | 9 | 9,0 | 33,0 | 19 | 20 | 9,20 | 22,0 | 50 |
| 1167TR1412 | G1/4" | 12 | 8,0 | 33,0 | 20 | 17 | 12,20 | 18,0 | 100 |
| 1167TR3812 | G3/8" | 12 | 9,0 | 34,0 | 20 | 20 | 12,20 | 24,0 | 50 |
| 1167TR1212 | G1/2" | 10 | 10,0 | 35,5 | 20 | 24 | 12,20 | 35,0 | 25 |
| 1167TR3817 | G3/8" | 17 | 9,0 | 38,0 | 24 | 20 | 17,30 | 30,0 | 25 |
| 1167TR1217 | G1/2" | 10 | 10,0 | 39,5 | 24 | 24 | 17,30 | 42,0 | 25 |

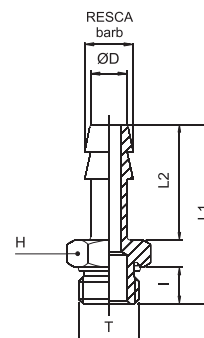

RACCORDI PORTAGOMMA IN OTTONE • brass barb connectors

portagomma maschio conico BSPT • male barb connector BSPT thread

1169



| CODE | T | Ø D | I | L1 | L2 | H(Hex) | Cresta Barb | Peso Weight(g) | |
|------------|-------|-----|------|------|----|--------|-------------|----------------|-----|
| 1169TR186 | R1/8" | 6 | 8,0 | 31,5 | 19 | 12 | 6,20 | 8,0 | 100 |
| 1169TR146 | R1/4" | | 11,0 | 35,0 | 19 | 14 | 6,20 | 14,0 | 100 |
| 1169TR187 | R1/8" | 7 | 8,0 | 31,5 | 19 | 12 | 7,20 | 10,0 | 100 |
| 1169TR147 | R1/4" | | 11,0 | 35,0 | 19 | 14 | 7,20 | 14,0 | 100 |
| 1169TR188 | R1/8" | 8 | 8,0 | 31,5 | 19 | 12 | 8,20 | 10,0 | 100 |
| 1169TR148 | R1/4" | | 11,0 | 35,0 | 19 | 14 | 8,20 | 14,0 | 100 |
| 1169TR189 | R1/8" | 9 | 8,0 | 31,5 | 19 | 12 | 9,20 | 12,0 | 100 |
| 1169TR149 | R1/4" | | 11,0 | 35,0 | 19 | 14 | 9,20 | 16,0 | 100 |
| 1169TR389 | R3/8" | 10 | 11,5 | 35,5 | 19 | 17 | 9,20 | 20,0 | 50 |
| 1169TR129 | R1/2" | | 14,0 | 38,5 | 19 | 22 | 9,20 | 32,0 | 25 |
| 1169TR1810 | R1/8" | 10 | 8,0 | 32,5 | 20 | 12 | 10,20 | 10,0 | 100 |
| 1169TR1410 | R1/4" | | 11,0 | 36,0 | 20 | 14 | 10,20 | 16,0 | 100 |
| 1169TR3810 | R3/8" | 12 | 11,5 | 36,5 | 20 | 17 | 10,20 | 22,0 | 100 |
| 1169TR1210 | R1/2" | | 14,0 | 39,5 | 20 | 22 | 10,20 | 32,0 | 25 |
| 1169TR1412 | R1/4" | 12 | 11,0 | 36,0 | 20 | 14 | 12,20 | 16,0 | 100 |
| 1169TR3812 | R3/8" | | 11,5 | 36,5 | 20 | 17 | 12,20 | 22,0 | 100 |
| 1169TR1212 | R1/2" | 14 | 14,0 | 39,5 | 20 | 22 | 12,20 | 34,0 | 25 |
| 1169TR3814 | R3/8" | | 11,5 | 38,5 | 22 | 17 | 14,30 | 24,0 | 50 |
| 1169TR1214 | R1/2" | 16 | 14,0 | 41,5 | 22 | 22 | 14,30 | 36,0 | 25 |
| 1169TR3816 | R3/8" | | 11,5 | 38,5 | 22 | 17 | 16,30 | 26,0 | 50 |
| 1169TR1216 | R1/2" | 17 | 14,0 | 41,5 | 22 | 22 | 16,30 | 36,0 | 25 |
| 1169TR3416 | R3/4" | | 16,5 | 45,0 | 22 | 27 | 16,30 | 58,0 | 25 |
| 1169TR3817 | R3/8" | 17 | 11,5 | 40,5 | 24 | 18 | 17,30 | 30,0 | 25 |
| 1169TR1217 | R1/2" | | 14,0 | 43,5 | 24 | 22 | 17,30 | 40,0 | 25 |
| 1169TR3818 | R3/8" | 18 | 11,5 | 40,5 | 24 | 19 | 18,30 | 34,0 | 25 |
| 1169TR1218 | R1/2" | | 14,0 | 43,5 | 24 | 22 | 18,30 | 44,0 | 25 |
| 1169TR3418 | R3/4" | 20 | 16,5 | 47,0 | 24 | 27 | 18,30 | 62,0 | 25 |
| 1169TR3820 | R3/8" | | 11,5 | 41,0 | 24 | 22 | 20,45 | 40,0 | 25 |
| 1169TR1220 | R1/2" | 25 | 14,0 | 43,5 | 24 | 22 | 20,45 | 42,0 | 25 |
| 1169TR3420 | R3/4" | | 16,5 | 46,5 | 24 | 27 | 20,45 | 60,0 | 25 |
| 1169TR3425 | R3/4" | 25 | 16,5 | 53,0 | 30 | 27 | 25,50 | 76,0 | 25 |
| 1169TR125 | R1" | | 19,0 | 56,0 | 30 | 34 | 25,50 | 114,0 | 25 |

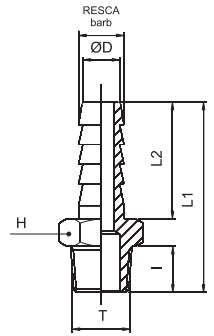

portagomma femmina cilindrico BSPP • female barb connector BSPP thread

1170



| CODE | T | Ø D | I | L1 | L2 | H(Hex) | Cresta Barb | Peso Weight(g) | |
|------------|-------|-----|------|------|------|--------|-------------|----------------|-----|
| 1170TR187 | G1/8" | 7 | 7,0 | 32,0 | 19,0 | 12 | 7,10 | 9,0 | 100 |
| 1170TR147 | G1/4" | | 10,0 | 45,5 | 32,5 | 17 | 7,10 | 21,0 | 100 |
| 1170TR188 | G1/8" | 8 | 8,0 | 38,5 | 28,0 | 12 | 8,10 | 8,0 | 100 |
| 1170TR148 | G1/4" | | 10,0 | 45,0 | 32,0 | 17 | 8,10 | 19,0 | 100 |
| 1170TR189 | G1/8" | 9 | 8,0 | 36,8 | 26,3 | 12 | 9,15 | 9,0 | 100 |
| 1170TR149 | G1/4" | | 10,0 | 35,0 | 19,0 | 17 | 9,15 | 20,0 | 100 |
| 1170TR1412 | G1/4" | 12 | 10,0 | 45,1 | 32,1 | 17 | 12,15 | 22,0 | 100 |

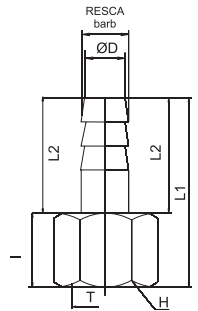

portagomma a gomito conico BSPT • male elbow barb connector BSPT thread

1171



| CODE | T | Ø D | I1 | I2 | L1 | L2 | H(Hex) | Cresta Barb | Peso Weight(g) | |
|--------------|-------|-----|------|------|------|------|--------|-------------|----------------|-----|
| 1171TR186185 | R1/8" | 6 | 8,0 | 18,5 | 22,5 | 14,0 | 8 | 6,20 | 10,0 | 100 |
| 1171TR18623 | R1/8" | | 11,0 | 23,0 | 22,5 | 14,0 | 8 | 6,20 | 12,0 | 100 |
| 1171TR14623 | R1/4" | | 11,0 | 23,0 | 23,0 | 14,0 | 9 | 6,20 | 16,0 | 100 |
| 1171TR187185 | R1/8" | 7 | 8,0 | 18,5 | 22,5 | 14,0 | 8 | 7,20 | 10,0 | 100 |
| 1171TR18723 | R1/8" | | 11,0 | 23,0 | 22,5 | 14,0 | 8 | 7,20 | 10,0 | 100 |
| 1171TR14723 | R1/4" | | 12,0 | 23,0 | 23,0 | 14,0 | 9 | 7,20 | 16,0 | 100 |

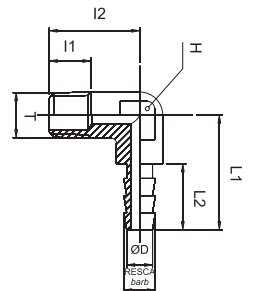

NEW

RACCORDI PORTAGOMMA IN OTTONE • brass barb connectors

portagomma a gomito serie lunga conico BSPT • long male elbow barb connector BSPT thread

1172



| CODE | T | Ø D | I1 | I2 | L1 | L2 | H(Hex) | Cresta Barb | Peso Weight(g) | |
|--------------|-------|-----|------|------|------|------|--------|-------------|----------------|-----|
| 1172TR186325 | R1/8" | | 11,0 | 22,0 | 32,5 | 14,0 | 9 | 6,20 | 18,0 | 100 |
| 1172TR18638 | R1/8" | 6 | 8,0 | 18,5 | 38,0 | 22,0 | 8 | 6,20 | 14,0 | 100 |
| 1172TR146325 | R1/4" | | 11,0 | 23,0 | 32,5 | 14,0 | 9 | 6,20 | 20,0 | 100 |
| 1172TR187325 | R1/8" | 7 | 11,0 | 22,0 | 32,5 | 14,0 | 9 | 7,20 | 16,0 | 100 |
| 1172TR18738 | R1/8" | | 8,0 | 18,5 | 38,0 | 22,0 | 8 | 7,20 | 14,0 | 100 |
| 1172TR147325 | R1/4" | | 8,0 | 23,0 | 32,5 | 14,0 | 9 | 7,20 | 20,0 | 100 |

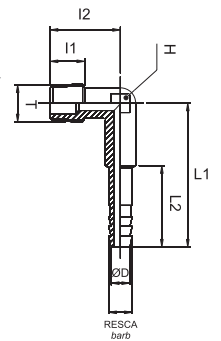

NEW

portagomma a gomito 120° serie lunga conico BSPT • long male elbow 120° barb connector BSPT thread

1173



| CODE | T | Ø D | I1 | I2 | L1 | L2 | H(Hex) | Cresta Barb | Peso Weight(g) | |
|-----------|-------|-----|-----|------|------|------|--------|-------------|----------------|-----|
| 1173TR186 | R1/8" | 6 | 8,0 | 18,5 | 38,0 | 23,0 | 8 | 6,20 | 14,0 | 100 |
| 1173TR187 | R1/8" | 7 | 8,0 | 18,5 | 38,0 | 23,0 | 8 | 7,20 | 12,0 | 100 |

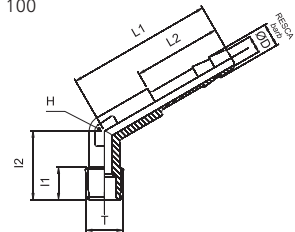

NEW

innesto rapido con portagomma • push-in fitting with barb connector

TR



| CODE | Tubo A (mm) | Tubo B (mm) | L (mm) | Peso (g) weight | |
|---------|-------------|-------------|--------|-----------------|----|
| TR1213P | 12 | 13 | 40,7 | 24,0 | 50 |

RESCH
barb

$\varnothing D$

L2

L1

H

I

T

