

RACCORDI A COMPRESSIONE • *compression fittings*

PAG 129 RACCORDI A COMPRESSIONE IN OTTONE GIALLO
yellow brass compression fittings

PAG 133 RACCORDI A COMPRESSIONE IN OTTONE
brass compression fittings

PAG 139 RACCORDI A COMPRESSIONE INOX AISI 316 DIN 2353
compression fittings INOX AISI 316 DIN 2353

AISI 316

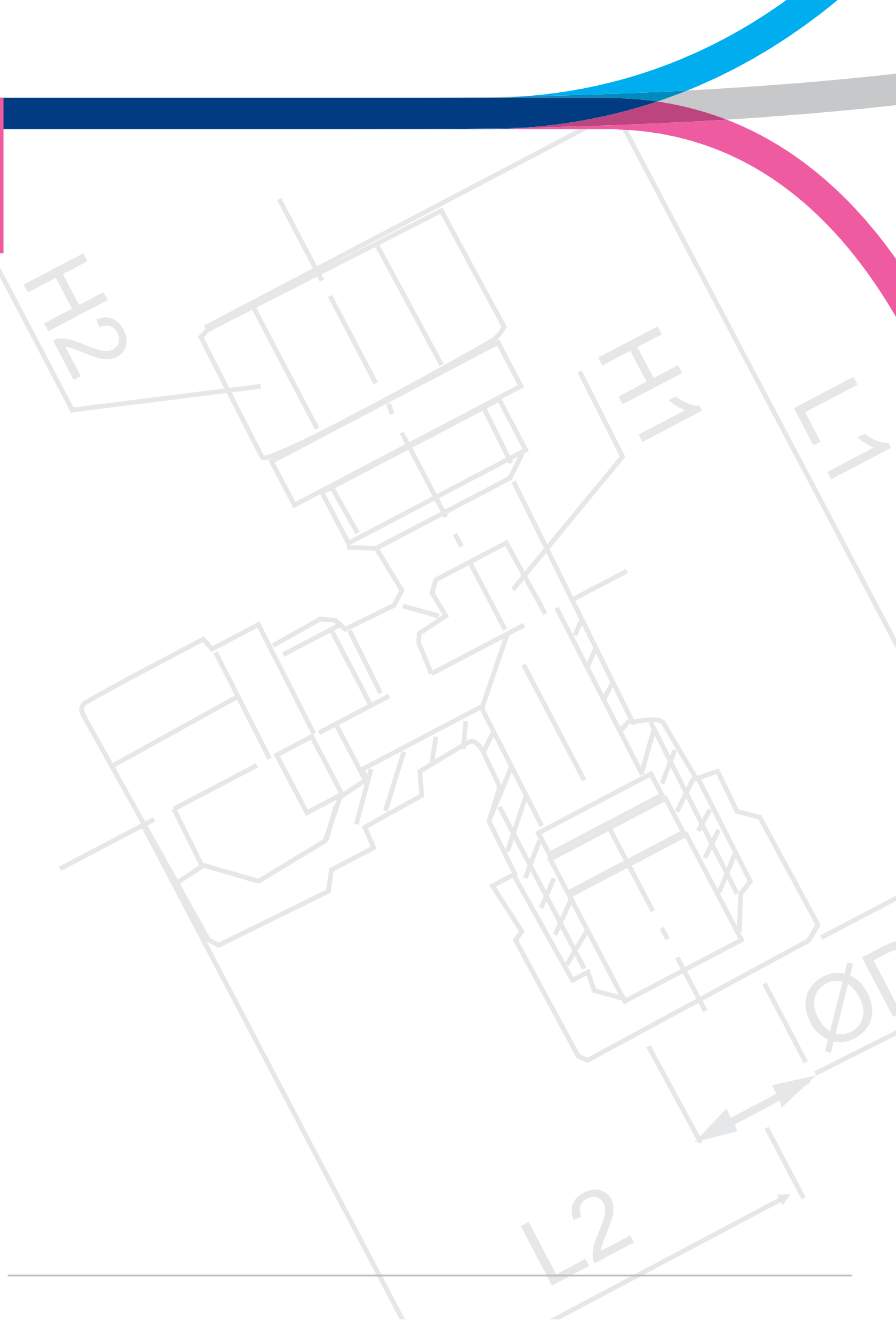

NEW

RACCORDI A COMPRESSIONE IN OTTONE GIALLO

yellow brass compression fittings

LEGENDA CODICE • Model designation

3400TR

↓
Codice
code

18

↓
Filetto
thread size

6

↓
Diametro Tubo
tube diameter

| Conico BSPT BSPT thread | | Cilindrico BSPP BSPP thread | |
|----------------------------|-------|--------------------------------|-------|
| 18 | R1/8" | 18 | G1/8" |
| 14 | R1/4" | 14 | G1/4" |
| 38 | R3/8" | 38 | G3/8" |
| 12 | R1/2" | 12 | G1/2" |
| 34 | R3/4" | 34 | G3/4" |
| 1 | R1" | 1 | G1" |

| Codice code | Misura size |
|----------------|----------------|
| 6 | 6mm |
| 8 | 8mm |
| 10 | 10mm |
| 14 | 14mm |
| 16 | 16mm |
| 18 | 18mm |
| 22 | 22mm |

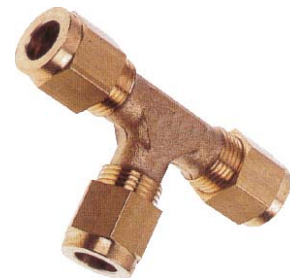

DATI TECNICI

| | | | | | | | | | | | | | | | | | |
|--------------------------------|---|----------|------|----|-----|----|-----|-----|-----|-----|-----|-----|-----|-----|-----|-----|-----|
| Fluidi compatibili | Aria compressa, acqua, gasolio per riscaldamento domestico, idrocarburi e fluidi compatibili con i materiali costruttivi. | | | | | | | | | | | | | | | | |
| Materiali utilizzati | Ottone giallo UNI EN 12164 CW 614N Ottone giallo UNI EN 12164 CW 617N | | | | | | | | | | | | | | | | |
| Filettature | Gas Conica BSPT da R1/8" a R1" Gas Cilindrica BSPP da G1/8" a G1" | | | | | | | | | | | | | | | | |
| Pressione d'esercizio | da 60 a 100 Bar a seconda del tubo utilizzato e della temperatura d'esercizio. Contattare l'Ufficio Tecnico Tierre Group per maggiori informazioni | | | | | | | | | | | | | | | | |
| Temperatura consigliata | da -40°C a +70°C | | | | | | | | | | | | | | | | |
| Tubi da utilizzare | Tubi metallici: ottone, rame Tubo autoserrante AS (da utilizzare con ns. articoli 3467 - 3468) | | | | | | | | | | | | | | | | |
| Montaggio | - Tagliare il tubo ed eliminare bave interne ed esterne - Inserire il dado nel tubo e lubrificare il filetto - Montare l'ogiva sulla parte finale del tubo - Spingere il tubo fino alla battuta all'interno del raccordo - Avvitare il dado lubrificato fino ad avere il tubo fissato grazie al grip dell'ogiva | | | | | | | | | | | | | | | | |
| Coppia di serraggio | <table border="0"> <tr> <td>Diametro</td> <td>Kg/m</td> </tr> <tr> <td>Ø6</td> <td>1,6</td> </tr> <tr> <td>Ø8</td> <td>1,6</td> </tr> <tr> <td>Ø10</td> <td>1,9</td> </tr> <tr> <td>Ø14</td> <td>3,5</td> </tr> <tr> <td>Ø16</td> <td>5,0</td> </tr> <tr> <td>Ø18</td> <td>6,0</td> </tr> <tr> <td>Ø22</td> <td>7,0</td> </tr> </table> | Diametro | Kg/m | Ø6 | 1,6 | Ø8 | 1,6 | Ø10 | 1,9 | Ø14 | 3,5 | Ø16 | 5,0 | Ø18 | 6,0 | Ø22 | 7,0 |
| Diametro | Kg/m | | | | | | | | | | | | | | | | |
| Ø6 | 1,6 | | | | | | | | | | | | | | | | |
| Ø8 | 1,6 | | | | | | | | | | | | | | | | |
| Ø10 | 1,9 | | | | | | | | | | | | | | | | |
| Ø14 | 3,5 | | | | | | | | | | | | | | | | |
| Ø16 | 5,0 | | | | | | | | | | | | | | | | |
| Ø18 | 6,0 | | | | | | | | | | | | | | | | |
| Ø22 | 7,0 | | | | | | | | | | | | | | | | |

Technical specifications

| | | | | | | | | | | | | | | | | | |
|-------------------------------|---|----------|------|----|-----|----|-----|-----|-----|-----|-----|-----|-----|-----|-----|-----|-----|
| fluid types | compressed air, water, diesel for domestic heating, hydrocarbons and fluids suitable with construction materials | | | | | | | | | | | | | | | | |
| construction materials | yellow brass UNI EN 12164 CW 614N yellow brass UNI EN 12164 CW 617N | | | | | | | | | | | | | | | | |
| threads | taper gas BSPT from R1/8" to R1" parallel gas BSPP from G1/8" to G1" | | | | | | | | | | | | | | | | |
| working pressure | from 60 Bar to 100 Bar depending on the tube used and on the working temperature. Ask to Tierre Group technical dept for more information | | | | | | | | | | | | | | | | |
| temperature suggested | from -40°C to +70°C | | | | | | | | | | | | | | | | |
| tubes used | metal tubes: brass, copper self fastening tube AS (to be used with our 3467 and 3468) | | | | | | | | | | | | | | | | |
| assembly | - Cut the tube and remove the internal and external burrs - Insert the nut into the tube and lubricate the thread insert - Put the ogive on the final part of the tube - Push the tube until it is stopped into the fitting - Screw the lubricated nut in order to obtain the tube secured thanks to the grip of the ogive | | | | | | | | | | | | | | | | |
| tightening torque | <table border="0"> <tr> <td>diameter</td> <td>Kg/m</td> </tr> <tr> <td>Ø6</td> <td>1,6</td> </tr> <tr> <td>Ø8</td> <td>1,6</td> </tr> <tr> <td>Ø10</td> <td>1,9</td> </tr> <tr> <td>Ø14</td> <td>3,5</td> </tr> <tr> <td>Ø16</td> <td>5,0</td> </tr> <tr> <td>Ø18</td> <td>6,0</td> </tr> <tr> <td>Ø22</td> <td>7,0</td> </tr> </table> | diameter | Kg/m | Ø6 | 1,6 | Ø8 | 1,6 | Ø10 | 1,9 | Ø14 | 3,5 | Ø16 | 5,0 | Ø18 | 6,0 | Ø22 | 7,0 |
| diameter | Kg/m | | | | | | | | | | | | | | | | |
| Ø6 | 1,6 | | | | | | | | | | | | | | | | |
| Ø8 | 1,6 | | | | | | | | | | | | | | | | |
| Ø10 | 1,9 | | | | | | | | | | | | | | | | |
| Ø14 | 3,5 | | | | | | | | | | | | | | | | |
| Ø16 | 5,0 | | | | | | | | | | | | | | | | |
| Ø18 | 6,0 | | | | | | | | | | | | | | | | |
| Ø22 | 7,0 | | | | | | | | | | | | | | | | |

Prodotti conformi alla direttiva 2002/95/EC **RoHS**

Prodotti conformi alla direttiva 1907/2006 

products in compliance with the directive 2002/95/EC **RoHS**

products in compliance with the directive 1907/2006 

I dati tecnici e le quote non sono vincolanti • drawings and technical data are not binding

RACCORDI A COMPRESSIONE IN OTTONE GIALLO • yellow brass compression fittings

diritto maschio conico BSPT • male connector BSPT thread

3400



NEW

| CODE | T | ØD | L | S | H1(Hex) | H2(Hex) | Peso Weight(g) | |
|------------|-------|----|------|------|---------|---------|----------------|----|
| 3400TR186 | R1/8" | 6 | 18,0 | 7,5 | 11 | 13 | 18,0 | 10 |
| 3400TR146 | R1/4" | 6 | 18,0 | 7,5 | 14 | 13 | 25,0 | 10 |
| 3400TR188 | R1/8" | 8 | 19,5 | 7,0 | 13 | 14 | 22,0 | 10 |
| 3400TR148 | R1/4" | 8 | 19,5 | 7,0 | 14 | 14 | 27,0 | 10 |
| 3400TR388 | R3/8" | 8 | 20,5 | 8,0 | 17 | 14 | 33,0 | 10 |
| 3400TR1410 | R1/4" | 10 | 24,0 | 9,0 | 17 | 19 | 48,0 | 10 |
| 3400TR3810 | R3/8" | 10 | 24,0 | 9,0 | 17 | 19 | 49,0 | 10 |
| 3400TR1210 | R1/2" | 10 | 25,0 | 10,0 | 22 | 19 | 67,0 | 10 |
| 3400TR3814 | R3/8" | 14 | 25,0 | 8,0 | 22 | 24 | 70,0 | 10 |
| 3400TR1214 | R1/2" | 14 | 26,0 | 9,0 | 22 | 24 | 80,0 | 10 |
| 3400TR1216 | R1/2" | 16 | 27,0 | 9,5 | 24 | 27 | 101,0 | 10 |
| 3400TR1218 | R1/2" | 18 | 30,0 | 10,5 | 27 | 30 | 132,0 | 10 |
| 3400TR3418 | R3/4" | 18 | 30,0 | 10,5 | 27 | 30 | 143,0 | 10 |
| 3400TR3422 | R3/4" | 22 | 33,0 | 11,0 | 32 | 36 | 195,0 | 10 |
| 3400TR122 | R1" | 22 | 33,0 | 11,0 | 36 | 36 | 225,0 | 10 |

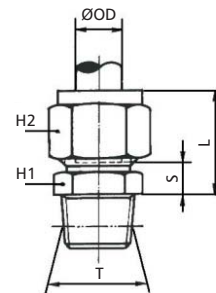

diritto femmina cilindrico BSPP • female connector BSPP thread

3430



NEW

| CODE | T | ØD | I | S | L | H1(Hex) | H2(Hex) | Peso Weight(g) | |
|------------|-------|----|------|------|----|---------|---------|----------------|----|
| 3430TR186 | G1/8" | 6 | 9,5 | 17,0 | 28 | 14 | 13 | 26,0 | 10 |
| 3430TR146 | G1/4" | 6 | 13,5 | 21,0 | 32 | 17 | 13 | 35,0 | 10 |
| 3430TR188 | G1/8" | 8 | 9,5 | 16,5 | 29 | 14 | 14 | 28,0 | 10 |
| 3430TR148 | G1/4" | 8 | 13,5 | 20,5 | 33 | 17 | 14 | 36,0 | 10 |
| 3430TR388 | G3/8" | 8 | 14,0 | 21,0 | 34 | 22 | 14 | 53,0 | 10 |
| 3430TR1410 | G1/4" | 10 | 13,5 | 21,5 | 37 | 17 | 19 | 52,0 | 10 |
| 3430TR3810 | G3/8" | 10 | 14,0 | 22,0 | 37 | 22 | 19 | 70,0 | 10 |
| 3430TR1210 | G1/2" | 10 | 18,5 | 26,5 | 42 | 27 | 19 | 102,0 | 10 |
| 3430TR3814 | G3/8" | 14 | 14,0 | 21,0 | 38 | 22 | 24 | 82,0 | 10 |
| 3430TR1214 | G1/2" | 14 | 18,5 | 25,5 | 43 | 27 | 24 | 113,0 | 10 |
| 3430TR1218 | G1/2" | 18 | 18,5 | 26,0 | 45 | 27 | 30 | 147,0 | 10 |
| 3430TR3418 | G3/4" | 18 | 19,5 | 27,0 | 46 | 32 | 30 | 169,0 | 10 |
| 3430TR3422 | G3/4" | 22 | 19,5 | 26,5 | 48 | 32 | 36 | 205,0 | 10 |

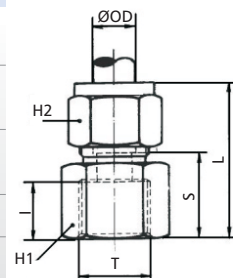

gomito maschio conico BSPT • male elbow BSPT thread

3440



NEW

| CODE | T | ØD | L1 | L2 | S | H1(Hex) | H2(Hex) | Peso Weight(g) | |
|------------|-------|----|------|------|------|---------|---------|----------------|----|
| 3440TR186 | R1/8" | 6 | 22,0 | 18,0 | 13,0 | 8 | 13 | 22,0 | 10 |
| 3440TR146 | R1/4" | 6 | 22,0 | 21,5 | 13,0 | 10 | 13 | 31,0 | 10 |
| 3440TR188 | R1/8" | 8 | 28,0 | 18,5 | 15,0 | 10 | 14 | 29,0 | 10 |
| 3440TR148 | R1/4" | 8 | 28,0 | 22,0 | 15,0 | 10 | 14 | 34,0 | 10 |
| 3440TR388 | R3/8" | 8 | 28,0 | 24,0 | 15,0 | 12 | 14 | 45,0 | 10 |
| 3440TR1410 | R1/4" | 10 | 30,0 | 25,0 | 17,0 | 12 | 19 | 53,0 | 10 |
| 3440TR3810 | R3/8" | 10 | 30,0 | 25,5 | 17,0 | 12 | 19 | 62,0 | 10 |
| 3440TR1210 | R1/2" | 10 | 36,0 | 32,0 | 17,0 | 19 | 19 | 107,0 | 10 |
| 3440TR3814 | R3/8" | 14 | 35,0 | 30,0 | 18,0 | 19 | 24 | 105,0 | 10 |
| 3440TR1214 | R1/2" | 14 | 35,0 | 32,0 | 18,0 | 19 | 24 | 109,0 | 10 |
| 3440TR1216 | R1/2" | 16 | 39,0 | 33,5 | 21,0 | 19 | 27 | 135,0 | 10 |
| 3440TR1218 | R1/2" | 18 | 41,0 | 35,5 | 21,5 | 23 | 30 | 176,0 | 10 |
| 3440TR3418 | R3/4" | 18 | 41,0 | 36,5 | 21,5 | 23 | 30 | 203,0 | 10 |
| 3440TR3422 | R3/4" | 22 | 50,0 | 40,0 | 25,0 | 27 | 36 | 296,0 | 10 |
| 3440TR122 | R1" | 22 | 50,0 | 44,0 | 25,0 | 27 | 36 | 324,0 | 10 |

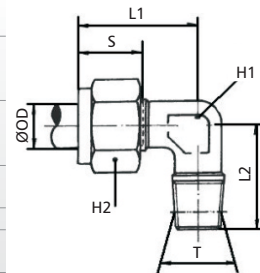

gomito maschio orientabile cilindrico BSPP • swivel male elbow BSPP thread

3442



NEW

| CODE | T | ØD | L1 | L2 | S | H1(Hex) | H2(Hex) | Peso Weight(g) | |
|------------|-------|----|------|------|------|---------|---------|----------------|----|
| 3442TR186 | G1/8" | 6 | 22,0 | 16,0 | 13,0 | 8 | 13 | 23,0 | 10 |
| 3442TR146 | G1/4" | 6 | 22,0 | 22,0 | 13,0 | 10 | 13 | 31,0 | 10 |
| 3442TR188 | G1/8" | 8 | 28,0 | 18,5 | 15,0 | 10 | 14 | 29,0 | 10 |
| 3442TR148 | G1/4" | 8 | 28,0 | 22,0 | 15,0 | 10 | 14 | 34,0 | 10 |
| 3442TR388 | G3/8" | 8 | 28,0 | 24,0 | 15,0 | 12 | 14 | 43,0 | 10 |
| 3442TR1410 | G1/4" | 10 | 30,0 | 22,0 | 17,0 | 12 | 19 | 53,0 | 10 |
| 3442TR3810 | G3/8" | 10 | 30,0 | 24,0 | 17,0 | 12 | 19 | 64,0 | 10 |
| 3442TR1210 | G1/2" | 10 | 30,0 | 29,5 | 17,0 | 19 | 19 | 102,0 | 10 |
| 3442TR3814 | G3/8" | 14 | 35,0 | 25,0 | 18,0 | 19 | 24 | 105,0 | 10 |
| 3442TR1214 | G1/2" | 14 | 35,0 | 29,5 | 18,0 | 19 | 24 | 108,0 | 10 |
| 3442TR1218 | G1/2" | 18 | 41,0 | 30,5 | 21,0 | 23 | 30 | 174,0 | 10 |
| 3442TR3418 | G3/4" | 18 | 41,0 | 32,8 | 21,5 | 23 | 30 | 202,0 | 10 |
| 3442TR3422 | G3/4" | 22 | 50,0 | 32,8 | 25,0 | 27 | 36 | 295,0 | 10 |
| 3442TR122 | G1" | 22 | 50,0 | 43,5 | 25,0 | 27 | 36 | 323,0 | 10 |

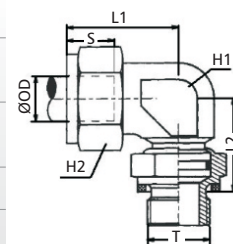

RACCORDI A COMPRESSIONE IN OTTONE GIALLO • yellow brass compression fittings

diritto intermedio • union connector

3480



NEW

| CODE | ØD | S | L | H1(Hex) | H2(Hex) | Peso Weight(g) |  |
|----------|----|------|------|---------|---------|----------------|---|
| 3480TR6 | 6 | 11,0 | 32,0 | 11 | 13 | 19,0 | 1 |
| 3480TR8 | 8 | 10,0 | 36,0 | 13 | 14 | 28,0 | 1 |
| 3480TR10 | 10 | 13,0 | 42,0 | 17 | 19 | 69,0 | 1 |
| 3480TR14 | 14 | 11,0 | 45,0 | 22 | 24 | 151,0 | 1 |
| 3480TR16 | 16 | 13,0 | 48,0 | 24 | 27 | 180,0 | 1 |
| 3480TR18 | 18 | 14,0 | 53,0 | 27 | 30 | 201,0 | 1 |
| 3480TR22 | 22 | 14,0 | 60,0 | 32 | 36 | 225,0 | 1 |

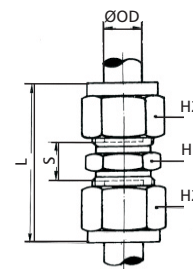

131

gomito intermedio • union elbow

3500



NEW

| CODE | ØD | L | H1(Hex) | H2(Hex) | Peso Weight(g) |  |
|----------|----|------|---------|---------|----------------|---|
| 3500TR6 | 6 | 22,0 | 8 | 13 | 26,0 | 10 |
| 3500TR8 | 8 | 28,0 | 10 | 14 | 34,0 | 10 |
| 3500TR10 | 10 | 30,0 | 12 | 19 | 74,0 | 10 |
| 3500TR14 | 14 | 35,0 | 19 | 24 | 156,0 | 10 |
| 3500TR16 | 16 | 39,0 | 19 | 27 | 190,0 | 10 |
| 3500TR18 | 18 | 41,0 | 23 | 30 | 232,0 | 10 |
| 3500TR22 | 22 | 50,0 | 27 | 36 | 254,0 | 10 |

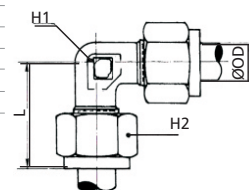

T intermedio • union tee

3510



NEW

| CODE | ØD | S | L | H1(Hex) | H2(Hex) | Peso Weight(g) |  |
|----------|----|------|----|---------|---------|----------------|---|
| 3510TR6 | 6 | 11 | 22 | 8 | 13 | 33,0 | 10 |
| 3510TR8 | 8 | 15 | 28 | 10 | 14 | 45,0 | 10 |
| 3510TR10 | 10 | 14,5 | 30 | 12 | 19 | 105,0 | 10 |
| 3510TR14 | 14 | 18 | 35 | 19 | 24 | 230,0 | 10 |
| 3510TR16 | 16 | 21 | 39 | 19 | 27 | 275,0 | 10 |
| 3510TR18 | 18 | 21,5 | 41 | 23 | 30 | 333,0 | 10 |
| 3510TR22 | 22 | 29 | 50 | 27 | 36 | 364,0 | 10 |

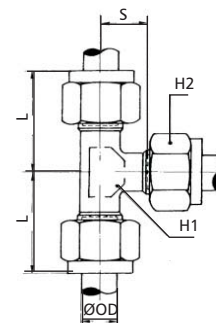

dado di bloccaggio • locking nut

3530



NEW

| CODE | ØD | T | L | H (Hex) | Peso Weight(g) |  |
|----------|----|---------|------|---------|----------------|---|
| 3530TR6 | 6 | M10x1 | 11,0 | 13 | 5,4 | 10 |
| 3530TR8 | 8 | M12x1 | 13,0 | 14 | 7,0 | 10 |
| 3530TR10 | 10 | M16x1,5 | 15,0 | 19 | 18,2 | 10 |
| 3530TR14 | 14 | M20x1,5 | 15,0 | 24 | 44,3 | 10 |
| 3530TR16 | 16 | M22x1,5 | 17,0 | 27 | 55,6 | 10 |
| 3530TR18 | 18 | M24x1,5 | 18,0 | 30 | 64,2 | 10 |
| 3530TR22 | 22 | M30x1,5 | 19,0 | 36 | 76,3 | 10 |

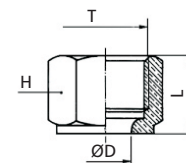

ogiva • ogive

3540



NEW

| CODE | ØD | L | Peso Weight(g) | |
|----------|----|------|----------------|----|
| 3540TR6 | 6 | 6,5 | 0,82 | 10 |
| 3540TR8 | 8 | 7,0 | 1,12 | 10 |
| 3540TR10 | 10 | 8,0 | 3,30 | 10 |
| 3540TR14 | 14 | 8,5 | 4,42 | 10 |
| 3540TR16 | 16 | 9,0 | 5,00 | 10 |
| 3540TR18 | 18 | 9,5 | 5,90 | 10 |
| 3540TR22 | 22 | 11,0 | 7,10 | 10 |

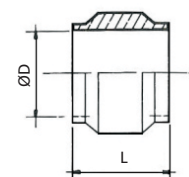

3467



portagomma maschio cilindrico BSPP • male barb connector BSPP thread

| CODE | T | Ø D1 | DN | L | L1 | F | ØG | ØP | Peso Weight (g) | |
|------------|-------|--------------|------|------|------|----|------|------|-----------------|----|
| 3467TR1814 | G1/8" | 1/4"(6,3mm) | 1/4" | 31,5 | 20,0 | 13 | 14,0 | 4,0 | 14,0 | 10 |
| 3467TR1414 | G1/4" | 1/4"(6,3mm) | 1/4" | 35,0 | 20,0 | 17 | 14,0 | 4,0 | 26,0 | 10 |
| 3467TR1438 | G1/4" | 3/8"(9,5mm) | 3/8" | 39,1 | 24,1 | 17 | 17,0 | 7,5 | 27,0 | 10 |
| 3467TR3838 | G3/8" | 3/8"(9,5mm) | 3/8" | 42,5 | 24,1 | 22 | 17,0 | 7,5 | 47,0 | 10 |
| 3467TR3812 | G3/8" | 1/2"(12,7mm) | 1/2" | 46,5 | 28,0 | 22 | 20,5 | 10,0 | 48,0 | 10 |
| 3467TR1212 | G1/2" | 1/2"(12,7mm) | 1/2" | 48,5 | 28,0 | 27 | 20,5 | 10,0 | 79,0 | 10 |
| 3467TR1258 | G1/2" | 5/8"(15,9mm) | 5/8" | 56,5 | 36,5 | 27 | 24,0 | 13,5 | 73,0 | 10 |
| 3467TR3458 | G3/4" | 5/8"(15,9mm) | 5/8" | 58,5 | 36,5 | 32 | 24,0 | 13,5 | 117,0 | 10 |
| 3467TR3434 | G3/4" | 3/4"(19,1mm) | 3/4" | 65,3 | 43,0 | 32 | 27,0 | 16,0 | 123,0 | 10 |

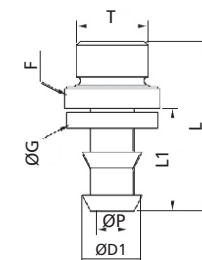

3468



portagomma femmina metrico BSPP • female barb connector BSPP thread

| CODE | DN | T | Ø D1 | DN | L1 | L2 | Ø C | E | Ø P | Peso Weight(g) | |
|-------------|----|---------|--------------|------|------|------|------|------|------|----------------|----|
| 3468TRM1014 | 6 | M10X1 | 1/4"(6,3mm) | 1/4" | 33,5 | 11,0 | 16,5 | 13,0 | 4,0 | 17,0 | 10 |
| 3468TRM1214 | 8 | M12X1 | 1/4"(6,3mm) | 1/4" | 34,5 | 13,0 | 16,5 | 14,0 | 4,8 | 18,0 | 10 |
| 3468TRM1614 | 10 | M16X1,5 | 1/4"(6,3mm) | 1/4" | 35,8 | 15,0 | 16,5 | 19,0 | 4,8 | 33,0 | 10 |
| 3468TRM1638 | 10 | M16X1,5 | 3/8"(9,5mm) | 3/8" | 39,3 | 15,0 | 19,5 | 19,0 | 7,5 | 35,0 | 10 |
| 3468TRM2038 | 14 | M20X1,5 | 3/8"(9,5mm) | 3/8" | 39,3 | 15,0 | 19,5 | 24,0 | 7,5 | 52,0 | 10 |
| 3468TRM2012 | 14 | M20X1,5 | 1/2"(12,7mm) | 1/2" | 44,0 | 15,0 | 23,5 | 24,0 | 10,0 | 56,0 | 10 |
| 3468TRM2212 | 15 | M22X1,5 | 1/2"(12,7mm) | 1/2" | 45,0 | 17,0 | 23,5 | 27,0 | 10,0 | 77,0 | 10 |
| 3468TRM2412 | 16 | M24X1,5 | 1/2"(12,7mm) | 1/2" | 47,0 | 18,0 | 23,5 | 30,0 | 10,0 | 99,0 | 10 |
| 3468TRM2458 | 16 | M24X1,5 | 5/8"(15,9mm) | 5/8" | 55,0 | 18,0 | 27,0 | 30,0 | 13,5 | 97,0 | 10 |
| 3468TRM3034 | 22 | M30X1,5 | 3/4"(19,1mm) | 3/4" | 62,0 | 18,5 | 30,0 | 36,0 | 16,0 | 137,0 | 10 |

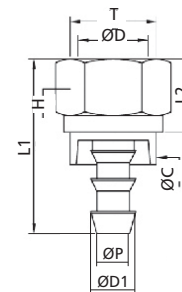

AS

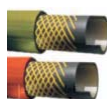

tubo autoserrante AS
AS self fastening tube

RACCORDI A COMPRESSIONE IN OTTONE

brass compression fittings

LEGENDA CODICE • Model designation

3100TR

 ↓
Codice
code

18

 ↓
Filetto
thread size

| Conico BSPT BSPT thread | |
|--------------------------------|-------|
| 18 | R1/8" |
| 14 | R1/4" |
| 38 | R3/8" |
| 12 | R1/2" |
| Cilindrico BSPP BSPP thread | |
| 18 | G1/8" |
| 14 | G1/4" |
| 38 | G3/8" |
| 12 | G1/2" |

4

 ↓
Diametro Tubo
tube diameter

| Codice code | Misura size |
|----------------|----------------|
| 4 | 4mm |
| 6 | 6mm |
| 8 | 8mm |
| 10 | 10mm |
| 12 | 12mm |
| 14 | 14mm |
| 15 | 15mm |
| 16 | 16mm |
| 18 | 18mm |



DATI TECNICI

| | |
|--------------------------------|---|
| Fluidi compatibili | Aria compressa, olio, fluidi compatibili con i materiali costruttivi. Le sedi tubo, le ogive ed i dadi sono prodotte rispettando le normative DIN 3870-3861 |
| Materiali costruttivi | Corpo: Ottone nichelato UNI EN 12164 CW 614N Ottone nichelato UNI EN 12165 CW 617N Dado: Ottone nichelato UNI EN 12164 CW 614N Ogiva: Ottone UNI EN 12164 CW 614N |
| Filettature | Gas Conica BSPT ISO 7 da R1/8" a R1/2" Gas Cilindrica BSPP ISO 228 da G1/8" a G1/2" |
| Pressione d'esercizio | sino a 60 Bar |
| Temperatura d'esercizio | da -20°C a +90°C la pressione massima di esercizio e la temperatura sono determinate dalle caratteristiche del tubo impiegato. Contattare l'Ufficio Tecnico Tierre Group per maggiori informazioni |
| Tubi utilizzabili | Ottone Rame Acciaio Alluminio Poliamide (PA) utilizzare anima di rinforzo (art. 3250) Polietilene (PE) utilizzare anima di rinforzo (art. 3250) PTFE utilizzare anima di rinforzo (art. 3250) FEP utilizzare anima di rinforzo (art. 3250) |

Technical specifications

| | |
|-------------------------------|--|
| fluid types | compressed air, oil, fluids suitable with construction materials. Tube sites, ogives and locking nuts are manufactured in compliance with DIN 3870 - 3861 |
| construction materials | body: nickel plated brass UNI EN 12164 CW 614N nickel plated brass UNI EN 12165 CW 617N nut: nickel plated brass UNI EN 12164 CW 614N ogive: brass UNI EN 12164 CW 614N |
| threads | taper gas BSPT ISO 7 from R1/8" to R1/2" parallel gas BSPP ISO 228 from G1/8" to G1/2" |
| working pressure | up to 60 Bar |
| working temperature | from -20°C to +90°C the working pressure and the working temperature depends on the features of the selected tube. Please contact Tierre Group Technical Department for more information |
| applicable tubes | brass copper steel aluminum polyamide (PA) using support bush (art. 3250) polyethylene (PE) using support bush (art. 3250) PTFE using support bush (art. 3250) FEP using support bush (art. 3250) |

 Prodotti conformi alla direttiva 2002/95/EC 

 Prodotti conformi alla direttiva 1907/2006 

 products in compliance with the directive 2002/95/EC 

 products in compliance with the directive 1907/2006 

I dati tecnici e le quote non sono vincolanti • drawings and technical data are not binding

diritto maschio conico BSPT • *male connector BSPT thread*

3100



| CODE | T | ØD | I | L | H1(Hex) | H2(Hex) | Peso Weight(g) | |
|------------|-------|----|------|------|---------|---------|----------------|-----|
| 3100TR184 | R1/8" | 4 | 8,0 | 27,0 | 10 | 10 | 12,0 | 100 |
| 3100TR186 | R1/8" | 6 | 8,0 | 28,0 | 12 | 12 | 16,0 | 100 |
| 3100TR146 | R1/4" | 6 | 11,0 | 32,5 | 14 | 12 | 24,0 | 100 |
| 3100TR188 | R1/8" | 8 | 8,0 | 29,5 | 12 | 14 | 18,0 | 100 |
| 3100TR148 | R1/4" | 8 | 11,0 | 33,0 | 14 | 14 | 24,0 | 50 |
| 3100TR388 | R3/8" | 8 | 11,5 | 33,0 | 17 | 14 | 36,0 | 25 |
| 3100TR1410 | R1/4" | 10 | 11,0 | 37,5 | 17 | 19 | 44,0 | 50 |
| 3100TR3810 | R3/8" | 10 | 11,5 | 38,0 | 17 | 19 | 50,0 | 50 |
| 3100TR1210 | R1/2" | 10 | 14,0 | 40,5 | 22 | 19 | 74,0 | 25 |
| 3100TR3812 | R3/8" | 12 | 11,5 | 39,0 | 19 | 22 | 58,0 | 25 |
| 3100TR1212 | R1/2" | 12 | 14,0 | 41,0 | 22 | 22 | 78,0 | 25 |
| 3100TR1214 | R1/2" | 14 | 14,0 | 42,5 | 22 | 27 | 102,0 | 25 |
| 3100TR1215 | R1/2" | 15 | 14,0 | 42,5 | 22 | 27 | 96,0 | 25 |
| 3100TR1216 | R1/2" | 16 | 14,0 | 42,0 | 24 | 30 | 112,0 | 10 |
| 3100TR1218 | R1/2" | 18 | 14,0 | 43,0 | 26 | 32 | 126,0 | 10 |

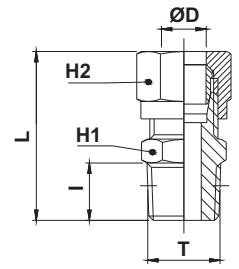

diritto maschio cilindrico BSPP • *male connector BSPP thread*

3120



| CODE | T | ØD | I | L | H1(Hex) | H2(Hex) | Peso Weight(g) | |
|------------|-------|----|-----|------|---------|---------|----------------|-----|
| 3120TR184 | G1/8" | 4 | 6,0 | 25,0 | 14 | 10 | 16,0 | 100 |
| 3120TR186 | G1/8" | 6 | 6,0 | 26,0 | 14 | 12 | 16,0 | 100 |
| 3120TR146 | G1/4" | 6 | 8,0 | 29,5 | 17 | 12 | 24,0 | 100 |
| 3120TR188 | G1/8" | 8 | 6,0 | 27,5 | 14 | 14 | 18,0 | 100 |
| 3120TR148 | G1/4" | 8 | 8,0 | 30,0 | 17 | 14 | 28,0 | 50 |
| 3120TR388 | G3/8" | 8 | 9,0 | 30,5 | 19 | 14 | 34,0 | 25 |
| 3120TR1410 | G1/4" | 10 | 8,0 | 34,5 | 17 | 19 | 44,0 | 50 |
| 3120TR3810 | G3/8" | 10 | 9,0 | 36,0 | 19 | 19 | 50,0 | 50 |

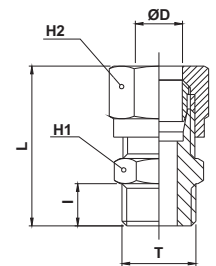

diritto femmina cilindrico BSPP • *female connector BSPP thread*

3130



| CODE | T | ØD | I | L | H1(Hex) | H2(Hex) | Peso Weight(g) | |
|------------|-------|----|------|------|---------|---------|----------------|-----|
| 3130TR184 | G1/8" | 4 | 8,0 | 24,5 | 14 | 10 | 16,0 | 100 |
| 3130TR186 | G1/8" | 6 | 8,0 | 26,0 | 14 | 12 | 17,0 | 100 |
| 3130TR146 | G1/4" | 6 | 11,0 | 30,5 | 17 | 12 | 26,0 | 100 |
| 3130TR188 | G1/8" | 8 | 8,0 | 26,5 | 14 | 14 | 20,0 | 100 |
| 3130TR148 | G1/4" | 8 | 11,0 | 31,0 | 17 | 14 | 28,0 | 100 |
| 3130TR388 | G3/8" | 8 | 11,5 | 31,0 | 20 | 14 | 32,0 | 50 |
| 3130TR1410 | G1/4" | 10 | 11,0 | 35,5 | 17 | 19 | 46,0 | 50 |
| 3130TR3810 | G3/8" | 10 | 11,5 | 36,5 | 20 | 19 | 50,0 | 50 |
| 3130TR3812 | G3/8" | 12 | 11,5 | 37,0 | 20 | 22 | 58,0 | 25 |
| 3130TR1212 | G1/2" | 12 | 15,0 | 38,5 | 24 | 22 | 70,0 | 25 |
| 3130TR1214 | G1/2" | 14 | 15,0 | 40,0 | 24 | 27 | 98,0 | 25 |
| 3130TR1215 | G1/2" | 15 | 15,0 | 40,5 | 24 | 27 | 94,0 | 25 |
| 3130TR1216 | G1/2" | 16 | 16,0 | 41,5 | 24 | 30 | 110,0 | 10 |
| 3130TR1218 | G1/2" | 18 | 16,0 | 43,0 | 24 | 32 | 134,0 | 10 |

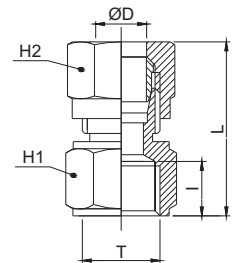

gomito maschio conico BSPT • *male elbow BSPT thread*

3140



| CODE | T | ØD | I | L1 | L2 | H1(Hex) | H2(Hex) | Peso Weight(g) | |
|------------|-------|----|------|------|------|---------|---------|----------------|-----|
| 3140TR184 | R1/8" | 4 | 8,0 | 21,0 | 16,0 | 9 | 10 | 14,0 | 100 |
| 3140TR186 | R1/8" | 6 | 8,0 | 22,0 | 16,0 | 9 | 12 | 16,0 | 100 |
| 3140TR146 | R1/4" | 6 | 11,0 | 24,5 | 20,0 | 11 | 12 | 24,0 | 100 |
| 3140TR188 | R1/8" | 8 | 8,0 | 24,0 | 17,0 | 11 | 14 | 22,0 | 100 |
| 3140TR148 | R1/4" | 8 | 11,0 | 24,0 | 20,0 | 11 | 14 | 26,0 | 50 |
| 3140TR388 | R3/8" | 8 | 11,5 | 27,0 | 24,0 | 13 | 14 | 36,0 | 50 |
| 3140TR1410 | R1/4" | 10 | 11,0 | 32,0 | 23,5 | 13 | 19 | 48,0 | 50 |
| 3140TR3810 | R3/8" | 10 | 11,5 | 32,0 | 24,0 | 13 | 19 | 52,0 | 25 |
| 3140TR1210 | R1/2" | 10 | 14,0 | 34,0 | 28,5 | 15 | 19 | 66,0 | 25 |
| 3140TR3812 | R3/8" | 12 | 11,5 | 34,5 | 25,5 | 15 | 22 | 69,0 | 25 |
| 3140TR1212 | R1/2" | 12 | 14,0 | 34,5 | 28,5 | 15 | 22 | 74,0 | 25 |
| 3140TR1214 | R1/2" | 14 | 14,0 | 38,0 | 30,0 | 17 | 27 | 106,0 | 25 |
| 3140TR1215 | R1/2" | 15 | 14,0 | 38,0 | 30,0 | 17 | 27 | 100,0 | 25 |
| 3140TR1216 | R1/2" | 16 | 14,0 | 39,5 | 31,5 | 19 | 30 | 124,0 | 10 |
| 3140TR1218 | R1/2" | 18 | 14,0 | 44,0 | 34,0 | 22 | 32 | 156,0 | 10 |

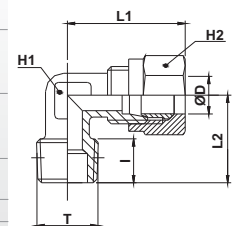

RACCORDI A COMPRESSIONE IN OTTONE • *brass compression fittings*

gomito femmina cilindrico BSPP • *female elbow BSPP thread*

3150



| CODE | T | ØD | I | L1 | L2 | H1(Hex) | H2(Hex) | Peso Weight(g) | |
|-----------|-------|----|------|------|------|---------|---------|----------------|----|
| 3150TR184 | G1/8" | 4 | 8,0 | 22,0 | 20,0 | 9 | 10 | 18,0 | 50 |
| 3150TR186 | G1/8" | | 8,0 | 24,0 | 20,0 | 9 | 12 | 20,0 | 50 |
| 3150TR146 | G1/4" | 6 | 11,0 | 27,0 | 25,5 | 13 | 12 | 39,0 | 50 |
| 3150TR188 | G1/8" | 8 | 8,0 | 24,0 | 20,0 | 11 | 14 | 26,0 | 50 |
| 3150TR148 | G1/4" | | 11,0 | 27,5 | 25,5 | 13 | 14 | 40,0 | 50 |

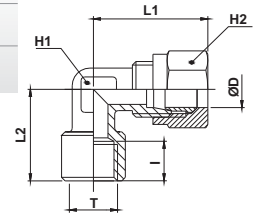

T maschio conico BSPT • *male tee BSPT thread*

3160



| CODE | T | ØD | I | L1 | L2 | H1(Hex) | H2(Hex) | Peso Weight(g) | |
|------------|-------|----|------|------|------|---------|---------|----------------|-----|
| 3160TR184 | R1/8" | 4 | 8,0 | 42,0 | 16,0 | 9 | 10 | 22,0 | 100 |
| 3160TR186 | R1/8" | | 8,0 | 46,0 | 16,0 | 9 | 12 | 26,0 | 50 |
| 3160TR146 | R1/4" | 6 | 11,0 | 48,0 | 20,0 | 11 | 12 | 34,0 | 50 |
| 3160TR188 | R1/8" | 8 | 8,0 | 48,0 | 17,0 | 11 | 14 | 34,0 | 50 |
| 3160TR148 | R1/4" | | 11,0 | 48,0 | 20,0 | 11 | 14 | 38,0 | 50 |
| 3160TR388 | R3/8" | | 11,5 | 54,0 | 24,0 | 13 | 14 | 52,0 | 25 |
| 3160TR1410 | R1/4" | 10 | 11,0 | 64,0 | 23,5 | 13 | 19 | 80,0 | 25 |
| 3160TR3810 | R3/8" | | 11,5 | 64,0 | 24,0 | 13 | 19 | 84,0 | 25 |
| 3160TR3812 | R3/8" | | 11,5 | 69,0 | 25,5 | 15 | 22 | 108,0 | 25 |
| 3160TR1212 | R1/2" | 12 | 14,0 | 69,0 | 28,5 | 15 | 22 | 118,0 | 25 |
| 3160TR1214 | R1/2" | 14 | 14,0 | 76,0 | 30,0 | 17 | 27 | 176,0 | 25 |
| 3160TR1215 | R1/2" | 15 | 14,0 | 76,0 | 30,0 | 17 | 27 | 170,0 | 25 |
| 3160TR1216 | R1/2" | 16 | 14,0 | 79,0 | 31,5 | 19 | 30 | 212,0 | 10 |
| 3160TR1218 | R1/2" | 18 | 14,0 | 88,0 | 34,0 | 22 | 32 | 256,0 | 10 |

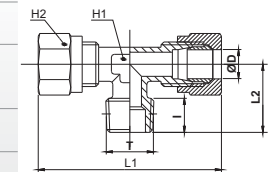

T laterale maschio conico BSPT • *lateral male tee BSPT thread*

3170



| CODE | T | ØD | I | L1 | L2 | L3 | H1(Hex) | H2(Hex) | Peso Weight(g) | |
|------------|-------|----|------|------|------|------|---------|---------|----------------|-----|
| 3170TR184 | R1/8" | 4 | 8,0 | 37,0 | 16,0 | 21,0 | 9 | 10 | 22,0 | 100 |
| 3170TR186 | R1/8" | | 8,0 | 39,0 | 16,0 | 23,0 | 9 | 10 | 26,0 | 50 |
| 3170TR146 | R1/4" | 6 | 11,0 | 44,5 | 20,0 | 24,5 | 11 | 12 | 34,0 | 50 |
| 3170TR188 | R1/8" | 8 | 8,0 | 41,0 | 17,0 | 24,0 | 11 | 14 | 34,0 | 50 |
| 3170TR148 | R1/4" | | 11,0 | 44,0 | 20,0 | 24,0 | 11 | 14 | 38,0 | 50 |
| 3170TR388 | R3/8" | | 11,5 | 51,0 | 24,0 | 27,0 | 13 | 14 | 52,0 | 25 |
| 3170TR1410 | R1/4" | 10 | 11,0 | 55,5 | 23,5 | 32,0 | 13 | 19 | 80,0 | 25 |
| 3170TR3810 | R3/8" | | 11,5 | 56,0 | 24,0 | 32,0 | 13 | 19 | 84,0 | 25 |
| 3170TR3812 | R3/8" | | 11,5 | 60,0 | 25,5 | 34,5 | 15 | 22 | 110,0 | 25 |
| 3170TR1212 | R1/2" | 12 | 14,0 | 63,0 | 28,5 | 34,5 | 15 | 22 | 118,0 | 25 |
| 3170TR1214 | R1/2" | 14 | 14,0 | 68,0 | 30,0 | 38,0 | 17 | 27 | 176,0 | 25 |
| 3170TR1215 | R1/2" | 15 | 14,0 | 68,0 | 30,0 | 38,0 | 17 | 27 | 170,0 | 25 |
| 3170TR1216 | R1/2" | 16 | 14,0 | 71,0 | 31,5 | 39,5 | 19 | 30 | 210,0 | 10 |
| 3170TR1218 | R1/2" | 18 | 14,0 | 78,0 | 34,0 | 44,0 | 22 | 32 | 256,0 | 10 |

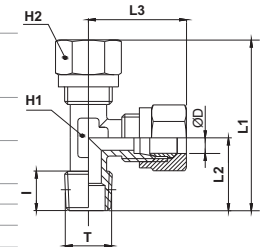

diritto intermedio • *union connector*

3180



| CODE | ØD | L | H1(Hex) | H2(Hex) | Peso Weight(g) | |
|----------|----|------|---------|---------|----------------|-----|
| 3180TR4 | 4 | 33,5 | 10 | 10 | 16,0 | 100 |
| 3180TR6 | 6 | 36,5 | 12 | 12 | 25,0 | 100 |
| 3180TR8 | 8 | 38,5 | 14 | 14 | 28,0 | 100 |
| 3180TR10 | 10 | 47,5 | 17 | 19 | 66,0 | 50 |
| 3180TR12 | 12 | 50,5 | 19 | 22 | 93,0 | 25 |
| 3180TR14 | 14 | 55,5 | 24 | 27 | 148,0 | 25 |
| 3180TR15 | 15 | 55,5 | 24 | 27 | 140,0 | 25 |
| 3180TR16 | 16 | 58,0 | 24 | 30 | 177,0 | 10 |
| 3180TR18 | 18 | 60,0 | 26 | 32 | 198,0 | 10 |

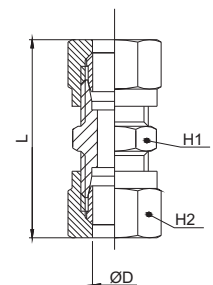

RACCORDI A COMPRESSIONE IN OTTONE • *brass compression fittings*

passaparete • *bulkhead connector*

3190



| CODE | ØD | A max | L | H1(Hex) | H2(Hex) | Peso Weight(g) | |
|----------|----|-------|------|---------|---------|----------------|-----|
| 3190TR6 | 6 | 15,5 | 51,5 | 14 | 12 | 32,0 | 100 |
| 3190TR8 | 8 | 16,5 | 55,5 | 16 | 14 | 42,0 | 100 |
| 3190TR10 | 10 | 15,5 | 62,5 | 19 | 19 | 90,0 | 50 |
| 3190TR12 | 12 | 16,0 | 64,5 | 22 | 22 | 116,0 | 25 |
| 3190TR14 | 14 | 18,0 | 69,5 | 25 | 27 | 192,0 | 25 |
| 3190TR15 | 15 | 18,0 | 69,5 | 25 | 27 | 184,0 | 25 |

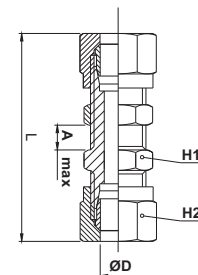

gomito intermedio • *union elbow*

3200



| CODE | ØD | L1 | L2 | H1(Hex) | H2(Hex) | Peso Weight(g) | |
|----------|----|------|------|---------|---------|----------------|-----|
| 3200TR4 | 4 | 21,0 | 21,0 | 9 | 10 | 18,0 | 100 |
| 3200TR6 | 6 | 23,0 | 23,0 | 9 | 12 | 22,0 | 100 |
| 3200TR8 | 8 | 24,0 | 24,0 | 11 | 14 | 30,0 | 50 |
| 3200TR10 | 10 | 32,0 | 32,0 | 13 | 19 | 70,0 | 25 |
| 3200TR12 | 12 | 34,5 | 34,5 | 15 | 22 | 94,0 | 25 |
| 3200TR14 | 14 | 38,0 | 38,0 | 17 | 27 | 152,0 | 25 |
| 3200TR15 | 15 | 38,0 | 38,0 | 17 | 27 | 144,0 | 25 |
| 3200TR16 | 16 | 39,5 | 39,5 | 19 | 30 | 186,0 | 10 |
| 3200TR18 | 18 | 44,0 | 44,0 | 22 | 32 | 228,0 | 10 |

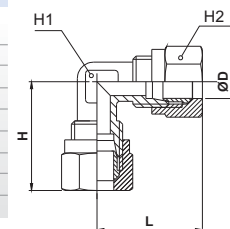

T intermedio • *union tee*

3210



| CODE | ØD | L1 | L2 | H1(Hex) | H2(Hex) | Peso Weight(g) | |
|----------|----|------|------|---------|---------|----------------|----|
| 3210TR4 | 4 | 42,0 | 21,0 | 9 | 10 | 26,0 | 50 |
| 3210TR6 | 6 | 46,0 | 23,0 | 9 | 12 | 30,0 | 50 |
| 3210TR8 | 8 | 48,0 | 24,0 | 11 | 14 | 42,0 | 25 |
| 3210TR10 | 10 | 64,0 | 32,0 | 13 | 19 | 102,0 | 25 |
| 3210TR12 | 12 | 69,0 | 34,5 | 15 | 22 | 136,0 | 25 |
| 3210TR14 | 14 | 76,0 | 38,0 | 17 | 27 | 226,0 | 10 |
| 3210TR15 | 15 | 76,0 | 38,0 | 17 | 27 | 208,0 | 10 |
| 3210TR16 | 16 | 79,0 | 39,5 | 19 | 30 | 272,0 | 10 |
| 3210TR18 | 18 | 88,0 | 44,0 | 22 | 32 | 330,0 | 10 |

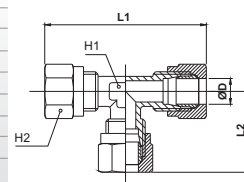

dado di bloccaggio • *locking nut*

3230



| CODE | T | ØD | I | L | H(Hex) | Peso Weight(g) | |
|---------------|---------|----|------|------|--------|----------------|-----|
| 3230TRM814 | M8x1 | 4 | 7,5 | 11,0 | 10 | 4,2 | 100 |
| 3230TRM1016 | M10x1 | 6 | 8,5 | 11,5 | 12 | 5,4 | 100 |
| 3230TRM1218 | M12x1 | 8 | 9,0 | 12,0 | 14 | 7,0 | 100 |
| 3230TRM161510 | M16x1,5 | 10 | 11,5 | 15,5 | 19 | 18,2 | 100 |
| 3230TRM181512 | M18x1,5 | 12 | 11,5 | 15,5 | 22 | 25,0 | 100 |
| 3230TRM221514 | M22x1,5 | 14 | 12,0 | 17,5 | 27 | 44,3 | 50 |
| 3230TRM221515 | M22x1,5 | 15 | 12,0 | 17,0 | 27 | 41,1 | 50 |
| 3230TRM241516 | M24x1,5 | 16 | 12,0 | 17,5 | 30 | 55,6 | 50 |
| 3230TRM261518 | M26x1,5 | 18 | 12,5 | 18,5 | 32 | 64,2 | 50 |

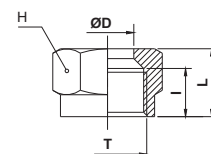

ogiva • *ogive*

3240



| CODE | ØD1 | ØD2 | L | Peso Weight(g) | |
|----------|-----|-----|------|----------------|-----|
| 3240TR4 | 4 | 6 | 6,0 | 0,45 | 100 |
| 3240TR6 | 6 | 8 | 7,0 | 0,82 | 100 |
| 3240TR8 | 8 | 10 | 7,0 | 1,12 | 100 |
| 3240TR10 | 10 | 13 | 10,0 | 3,32 | 100 |
| 3240TR12 | 12 | 15 | 10,0 | 3,80 | 100 |
| 3240TR14 | 14 | 17 | 10,0 | 4,40 | 100 |
| 3240TR15 | 15 | 18 | 10,0 | 4,76 | 50 |
| 3240TR16 | 16 | 19 | 10,0 | 5,04 | 50 |
| 3240TR18 | 18 | 21 | 10,5 | 5,92 | 50 |

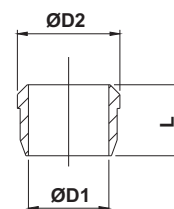

anima di rinforzo • *internal support bush*

3250



| CODE | Tubo OD Tube OD | D1 | D2 | L | Peso Weight(g) | |
|----------|-----------------|------|------|------|----------------|-----|
| 3250TR4 | 4 | 2,5 | 3,5 | 10,0 | 0,20 | 100 |
| 3250TR6 | 6 | 4,0 | 5,5 | 12,0 | 0,60 | 100 |
| 3250TR8 | 8 | 6,0 | 7,5 | 13,0 | 1,00 | 100 |
| 3250TR10 | 10 | 8,0 | 9,5 | 14,0 | 1,40 | 100 |
| 3250TR12 | 12 | 10,0 | 11,5 | 16,0 | 2,20 | 100 |
| 3250TR14 | 14 | 12,0 | 13,5 | 16,0 | 2,60 | 100 |
| 3250TR15 | 15 | 12,5 | 14,5 | 17,0 | 2,80 | 100 |
| 3250TR16 | 16 | 14,0 | 15,5 | 18,0 | 3,40 | 100 |

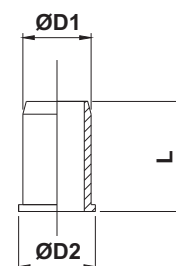

2610



rondella nylon dentellata
nylon notched washer

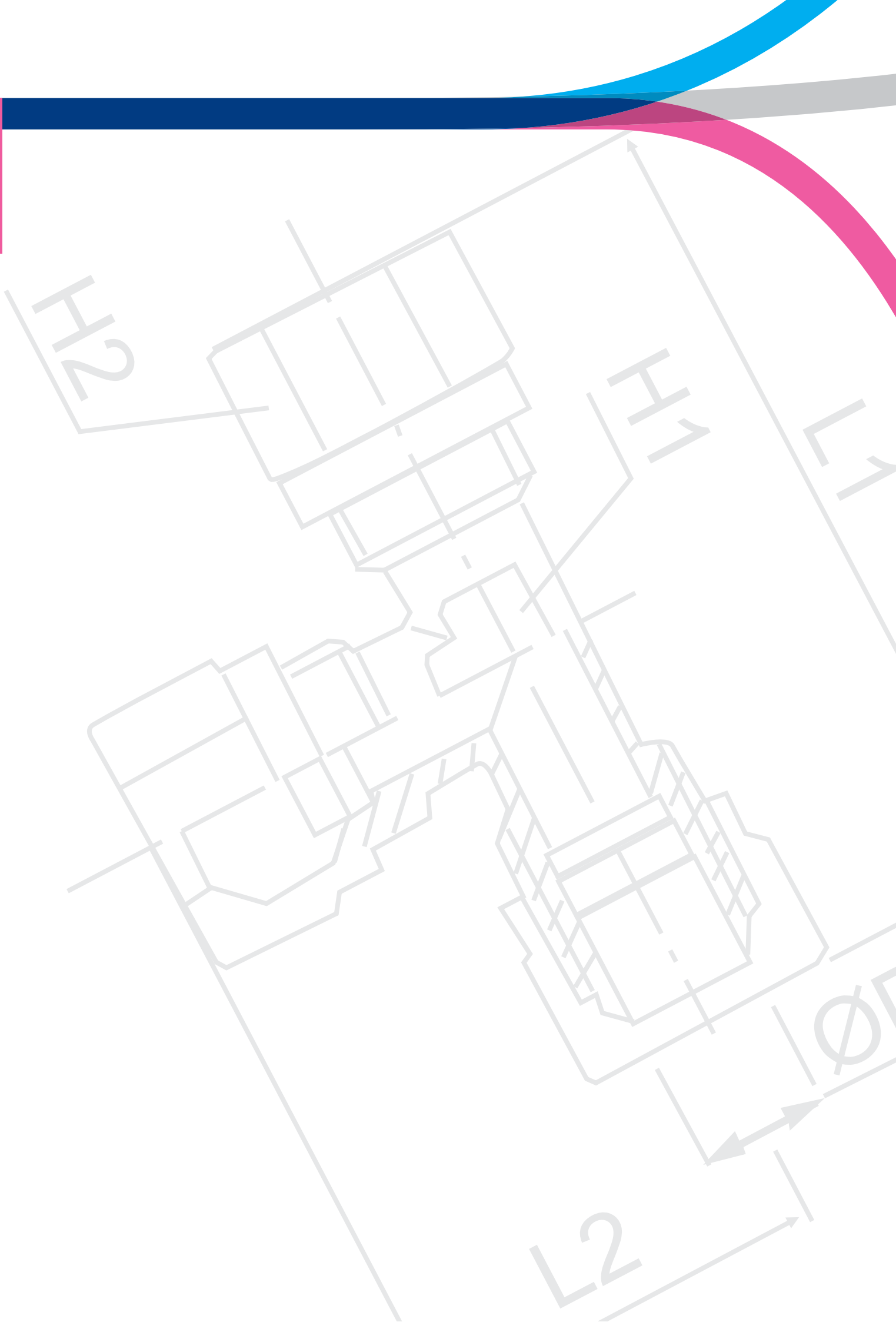

RACCORDI A COMPRESSIONE INOX AISI 316 DIN 2353

compression fittings INOX AISI 316 DIN 2353

LEGENDA CODICE • Model designation

3720

 ↓
 Codice
code

TRL

 ↓
 Pressione d'esercizio massima
maximum working pressure

| PN | |
|------|---------|
| TRLL | 100 Bar |
| TRL | 250 Bar |
| TRS | 400 Bar |

18

 ↓
 Filetto
thread size

| Conico BSPT BSPT thread | |
|----------------------------|--------|
| 18 | R 1/8" |
| 14 | R 1/4" |
| 38 | R 3/8" |
| 12 | R 1/2" |

| Cilindrico BSPP BSPP thread | |
|--------------------------------|--------|
| 18 | G 1/8" |
| 14 | G 1/4" |
| 38 | G 3/8" |
| 12 | G 1/2" |
| 34 | G 3/4" |

6

 ↓
 Diametro Tubo
tube diameter

| Codice code | Misura size |
|----------------|----------------|
| 6 | 6mm |
| 8 | 8mm |
| 10 | 10mm |
| 12 | 12mm |
| 15 | 15mm |
| 16 | 16mm |



DATI TECNICI

| | |
|----------------------------------|--|
| Fluidi compatibili | Aria compressa, acqua, olio, prodotti chimici e fluidi aggressivi compatibili con i materiali costruttivi. I raccordi sono studiati e realizzati rispettando la normativa DIN 2353 |
| Materiali costruttivi | Corpo e Ogiva: acciaio inox AISI 316 |
| Filettature | Dado: acciaio inox AISI 316 - filettatura argentata Gas Conica BSPT DIN 2999 da R1/8" a R1/2" Gas Cilindrica BSPP DIN-ISO 228 (DIN 259) da G1/8" a G3/4" |
| Pressione d'esercizio max | TRLL: 100 Bar - TRL: 250 Bar - TRS: 400 Bar |
| Temperatura d'esercizio | da -60°C a +400°C |
| Tubi utilizzabili | Acciaio INOX temprato senza saldature secondo la norma DIN 2391. I tubi devono essere compatibili con il fluido di processo, la pressione e la temperatura relativa. |

Technical specifications

| | |
|-------------------------------|---|
| fluid types | compressed air, water, oil, chemical products and aggressive fluids suitable with construction materials. The fittings are designed and manufactured in compliance with DIN 2353. |
| construction materials | body and ogive: stainless steel AISI 316 nut: stainless steel AISI 316 - silver thread |
| threads | taper gas BSPT DIN 2999 from R1/8" to R1/2" parallel gas BSPP DIN-ISO 228 (DIN 259) from G1/8" to G3/4" |
| max working pressure | TRLL: 100 Bar - TRL: 250 Bar - TRS: 400 Bar |
| working temperature | from -60°C to +400°C |
| tubes used | Stainless steel annealed seamless tubing according to DIN 2391 regulation. The tubes should be suitable with process fluid, pressure and temperature. |

 Prodotti conformi alla direttiva 2002/95/EC **RoHS**

Prodotti conformi alla direttiva 1907/2006

 products in compliance with the directive 2002/95/EC **RoHS**

products in compliance with the directive 1907/2006



**Tutti i raccordi sono disponibili su richiesta anche per tubi con diametro:
18mm, 20mm, 22mm, 25mm, 28mm, 30mm, 35mm, 38mm e 42mm**

**All fittings are available on demand also for the following tube diameters:
18mm, 20mm, 22mm, 25mm, 28mm, 30mm, 35mm, 38mm e 42mm**

I dati tecnici e le quote non sono vincolanti • drawings and technical data are not binding

RACCORDI A COMPRESSIONE INOX AISI 316 DIN 2353

compression fittings INOX AISI 316 DIN 2353

AISI 316



ISTRUZIONI PER IL CORRETTO ASSEMBLAGGIO DEI RACCORDI instruction for right fittings assembly

- Assicurarsi che il tubo abbia un taglio a 90° con una tolleranza di +/- 1/2° rispetto all'asse del tubo stesso.
Ensure that the tube end is cut at 90° with an angular maximum offset of +/- 1/2° in relation to the tube axis.

- Dopo aver pulito il tubo ed aver eliminato eventuali bave, smussare leggermente le estremità interna ed esterna dello stesso.
After clean, lightly deburr tube ends at the inside and outside edge.

- Lubrificare il filetto e la parte interna del raccordo, l'ogiva ed il filetto del dado. Non utilizzare grasso.
Lubricate the thread and the inside part of the fitting body, the ring and the thread of the nut. Don't use grease.

- Calzare il dado e l'ogiva sul tubo da inserire ed assicurarsi che siano nel giusto verso.
Place nut and cutting ring on the tube. Ensure that cutting ring and nut are facing the right way.

- Avvitare il dado manualmente sul raccordo assicurandosi che il tubo rimanga in posizione di completo inserimento.
Manually screw the nut on to the fitting body keeping the tube completely inserted in.

- Eseguire il serraggio finale stringendo il dado per 1 giro e 1/2 tenendo fermo il raccordo con una chiave e facendo girare il solo dado con una seconda chiave. Non girare mai il raccordo, agire esclusivamente sul dado.

- *Finally tighten the nut using a wrench for 1 and 1/2 turns by holding the fitting body with a second wrench. Never turn the fitting body, hold the body and turn the nut.*

ATTENZIONE: Il serraggio non completo (meno di 1 giro e 1/2) riduce la pressione massima e la vita utile del raccordo e potrebbe provocare perdite o sfilamento del tubo.

WARNING: Any deviation in the number of tightening turns reduces the maximum pressure and the service life of the fitting and may cause leakages or slipping of the tube.

- Verificare che la parte di taglio dell'ogiva sia penetrata correttamente nella superficie del tubo. Un riporto visibile di materiale dovrebbe presentarsi prima dell'anello di taglio. L'ogiva potrebbe ruotare sul tubo ma non dovrebbe potersi muovere in senso assiale.

Check penetration of cutting edge. A visible ring of material should fill the space in front of the cutting ring and face. Cutting ring may turn on tube but should not be capable of axial displacement.

- Stringere nuovamente il dado sul raccordo sino al completo serraggio.

Tighten the nut again on to fitting body until a sharp condition rise in torque is felt.

- La lunghezza minima del tratto rettilineo di tubo prima di eventuali curve deve essere almeno pari a due volte l'altezza del dado.

Minimum length of straight tube and for tube bends, up to start of the bending radius must be at least twice the net length (H).

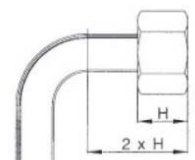
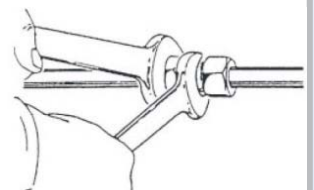
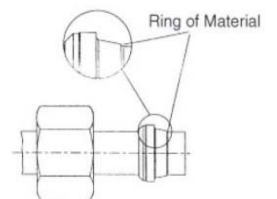
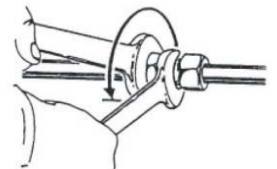
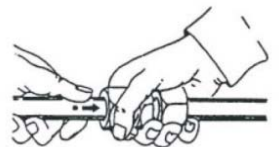
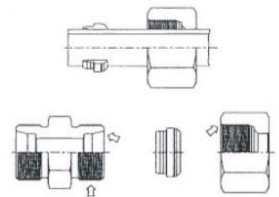
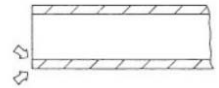
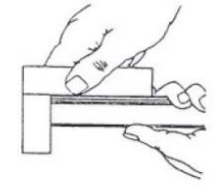

diritto maschio conico BSPT • male connector BSPT thread

3700



| | CODE | T | ØO.D. | I | L1 | L2 | H1(Hex) | H2(Hex) | Peso Weight(g) | |
|-----|-------------|-------|-------|------|------|------|---------|---------|----------------|---|
| NEW | 3700TRLL184 | R1/8" | 4 | 8,0 | 26,0 | 16,0 | 11,0 | 10,0 | 19,0 | 1 |
| | 3700TRL186 | R1/4" | 6 | 8,0 | 30,0 | 15,0 | 12,0 | 14,0 | 22,0 | 1 |
| NEW | 3700TRLL188 | R1/8" | 8 | 8,0 | 28,0 | 16,5 | 12,0 | 14,0 | 33,0 | 1 |
| | 3700TRL148 | R1/4" | 8 | 12,0 | 35,0 | 20,0 | 17,0 | 17,0 | 38,0 | 1 |
| | 3700TRL1410 | R1/4" | 10 | 12,0 | 36,0 | 21,0 | 17,0 | 19,0 | 43,0 | 1 |
| | 3700TRL1412 | R1/4" | 10 | 12,0 | 37,0 | 22,0 | 19,0 | 22,0 | 56,0 | 1 |
| NEW | 3700TRL3812 | R3/8" | 12 | 12,0 | 37,0 | 22,0 | 19,0 | 22,0 | 71,0 | 1 |
| NEW | 3700TRL1212 | R1/2" | 12 | 14,0 | 39,0 | 24,0 | 24,0 | 22,0 | 82,0 | 1 |
| | 3700TRL3815 | R3/8" | 15 | 12,0 | 38,0 | 23,0 | 24,0 | 27,0 | 96,0 | 1 |
| | 3700TRL1215 | R1/2" | 15 | 14,0 | 40,0 | 25,0 | 24,0 | 27,0 | 103,0 | 1 |

AISI 316

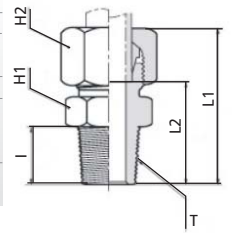

diritto maschio cilindrico BSPP • male connector BSPP thread

3720



| | CODE | T | ØO.D. | L1 | L2 | I | ØP | H1(Hex) | H2(Hex) | Peso Weight(g) | |
|-----|-------------|-------|-------|------|------|------|------|---------|---------|----------------|---|
| | 3720TRL186 | G1/8" | 6 | 23,0 | 8,5 | 8,0 | 14,0 | 14 | 14 | 25,0 | 1 |
| | 3720TRL146 | G1/4" | 6 | 25,0 | 10,0 | 12,0 | 18,0 | 19 | 14 | 35,0 | 1 |
| | 3720TRL386 | G3/8" | 6 | 26,0 | 11,5 | 12,0 | 22,0 | 22 | 14 | 56,0 | 1 |
| | 3720TRL126 | G1/2" | 8 | 27,0 | 12,0 | 14,0 | 26,0 | 27 | 14 | 73,0 | 1 |
| | 3720TRL188 | G1/8" | 8 | 23,0 | 8,5 | 8,0 | 14,0 | 14 | 17 | 31,0 | 1 |
| | 3720TRL148 | G1/4" | 8 | 25,0 | 10,0 | 12,0 | 18,0 | 19 | 17 | 43,0 | 1 |
| | 3720TRL388 | G3/8" | 8 | 26,0 | 11,5 | 12,0 | 22,0 | 22 | 17 | 60,0 | 1 |
| | 3720TRL128 | G1/2" | 10 | 27,0 | 12,0 | 14,0 | 26,0 | 27 | 17 | 90,0 | 1 |
| | 3720TRL1410 | G1/4" | 10 | 26,0 | 11,0 | 12,0 | 18,0 | 19 | 19 | 48,0 | 1 |
| | 3720TRL3810 | G3/8" | 10 | 27,0 | 12,5 | 12,0 | 22,0 | 22 | 19 | 62,0 | 1 |
| | 3720TRL1210 | G1/2" | 12 | 28,0 | 13,0 | 14,0 | 26,0 | 27 | 19 | 92,0 | 1 |
| | 3720TRL1412 | G1/4" | 12 | 27,0 | 12,0 | 12,0 | 18,0 | 19 | 22 | 58,0 | 1 |
| | 3720TRL3812 | G3/8" | 12 | 27,0 | 12,5 | 12,0 | 22,0 | 22 | 22 | 70,0 | 1 |
| | 3720TRL1212 | G1/2" | 12 | 28,0 | 13,0 | 14,0 | 26,0 | 27 | 22 | 94,0 | 1 |
| | 3720TRL3412 | G3/4" | 15 | 29,0 | 14,0 | 16,0 | 32,0 | 32 | 22 | 147,0 | 1 |
| | 3720TRL3815 | G3/8" | 15 | 29,0 | 13,5 | 12,0 | 22,0 | 24 | 27 | 97,0 | 1 |
| | 3720TRL1215 | G1/2" | 15 | 29,0 | 14,0 | 14,0 | 26,0 | 27 | 27 | 116,0 | 1 |
| | 3720TRL3415 | G3/4" | 16 | 30,0 | 15,0 | 16,0 | 32,0 | 32 | 27 | 161,0 | 1 |
| NEW | 3720TRS3816 | G3/8" | 16 | 36,0 | 18,0 | 12,0 | 22,0 | 27 | 30 | 104,0 | 1 |
| NEW | 3720TRS1216 | G1/2" | 16 | 37,0 | 18,5 | 14,0 | 26,0 | 27 | 30 | 122,0 | 1 |
| NEW | 3720TRS3416 | G3/4" | 16 | 39,0 | 20,5 | 16,0 | 32,0 | 32 | 30 | 167,0 | 1 |

AISI 316

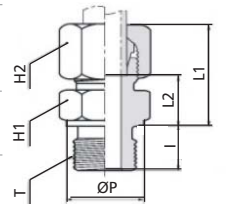

diritto femmina cilindrico BSPP • female connector BSPP thread

3730



| | CODE | T | ØO.D. | L1 | L2 | I | H1(Hex) | H2(Hex) | Peso Weight(g) | |
|-----|-------------|-------|-------|------|------|------|---------|---------|----------------|---|
| | 3730TRL186 | G1/8" | 6 | 34,0 | 19,0 | 12,0 | 14 | 14 | 29,0 | 1 |
| NEW | 3700TRS146 | G1/4" | 6 | 41,0 | 26,0 | 17,0 | 19 | 17 | 37,0 | 1 |
| | 3730TRL148 | G1/4" | 8 | 39,0 | 24,0 | 17,0 | 19 | 17 | 55,0 | 1 |
| | 3730TRL388 | G3/8" | 8 | 40,0 | 25,0 | 17,0 | 24 | 17 | 77,0 | 1 |
| | 3730TRL128 | G1/2" | 10 | 44,0 | 29,0 | 20,0 | 27 | 17 | 96,0 | 1 |
| | 3730TRL1410 | G1/4" | 10 | 40,0 | 25,0 | 17,0 | 19 | 19 | 60,0 | 1 |
| | 3730TRL3810 | G3/8" | 10 | 41,0 | 26,0 | 17,0 | 24 | 19 | 83,0 | 1 |
| | 3730TRL1210 | G1/2" | 12 | 45,0 | 30,0 | 20,0 | 27 | 19 | 100,0 | 1 |
| | 3730TRL3812 | G3/8" | 12 | 41,0 | 26,0 | 17,0 | 24 | 22 | 91,0 | 1 |
| | 3730TRL1212 | G1/2" | 12 | 45,0 | 30,0 | 20,0 | 27 | 22 | 106,0 | 1 |
| | 3730TRL1215 | G1/2" | 15 | 46,0 | 31,0 | 20,0 | 27 | 27 | 131,0 | 1 |
| NEW | 3730TRS1216 | G1/2" | 16 | 50,0 | 31,5 | 20,0 | 30 | 30 | 149,0 | 1 |

AISI 316

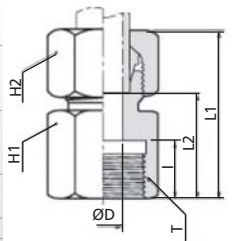

gomito maschio conico BSPT • male elbow BSPT thread

3740



| | CODE | T | ØO.D. | L1 | L2 | I | H1(Hex) | H2(Hex) | Peso Weight(g) | |
|-----|-------------|-------|-------|------|------|------|---------|---------|----------------|---|
| NEW | 3740TRLL184 | R1/8" | 4 | 21,0 | 17,0 | 11,0 | 9,0 | 10,0 | 35,0 | 1 |
| | 3740TRL186 | R1/8" | 6 | 27,0 | 20,0 | 12,0 | 12,0 | 14,0 | 40,0 | 1 |
| NEW | 3740TRS146 | R1/4" | 6 | 31,0 | 26,0 | 16,0 | 12,0 | 17,0 | 46,0 | 1 |
| NEW | 3740TRLL188 | R1/8" | 8 | 23,0 | 20,0 | 11,5 | 14,0 | 14,0 | 48,0 | 1 |
| | 3740TRL148 | R1/4" | 8 | 29,0 | 26,0 | 14,0 | 12,0 | 17,0 | 63,0 | 1 |
| | 3740TRL1410 | R1/4" | 10 | 30,0 | 27,0 | 15,0 | 14,0 | 19,0 | 81,0 | 1 |
| NEW | 3740TRS3810 | R3/8" | 10 | 34,0 | 28,0 | 17,5 | 17,0 | 22,0 | 115,0 | 1 |
| | 3740TRL3812 | R3/8" | 12 | 32,0 | 28,0 | 17,0 | 17,0 | 22,0 | 133,0 | 1 |
| | 3740TRL1215 | R1/2" | 15 | 36,0 | 34,0 | 21,0 | 19,0 | 27,0 | 139,0 | 1 |
| NEW | 3740TRS1216 | R1/2" | 16 | 43,0 | 32,0 | 24,5 | 24,0 | 30,0 | 145,0 | 1 |

AISI 316

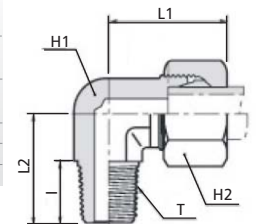

diritto intermedio • *union connector*

3780



| | CODE | ØO.D. | L | I | H1(Hex) | H2(Hex) | Peso Weight(g) | |
|------------|-----------|-------|------|------|---------|---------|----------------|---|
| NEW | 3780TRLL4 | 4 | 31,0 | 12,0 | 9,0 | 10,0 | 28,0 | 1 |
| | 3780TRL6 | 6 | 39,0 | 10,0 | 12,0 | 14,0 | 34,0 | 1 |
| | 3780TRL8 | 8 | 40,0 | 11,0 | 14,0 | 17,0 | 49,0 | 1 |
| | 3780TRL10 | 10 | 42,0 | 13,0 | 17,0 | 19,0 | 62,0 | 1 |
| | 3780TRL12 | 12 | 43,0 | 14,0 | 19,0 | 22,0 | 83,0 | 1 |
| | 3780TRL15 | 15 | 46,0 | 16,0 | 24,0 | 27,0 | 137,0 | 1 |
| NEW | 3780TRS16 | 16 | 57,0 | 21,0 | 27,0 | 30,0 | 151,0 | 1 |

AISI 316

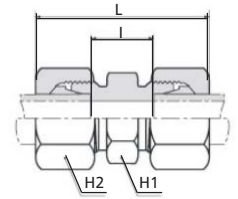

passaparete • *bulkhead connector*

3790



| | CODE | ØO.D. | L1 | L2 | I1 | I2 | H1(Hex) | H2(Hex) | H3(Hex) | Thread Bulkhead | Peso Weight(g) | |
|--|-----------|-------|------|------|------|------|---------|---------|---------|-----------------|----------------|---|
| | 3790TRL6 | 6 | 42,0 | 22,0 | 27,0 | 7,0 | 14,0 | 17,0 | 17,0 | M12x1,5 | 60,0 | 1 |
| | 3790TRL8 | 8 | 42,0 | 23,0 | 27,0 | 8,0 | 17,0 | 19,0 | 19,0 | M14x1,5 | 82,0 | 1 |
| | 3790TRL10 | 10 | 43,0 | 25,0 | 28,0 | 10,0 | 19,0 | 22,0 | 22,0 | M16x1,5 | 106,0 | 1 |
| | 3790TRL12 | 12 | 44,0 | 25,0 | 29,0 | 10,0 | 22,0 | 24,0 | 24,0 | M18x1,5 | 133,0 | 1 |
| | 3790TRL15 | 15 | 46,0 | 27,0 | 31,0 | 12,0 | 27,0 | 30,0 | 27,0 | M22x1,5 | 216,0 | 1 |

AISI 316

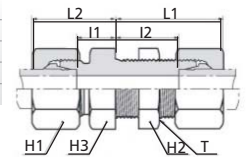

gomito intermedio • *union elbow*

3800



| | CODE | ØO.D. | L | I | H1(Hex) | H2(Hex) | Peso Weight(g) | |
|------------|-----------|-------|------|------|---------|---------|----------------|---|
| NEW | 3800TRLL4 | 4 | 21,0 | 11,0 | 9,0 | 10,0 | 44,0 | 1 |
| | 3800TRL6 | 6 | 27,0 | 12,0 | 12,0 | 14,0 | 51,0 | 1 |
| | 3800TRL8 | 8 | 29,0 | 14,0 | 12,0 | 17,0 | 75,0 | 1 |
| | 3800TRL10 | 10 | 30,0 | 15,0 | 14,0 | 19,0 | 98,0 | 1 |
| | 3800TRL12 | 12 | 32,0 | 17,0 | 17,0 | 22,0 | 134,0 | 1 |
| | 3800TRL15 | 15 | 36,0 | 21,0 | 19,0 | 27,0 | 230,0 | 1 |
| NEW | 3800TRS16 | 16 | 43,0 | 24,5 | 24,0 | 30,0 | 246,0 | 1 |

AISI 316

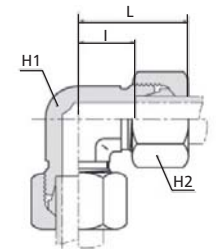

T intermedio • *union tee*

3810



| | CODE | ØO.D. | L | I | H1(Hex) | H2(Hex) | Peso Weight(g) | |
|------------|-----------|-------|------|------|---------|---------|----------------|---|
| NEW | 3810TRLL4 | 4 | 21,0 | 11,0 | 9,0 | 10,0 | 62,0 | 1 |
| | 3810TRL6 | 6 | 27,0 | 12,0 | 12,0 | 14,0 | 71,0 | 1 |
| | 3810TRL8 | 8 | 29,0 | 14,0 | 12,0 | 17,0 | 101,0 | 1 |
| | 3810TRL10 | 10 | 30,0 | 15,0 | 14,0 | 19,0 | 128,0 | 1 |
| | 3810TRL12 | 12 | 32,0 | 17,0 | 17,0 | 22,0 | 170,0 | 1 |
| | 3810TRL15 | 15 | 36,0 | 21,0 | 19,0 | 27,0 | 230,0 | 1 |
| NEW | 3810TRS16 | 16 | 43,0 | 24,5 | 24,0 | 30,0 | 261,0 | 1 |

AISI 316

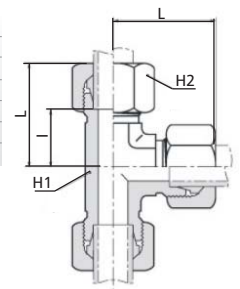

dado • *nut*

3830



| | CODE | ØO.D. | T | L | H(Hex) | Peso Weight(g) | |
|------------|-----------|-------|---------|------|--------|----------------|---|
| NEW | 3830TRLL4 | 4 | M8x1,0 | 11,5 | 10,0 | 6,0 | 1 |
| | 3830TRL6 | 6 | M12x1,5 | 15,0 | 14,0 | 9,0 | 1 |
| | 3830TRL8 | 8 | M14x1,5 | 15,0 | 17,0 | 14,0 | 1 |
| | 3830TRL10 | 10 | M16x1,5 | 16,0 | 19,0 | 17,0 | 1 |
| | 3830TRL12 | 12 | M18x1,5 | 16,0 | 22,0 | 24,0 | 1 |
| | 3830TRL15 | 15 | M22x1,5 | 17,5 | 27,0 | 40,0 | 1 |
| NEW | 3830TRS16 | 16 | M24x1,5 | 21,0 | 30,0 | 48,0 | 1 |

AISI 316

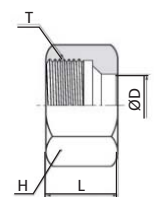

ogiva INOX AISI 316 • INOX AISI 316 ogive

3840



| | CODE | ØD | L | Peso Weight(g) | |
|------------|-----------|----|------|----------------|---|
| NEW | 3840TRLL4 | 4 | 9,0 | 2,0 | 1 |
| | 3840TRL6 | 6 | 9,5 | 2,0 | 1 |
| | 3840TRL8 | 8 | 9,5 | 2,0 | 1 |
| | 3840TRL10 | 10 | 10,0 | 3,0 | 1 |
| | 3840TRL12 | 12 | 10,0 | 3,0 | 1 |
| | 3840TRL15 | 15 | 10,5 | 4,0 | 1 |
| NEW | 3840TRS16 | 16 | 10,5 | 5,0 | 1 |

AISI 316

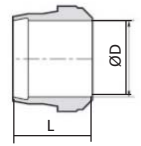

tappo femmina • female plug

3855



| | CODE | ØO.D. | L | S | H1 (Hex) | H2 (Hex) | Peso Weight(g) | |
|------------|-----------|-------|------|------|----------|----------|----------------|---|
| | 3855TRL6 | 6 | 22,0 | 7,0 | 12,0 | 14,0 | 19,0 | 1 |
| | 3855TRL8 | 8 | 23,0 | 8,0 | 14,0 | 17,0 | 28,0 | 1 |
| | 3855TRL10 | 10 | 24,0 | 9,0 | 17,0 | 19,0 | 37,0 | 1 |
| | 3855TRL12 | 12 | 25,0 | 10,0 | 19,0 | 22,0 | 50,0 | 1 |
| | 3855TRL15 | 15 | 26,0 | 11,0 | 24,0 | 27,0 | 82,0 | 1 |
| NEW | 3855TRS16 | 16 | 34,0 | 15,5 | 27,0 | 30,0 | 108,0 | 1 |

AISI 316

