

**NEW**

# RACCORDI A COMPRESSIONE IN OTTONE GIALLO

## yellow brass compression fittings

### LEGENDA CODICE • Model designation

3400TR

↓  
Codice  
code

18

↓  
Filetto  
thread size

6

↓  
Diametro Tubo  
tube diameter

Conico BSPT BSPT thread		Cilindrico BSPP BSPP thread	
18	R1/8"	18	G1/8"
14	R1/4"	14	G1/4"
38	R3/8"	38	G3/8"
12	R1/2"	12	G1/2"
34	R3/4"	34	G3/4"
1	R1"	1	G1"

Codice code	Misura size
6	6mm
8	8mm
10	10mm
14	14mm
16	16mm
18	18mm
22	22mm



### DATI TECNICI

<b>Fluidi compatibili</b>	Aria compressa, acqua, gasolio per riscaldamento domestico, idrocarburi e fluidi compatibili con i materiali costruttivi.																
<b>Materiali utilizzati</b>	Ottone giallo UNI EN 12164 CW 614N Ottone giallo UNI EN 12164 CW 617N																
<b>Filettature</b>	Gas Conica BSPT da R1/8" a R1" Gas Cilindrica BSPP da G1/8" a G1"																
<b>Pressione d'esercizio</b>	da 60 a 100 Bar a seconda del tubo utilizzato e della temperatura d'esercizio. Contattare l'Ufficio Tecnico Tierre Group per maggiori informazioni																
<b>Temperatura consigliata</b>	da -40°C a +70°C																
<b>Tubi da utilizzare</b>	Tubi metallici: ottone, rame Tubo autoserrante AS (da utilizzare con ns. articoli 3467 - 3468)																
<b>Montaggio</b>	- Tagliare il tubo ed eliminare bave interne ed esterne - Inserire il dado nel tubo e lubrificare il filetto - Montare l'ogiva sulla parte finale del tubo - Spingere il tubo fino alla battuta all'interno del raccordo - Avvitare il dado lubrificato fino ad avere il tubo fissato grazie al grip dell'ogiva																
<b>Coppia di serraggio</b>	<table border="0"> <thead> <tr> <th>Diametro</th> <th>Kg/m</th> </tr> </thead> <tbody> <tr> <td>Ø6</td> <td>1,6</td> </tr> <tr> <td>Ø8</td> <td>1,6</td> </tr> <tr> <td>Ø10</td> <td>1,9</td> </tr> <tr> <td>Ø14</td> <td>3,5</td> </tr> <tr> <td>Ø16</td> <td>5,0</td> </tr> <tr> <td>Ø18</td> <td>6,0</td> </tr> <tr> <td>Ø22</td> <td>7,0</td> </tr> </tbody> </table>	Diametro	Kg/m	Ø6	1,6	Ø8	1,6	Ø10	1,9	Ø14	3,5	Ø16	5,0	Ø18	6,0	Ø22	7,0
Diametro	Kg/m																
Ø6	1,6																
Ø8	1,6																
Ø10	1,9																
Ø14	3,5																
Ø16	5,0																
Ø18	6,0																
Ø22	7,0																

### Technical specifications

<b>fluid types</b>	compressed air, water, diesel for domestic heating, hydrocarbons and fluids suitable with construction materials																
<b>construction materials</b>	yellow brass UNI EN 12164 CW 614N yellow brass UNI EN 12164 CW 617N																
<b>threads</b>	taper gas BSPT from R1/8" to R1" parallel gas BSPP from G1/8" to G1"																
<b>working pressure</b>	from 60 Bar to 100 Bar depending on the tube used and on the working temperature. Ask to Tierre Group technical dept for more information																
<b>temperature suggested</b>	from -40°C to +70°C																
<b>tubes used</b>	metal tubes: brass, copper self fastening tube AS (to be used with our 3467 and 3468)																
<b>assembly</b>	- Cut the tube and remove the internal and external burrs - Insert the nut into the tube and lubricate the thread insert - Put the ogive on the final part of the tube - Push the tube until it is stopped into the fitting - Screw the lubricated nut in order to obtain the tube secured thanks to the grip of the ogive																
<b>tightening torque</b>	<table border="0"> <thead> <tr> <th>diameter</th> <th>Kg/m</th> </tr> </thead> <tbody> <tr> <td>Ø6</td> <td>1,6</td> </tr> <tr> <td>Ø8</td> <td>1,6</td> </tr> <tr> <td>Ø10</td> <td>1,9</td> </tr> <tr> <td>Ø14</td> <td>3,5</td> </tr> <tr> <td>Ø16</td> <td>5,0</td> </tr> <tr> <td>Ø18</td> <td>6,0</td> </tr> <tr> <td>Ø22</td> <td>7,0</td> </tr> </tbody> </table>	diameter	Kg/m	Ø6	1,6	Ø8	1,6	Ø10	1,9	Ø14	3,5	Ø16	5,0	Ø18	6,0	Ø22	7,0
diameter	Kg/m																
Ø6	1,6																
Ø8	1,6																
Ø10	1,9																
Ø14	3,5																
Ø16	5,0																
Ø18	6,0																
Ø22	7,0																

Prodotti conformi alla direttiva 2002/95/EC **RoHS**

Prodotti conformi alla direttiva 1907/2006 **REACH**

products in compliance with the directive 2002/95/EC **RoHS**

products in compliance with the directive 1907/2006 **REACH**

I dati tecnici e le quote non sono vincolanti • drawings and technical data are not binding

RACCORDI A COMPRESSIONE IN OTTONE GIALLO • yellow brass compression fittings

diritto maschio conico BSPT • male connector BSPT thread

3400



NEW

CODE	T	ØD	L	S	H1(Hex)	H2(Hex)	Peso Weight(g)	
3400TR186	R1/8"	6	18,0	7,5	11	13	18,0	10
3400TR146	R1/4"	6	18,0	7,5	14	13	25,0	10
3400TR188	R1/8"	8	19,5	7,0	13	14	22,0	10
3400TR148	R1/4"	8	19,5	7,0	14	14	27,0	10
3400TR388	R3/8"	8	20,5	8,0	17	14	33,0	10
3400TR1410	R1/4"	10	24,0	9,0	17	19	48,0	10
3400TR3810	R3/8"	10	24,0	9,0	17	19	49,0	10
3400TR1210	R1/2"	10	25,0	10,0	22	19	67,0	10
3400TR3814	R3/8"	14	25,0	8,0	22	24	70,0	10
3400TR1214	R1/2"	14	26,0	9,0	22	24	80,0	10
3400TR1216	R1/2"	16	27,0	9,5	24	27	101,0	10
3400TR1218	R1/2"	18	30,0	10,5	27	30	132,0	10
3400TR3418	R3/4"	18	30,0	10,5	27	30	143,0	10
3400TR3422	R3/4"	22	33,0	11,0	32	36	195,0	10
3400TR122	R1"	22	33,0	11,0	36	36	225,0	10

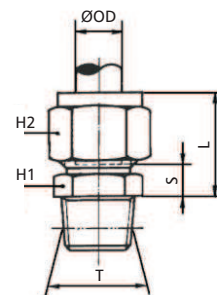

diritto femmina cilindrico BSPP • female connector BSPP thread

3430



NEW

CODE	T	ØD	I	S	L	H1(Hex)	H2(Hex)	Peso Weight(g)	
3430TR186	G1/8"	6	9,5	17,0	28	14	13	26,0	10
3430TR146	G1/4"	6	13,5	21,0	32	17	13	35,0	10
3430TR188	G1/8"	8	9,5	16,5	29	14	14	28,0	10
3430TR148	G1/4"	8	13,5	20,5	33	17	14	36,0	10
3430TR388	G3/8"	8	14,0	21,0	34	22	14	53,0	10
3430TR1410	G1/4"	10	13,5	21,5	37	17	19	52,0	10
3430TR3810	G3/8"	10	14,0	22,0	37	22	19	70,0	10
3430TR1210	G1/2"	10	18,5	26,5	42	27	19	102,0	10
3430TR3814	G3/8"	14	14,0	21,0	38	22	24	82,0	10
3430TR1214	G1/2"	14	18,5	25,5	43	27	24	113,0	10
3430TR1218	G1/2"	18	18,5	26,0	45	27	30	147,0	10
3430TR3418	G3/4"	18	19,5	27,0	46	32	30	169,0	10
3430TR3422	G3/4"	22	19,5	26,5	48	32	36	205,0	10

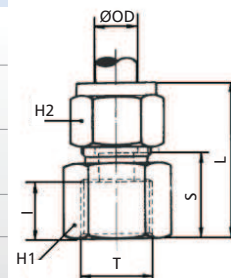

gomito maschio conico BSPT • male elbow BSPT thread

3440



NEW

CODE	T	ØD	L1	L2	S	H1(Hex)	H2(Hex)	Peso Weight(g)	
3440TR186	R1/8"	6	22,0	18,0	13,0	8	13	22,0	10
3440TR146	R1/4"	6	22,0	21,5	13,0	10	13	31,0	10
3440TR188	R1/8"	8	28,0	18,5	15,0	10	14	29,0	10
3440TR148	R1/4"	8	28,0	22,0	15,0	10	14	34,0	10
3440TR388	R3/8"	8	28,0	24,0	15,0	12	14	45,0	10
3440TR1410	R1/4"	10	30,0	25,0	17,0	12	19	53,0	10
3440TR3810	R3/8"	10	30,0	25,5	17,0	12	19	62,0	10
3440TR1210	R1/2"	10	36,0	32,0	17,0	19	19	107,0	10
3440TR3814	R3/8"	14	35,0	30,0	18,0	19	24	105,0	10
3440TR1214	R1/2"	14	35,0	32,0	18,0	19	24	109,0	10
3440TR1216	R1/2"	16	39,0	33,5	21,0	19	27	135,0	10
3440TR1218	R1/2"	18	41,0	35,5	21,5	23	30	176,0	10
3440TR3418	R3/4"	18	41,0	36,5	21,5	23	30	203,0	10
3440TR3422	R3/4"	22	50,0	40,0	25,0	27	36	296,0	10
3440TR122	R1"	22	50,0	44,0	25,0	27	36	324,0	10

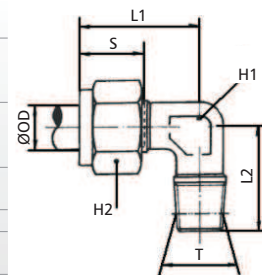

gomito maschio orientabile cilindrico BSPP • swivel male elbow BSPP thread

3442



NEW

CODE	T	ØD	L1	L2	S	H1(Hex)	H2(Hex)	Peso Weight(g)	
3442TR186	G1/8"	6	22,0	16,0	13,0	8	13	23,0	10
3442TR146	G1/4"	6	22,0	22,0	13,0	10	13	31,0	10
3442TR188	G1/8"	8	28,0	18,5	15,0	10	14	29,0	10
3442TR148	G1/4"	8	28,0	22,0	15,0	10	14	34,0	10
3442TR388	G3/8"	8	28,0	24,0	15,0	12	14	43,0	10
3442TR1410	G1/4"	10	30,0	22,0	17,0	12	19	53,0	10
3442TR3810	G3/8"	10	30,0	24,0	17,0	12	19	64,0	10
3442TR1210	G1/2"	10	30,0	29,5	17,0	19	19	102,0	10
3442TR3814	G3/8"	14	35,0	25,0	18,0	19	24	105,0	10
3442TR1214	G1/2"	14	35,0	29,5	18,0	19	24	108,0	10
3442TR1218	G1/2"	18	41,0	30,5	21,0	23	30	174,0	10
3442TR3418	G3/4"	18	41,0	32,8	21,5	23	30	202,0	10
3442TR3422	G3/4"	22	50,0	32,8	25,0	27	36	295,0	10
3442TR122	G1"	22	50,0	43,5	25,0	27	36	323,0	10

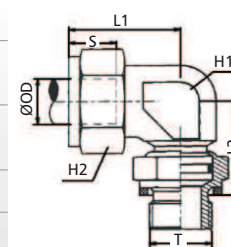

RACCORDI A COMPRESSIONE IN OTTONE GIALLO • yellow brass compression fittings

diritto intermedio • union connector

**3480**



**NEW**

CODE	ØD	S	L	H1(Hex)	H2(Hex)	Peso Weight(g)	
3480TR6	6	11,0	32,0	11	13	19,0	1
3480TR8	8	10,0	36,0	13	14	28,0	1
3480TR10	10	13,0	42,0	17	19	69,0	1
3480TR14	14	11,0	45,0	22	24	151,0	1
3480TR16	16	13,0	48,0	24	27	180,0	1
3480TR18	18	14,0	53,0	27	30	201,0	1
3480TR22	22	14,0	60,0	32	36	225,0	1

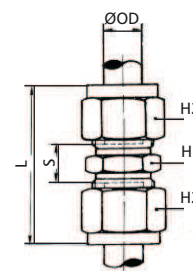

131

gomito intermedio • union elbow

**3500**



**NEW**

CODE	ØD	L	H1(Hex)	H2(Hex)	Peso Weight(g)	
3500TR6	6	22,0	8	13	26,0	10
3500TR8	8	28,0	10	14	34,0	10
3500TR10	10	30,0	12	19	74,0	10
3500TR14	14	35,0	19	24	156,0	10
3500TR16	16	39,0	19	27	190,0	10
3500TR18	18	41,0	23	30	232,0	10
3500TR22	22	50,0	27	36	254,0	10

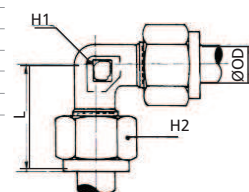

T intermedio • union tee

**3510**



**NEW**

CODE	ØD	S	L	H1(Hex)	H2(Hex)	Peso Weight(g)	
3510TR6	6	11	22	8	13	33,0	10
3510TR8	8	15	28	10	14	45,0	10
3510TR10	10	14,5	30	12	19	105,0	10
3510TR14	14	18	35	19	24	230,0	10
3510TR16	16	21	39	19	27	275,0	10
3510TR18	18	21,5	41	23	30	333,0	10
3510TR22	22	29	50	27	36	364,0	10

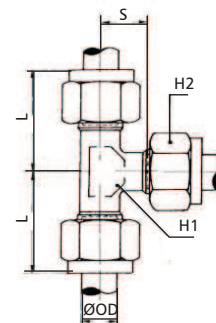

dado di bloccaggio • locking nut

**3530**



**NEW**

CODE	ØD	T	L	H (Hex)	Peso Weight(g)	
3530TR6	6	M10x1	11,0	13	5,4	10
3530TR8	8	M12x1	13,0	14	7,0	10
3530TR10	10	M16x1,5	15,0	19	18,2	10
3530TR14	14	M20x1,5	15,0	24	44,3	10
3530TR16	16	M22x1,5	17,0	27	55,6	10
3530TR18	18	M24x1,5	18,0	30	64,2	10
3530TR22	22	M30x1,5	19,0	36	76,3	10

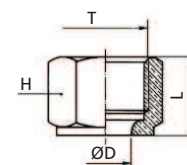

ogiva • ogive

3540



NEW

CODE	ØD	L	Peso Weight(g)	
3540TR6	6	6,5	0,82	10
3540TR8	8	7,0	1,12	10
3540TR10	10	8,0	3,30	10
3540TR14	14	8,5	4,42	10
3540TR16	16	9,0	5,00	10
3540TR18	18	9,5	5,90	10
3540TR22	22	11,0	7,10	10

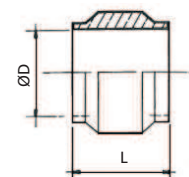

3467



portagomma maschio cilindrico BSPP • male barb connector BSPP thread

CODE	T	Ø D1	DN	L	L1	F	ØG	ØP	Peso Weight (g)	
3467TR1814	G1/8"	1/4"(6,3mm)	1/4"	31,5	20,0	13	14,0	4,0	14,0	10
3467TR1414	G1/4"	1/4"(6,3mm)	1/4"	35,0	20,0	17	14,0	4,0	26,0	10
3467TR1438	G1/4"	3/8"(9,5mm)	3/8"	39,1	24,1	17	17,0	7,5	27,0	10
3467TR3838	G3/8"	3/8"(9,5mm)	3/8"	42,5	24,1	22	17,0	7,5	47,0	10
3467TR3812	G3/8"	1/2"(12,7mm)	1/2"	46,5	28,0	22	20,5	10,0	48,0	10
3467TR1212	G1/2"	1/2"(12,7mm)	1/2"	48,5	28,0	27	20,5	10,0	79,0	10
3467TR1258	G1/2"	5/8"(15,9mm)	5/8"	56,5	36,5	27	24,0	13,5	73,0	10
3467TR3458	G3/4"	5/8"(15,9mm)	5/8"	58,5	36,5	32	24,0	13,5	117,0	10
3467TR3434	G3/4"	3/4"(19,1mm)	3/4"	65,3	43,0	32	27,0	16,0	123,0	10

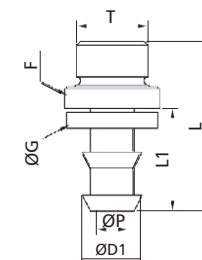

3468



portagomma femmina metrico BSPP • female barb connector BSPP thread

CODE	DN	T	Ø D1	DN	L1	L2	Ø C	E	Ø P	Peso Weight(g)	
3468TRM1014	6	M10X1	1/4"(6,3mm)	1/4"	33,5	11,0	16,5	13,0	4,0	17,0	10
3468TRM1214	8	M12X1	1/4"(6,3mm)	1/4"	34,5	13,0	16,5	14,0	4,8	18,0	10
3468TRM1614	10	M16X1,5	1/4"(6,3mm)	1/4"	35,8	15,0	16,5	19,0	4,8	33,0	10
3468TRM1638	10	M16X1,5	3/8"(9,5mm)	3/8"	39,3	15,0	19,5	19,0	7,5	35,0	10
3468TRM2038	14	M20X1,5	3/8"(9,5mm)	3/8"	39,3	15,0	19,5	24,0	7,5	52,0	10
3468TRM2012	14	M20X1,5	1/2"(12,7mm)	1/2"	44,0	15,0	23,5	24,0	10,0	56,0	10
3468TRM2212	15	M22X1,5	1/2"(12,7mm)	1/2"	45,0	17,0	23,5	27,0	10,0	77,0	10
3468TRM2412	16	M24X1,5	1/2"(12,7mm)	1/2"	47,0	18,0	23,5	30,0	10,0	99,0	10
3468TRM2458	16	M24X1,5	5/8"(15,9mm)	5/8"	55,0	18,0	27,0	30,0	13,5	97,0	10
3468TRM3034	22	M30X1,5	3/4"(19,1mm)	3/4"	62,0	18,5	30,0	36,0	16,0	137,0	10

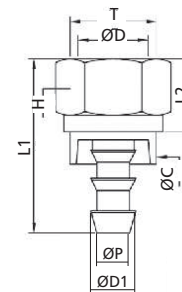

AS

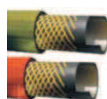

tubo autoserrante AS  
AS self fastening tube