

# INNESTI RAPIDI IN OTTONE HF CON NICHELATURA NSF

## HF brass push-in fittings NSF nickel plated



### LEGENDA CODICE • Model designation

HFC HFC HFC	04 04 04	R01 M5 G01																																				
↓ Codice Code	↓ Diametro Tubo tube diameter	↓ Filetto thread size																																				
	<table border="1"> <thead> <tr> <th>Code</th> <th>Size</th> </tr> </thead> <tbody> <tr><td>04</td><td>4mm</td></tr> <tr><td>06</td><td>6mm</td></tr> <tr><td>08</td><td>8mm</td></tr> <tr><td>10</td><td>10mm</td></tr> <tr><td>12</td><td>12mm</td></tr> </tbody> </table>	Code	Size	04	4mm	06	6mm	08	8mm	10	10mm	12	12mm	<table border="1"> <thead> <tr> <th colspan="2">Conico BSPT BSPT thread</th> </tr> </thead> <tbody> <tr><td>01</td><td>R1/8"</td></tr> <tr><td>02</td><td>R1/4"</td></tr> <tr><td>03</td><td>R3/8"</td></tr> <tr><td>04</td><td>R1/2"</td></tr> <tr> <th colspan="2">Metrico metric thread</th> </tr> <tr><td>M5</td><td>M5</td></tr> <tr> <th colspan="2">Cilindrico BSPP BSPP thread</th> </tr> <tr><td>01</td><td>G1/8"</td></tr> <tr><td>02</td><td>G1/4"</td></tr> <tr><td>03</td><td>G3/8"</td></tr> <tr><td>04</td><td>G1/2"</td></tr> </tbody> </table>	Conico BSPT BSPT thread		01	R1/8"	02	R1/4"	03	R3/8"	04	R1/2"	Metrico metric thread		M5	M5	Cilindrico BSPP BSPP thread		01	G1/8"	02	G1/4"	03	G3/8"	04	G1/2"
Code	Size																																					
04	4mm																																					
06	6mm																																					
08	8mm																																					
10	10mm																																					
12	12mm																																					
Conico BSPT BSPT thread																																						
01	R1/8"																																					
02	R1/4"																																					
03	R3/8"																																					
04	R1/2"																																					
Metrico metric thread																																						
M5	M5																																					
Cilindrico BSPP BSPP thread																																						
01	G1/8"																																					
02	G1/4"																																					
03	G3/8"																																					
04	G1/2"																																					

### TOLLERANZA DIAMETRO ESTERNO TUBO • Outer diameter tube tolerance

Tubo • tube	Ø 4mm	Ø 6mm	Ø 8mm	Ø 10mm	Ø 12mm
Tolleranza tubo PA tolerance tube PA	± 0,1				
Tolleranza tubo PTFE-C tolerance tube PTFE-C	± 0,1				
Tolleranza tubo FEP tolerance tube FEP	± 0,1		-	-	-

### PRESSIONE D'ESERCIZIO • Working pressure

Misure • sizes	Ø 4mm	Ø 6mm	Ø 8mm	Ø 10mm	Ø 12mm
Temperatura - Temperature					
Fino a 50°C - up to 50°C	15 Bar			10 Bar	
Oltre i 50°C • over 50°C	da verificare con l'Ufficio Tecnico in base al tipo di utilizzo e al fluido utilizzato to check with our Technical Department according to the application & fluid used				

### DATI TECNICI

Applicazioni	Pneumatica & Fluidi, Applicazioni Industriali & Alimentari
Materiali utilizzati	Corpo: ottone nichelato UNI EN 12164 CW 614N e UNI EN 12164 CW 617N nichelato chimicamente secondo lo standard NSF food program Colletto: ottone nichelato UNI EN 12164 CW 614N e UNI EN 12164 CW 617N nichelato chimicamente secondo lo standard NSF food program Pinza di Tenuta: acciaio inox AISI 304 O'Ring : Viton conforme FDA
Filettature	Gas Conica BSPT UNI ISO 7 da R1/8" a R1/2" Gas Cilindrica BSPP UNI ISO 228 da G1/8" a G1/2" Metrica ISO/R262
Pressione d'esercizio	vedi tabella
Temperatura d'esercizio	da -20°C a +150°C
Tubi da utilizzare	Poliammide (PA) - Polietilene (PE) PTFE Calibrato - FEP calibrato

### Technical specifications

applications	pneumatics, & fluids, industrial & food applications
materials used	body: nickel plated brass UNI EN 12164 CW 614N & UNI EN 12164 CW 617N with nickel plated chemical coating NSF certified collet: nickel plated brass UNI EN 12164 CW 614N & UNI EN 12164 CW 617N with nickel plated chemical coating NSF certified lock claw: stainless steel AISI 304 o'ring: Viton FDA
threads	taper Gas Thread ISO 7 from R1/8" to R1/2" Cylindrical Gas ISO 228 from G1/8" to G1/2" Metric ISO/R262
working pressure	see technical table
working temperature	from -20°C to +150°C
tubes used	Polyamide (PA) - Polyethylene (PE) calibrated PTFE - calibrated FEP

Prodotti conformi alla direttiva 2002/95/EC **RoHS**

products in conformity with the directive 2002/95/EC **RoHS**

**Disponibile su richiesta la nichelatura alimentare NSF anche per la raccorderia alimentare in ottone (serie 1000) e la raccorderia a calzamento in ottone (serie 2500)**  
**available on demand nickel plated coating NSF also for standard fittings in brass (series 1000) & push-on fittings in brass (series 2500).**

I dati tecnici e le quote non sono vincolanti • drawings and technical data are not binding

diritto maschio cilindrico BSPP e metrico con OR • male connector BSPP & metric thread with OR

**HFC**



CODE	Ø D	T	Ø P	I	L	H1(Hex)	H2(Hex)	Peso Weight(g)	
HFC 04M5	4	M5	9,0	4,0	20,5	-	2,5	5,0	100
HFC 04G01		G1/8"	13,5	5,5	19,5	9,0	2,5	9,0	100
HFC 04G02		G1/4"	17,0	6,5	19,5	9,0	2,5	12,0	100
HFC 06M5	6	M5	11,0	4,0	23,8	-	2,5	8,0	100
HFC 06G01		G1/8"	13,5	5,5	24,8	11,0	4,0	12,0	100
HFC 06G02		G1/4"	17,0	6,5	22,8	11,0	4,0	16,0	50
HFC 08G01	8	G1/8"	12,8	5,5	26,5	13,0	5,0	14,0	50
HFC 08G02		G1/4"	17,0	6,5	24,0	13,0	6,0	15,0	50
HFC 08G03		G3/8"	20,0	7,5	24,0	13,0	6,0	22,0	50
HFC 10G02	10	G1/4"	16,0	6,5	28,9	16,0	7,0	23,0	50
HFC 10G03		G3/8"	21,0	7,5	29,4	16,0	8,0	31,0	25
HFC 12G02		G1/4"	16,0	6,5	31,9	19,0	7,0	33,0	25
HFC 12G03	12	G3/8"	22,0	7,5	31,9	19,0	10,0	38,0	25
HFC 12G04		G1/2"	24,0	9,0	31,2	19,0	10,0	44,0	25

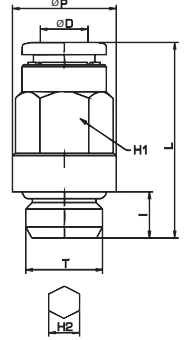

diritto maschio conico BSPT • male connector BSPT thread

CODE	Ø D	T	I	L	H1(Hex)	H2(Hex)	Peso Weight(g)	
HFC 04R01	4	R1/8"	8,0	19,5	10,0	2,5	8,0	100
HFC 04R02		R1/4"	11,0	21,5	14,0	2,5	17,0	100
HFC 06R01	6	R1/8"	8,0	24,8	11,0	4,0	11,0	100
HFC 06R02		R1/4"	11,0	23,8	14,0	4,0	18,0	100
HFC 08R01	8	R1/8"	8,0	28,0	13,0	5,0	14,0	50
HFC 08R02		R1/4"	11,0	24,0	14,0	6,0	14,0	50
HFC 08R03		R3/8"	11,5	24,5	17,0	6,0	25,0	50
HFC 10R02	10	R1/4"	11,0	28,9	16,0	7,0	20,0	50
HFC 12R03		R3/8"	11,5	32,0	19,0	10,0	33,0	25

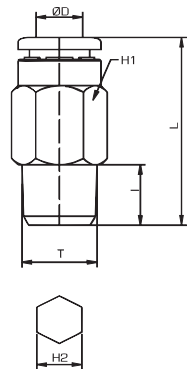

adattatore cilindrico BSPP e metrico con OR • stem adapter BSPP & metric thread with OR

**HFA**



CODE	Ø D	T	Ø P	Ø C1	Ø C2	I	L	H(Hex)	Peso Weight(g)	
HFA 04M5	4	M5	8	2,0	2,0	4,0	24,2	8	3,0	100
HFA 04G01		G1/8"	13	6,0	2,0	5,5	27,7	13	8,0	100
HFA 04G02		G1/4"	16	7,5	2,0	6,5	30,7	13	11,0	100
HFA 06G01	6	G1/8"	13	6,0	4,0	5,5	31,0	13	9,0	100
HFA 06G02		G1/4"	16	7,5	4,0	6,5	33,5	13	12,0	50
HFA 08G01	8	G1/8"	13	6,0	6,0	5,5	32,5	13	9,0	100
HFA 08G02		G1/4"	16	7,5	6,0	6,5	35,0	13	13,0	50
HFA 10G02		G1/4"	16	7,5	8,0	6,5	38,0	13	13,0	50
HFA 10G03	10	G3/8"	20	9,0	8,0	7,5	41,0	13	24,0	50
HFA 12G03		G3/8"	20	11,0	10,0	7,5	42,0	13	20,0	25
HFA 12G04	12	G1/2"	24	13,0	10,0	9,0	44,0	16	30,0	10

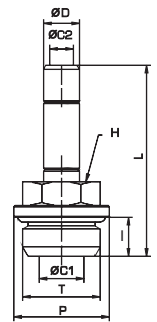

diritto femmina cilindrico BSPP • female connector BSPP thread

**HFCF**



CODE	Ø D	T	Ø P	L	H(Hex)	Peso Weight(g)	
HFCF 04G01	4	G1/8"	12,0	26,5	9,0	12,0	100
HFCF 04G02		G1/4"	17,0	29,5	9,0	25,0	50
HFCF 06G01	6	G1/8"	12,0	28,3	11,0	12,0	50
HFCF 06G02		G1/4"	17,0	31,3	11,0	21,0	50
HFCF 08G01	8	G1/8"	12,0	28,5	13,0	16,0	50
HFCF 08G02		G1/4"	17,0	32,5	13,0	22,0	50

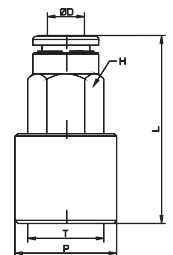

passaparete • bulkhead connector

**HFMM**



CODE	Ø D	T	L	l max	Peso Weight(g)	
HFMM 0400	4	M11	32,0	8	17,0	50
HFMM 0600	6	M14	36,1	8	28,0	50
HFMM 0800	8	M16	38,0	10	35,0	25
HFMM 1000	10	M18	42,3	12	51,0	20
HFMM 1200	12	M22	45,8	17	89,0	10

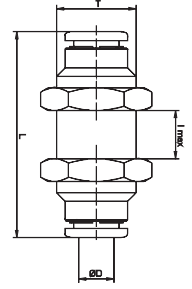

gomito maschio girevole cilindrico BSPP e metrico con OR • swivel male elbow BSPP & metric thread with OR

**HFL**



CODE	Ø D	T	Ø P	L1	L2	H(Hex)	Peso Weight(g)	
HFL 04M5		M5	9,0	17,3	20,0	8,0	10,0	100
HFL 04G01	4	G1/8"	11,0	17,3	18,5	13,0	16,0	50
HFL 04G02		G1/4"	9,0	19,0	22,5	16,0	22,0	50
HFL 06M5		M5	11,0	20,0	20,6	8,0	15,0	100
HFL 06G01	6	G1/8"	11,0	20,6	18,5	13,0	17,0	50
HFL 06G02		G1/4"	11,0	22,1	22,5	16,0	24,0	50
HFL 08G01		G1/8"	13,0	23,0	20,5	13,0	21,0	50
HFL 08G02	8	G1/4"	13,0	23,0	22,5	16,0	23,0	50
HFL 08G03		G3/8"	13,0	24,5	25,5	18,0	33,0	25
HFL 10G02		G1/4"	16,0	26,4	24,5	16,0	33,0	25
HFL 10G03	10	G3/8"	16,0	26,4	25,5	18,0	37,0	25
HFL 12G02		G1/4"	19,0	28,9	24,5	16,0	44,0	25
HFL 12G03		G3/8"	19,0	28,9	24,5	18,0	53,0	15
HFL 12G04		G1/2"	19,0	28,9	31,0	21,0	68,0	15

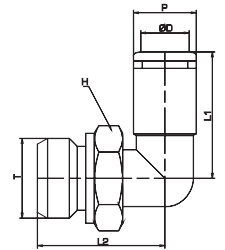

gomito maschio girevole conico BSPT • swivel male elbow BSPT thread



CODE	Ø D	T	Ø P	I	L1	L2	H(Hex)	Peso Weight(g)	
HFL 04R01		R1/8"	11,0	8,0	17,7	18,6	13,0	17,0	50
HFL 04R02	4	R1/4"	9,0	11,0	19,0	23,5	14,0	20,0	50
HFL 06R01		R1/8"	11,0	8,0	19,8	18,6	13,0	16,0	50
HFL 06R02	6	R1/4"	11,0	11,0	22,1	23,5	14,0	22,0	50
HFL 08R01		R1/8"	13,0	8,0	23,0	20,5	13,0	21,0	50
HFL 08R02	8	R1/4"	13,0	11,0	23,0	23,5	14,0	23,0	50
HFL 08R03		R3/8"	13,0	11,5	24,5	26,5	17,0	28,0	25
HFL 10R02		R1/4"	16,0	11,0	26,4	25,5	14,0	33,0	25
HFL 10R03	10	R3/8"	16,0	11,5	26,4	26,5	17,0	37,0	25
HFL 12R02		R1/4"	19,0	11,0	28,9	26,5	14,0	46,0	20
HFL 12R03	12	R3/8"	19,0	11,5	28,9	28,1	17,0	51,0	20

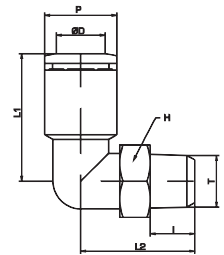

T maschio girevole cilindrico BSPP e metrico con OR • swivel male tee BSPP & metric thread with OR

**HFT**



CODE	Ø D	T	Ø P	L1	L2	H(Hex)	Peso Weight(g)	
HFT 04M5		M5	9,0	17,3	20,0	8,0	15,0	50
HFT 04G01	4	G1/8"	11,0	17,3	18,5	13,0	22,0	50
HFT 06G01		G1/8"	11,0	20,6	18,5	13,0	23,0	50
HFT 06G02	6	G1/4"	11,0	22,1	22,5	16,0	30,0	25
HFT 08G01		G1/8"	13,0	23,0	20,5	13,0	29,0	25
HFT 08G02	8	G1/4"	13,0	23,0	22,5	16,0	32,0	25
HFT 08G03		G3/8"	13,0	24,5	25,5	18,0	41,0	25
HFT 10G02		G1/4"	16,0	26,4	24,5	16,0	48,0	20
HFT 10G03	10	G3/8"	16,0	26,4	25,5	18,0	50,0	10
HFT 12G02		G1/4"	19,0	28,9	24,5	16,0	65,0	10
HFT 12G03		G3/8"	19,0	28,9	24,5	18,0	70,0	10
HFT 12G04	12	G1/2"	19,0	28,9	31,0	21,0	89,0	10

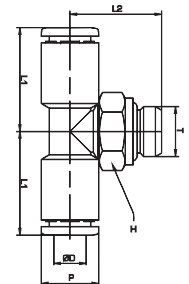

T maschio girevole conico BSPT • swivel male tee BSPT thread

**HFT**



CODE	Ø D	T	Ø P	I	L1	L2	H(Hex)	Peso Weight(g)	
HFT 04R01	4	R1/8"	11,0	8,0	17,3	18,6	13,0	21,0	50
HFT 06R01	6	R1/8"	11,0	8,0	19,8	18,6	13,0	23,0	50
HFT 06R02	6	R1/4"	11,0	11,0	22,1	23,5	14,0	30,0	25
HFT 08R01	8	R1/8"	13,0	8,0	23,0	20,5	13,0	29,0	25
HFT 08R02	8	R1/4"	13,0	11,0	23,0	23,5	14,0	31,0	25
HFT 10R02	10	R1/4"	16,0	11,0	26,4	25,5	14,0	46,0	10
HFT 12R02	12	R1/4"	19,0	14,0	30,2	25,4	14,0	65,0	10
HFT 12R03	12	R3/8"	19,0	11,5	28,9	28,3	17,0	70,0	10

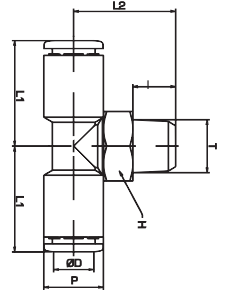

**HFUC**



intermedio diritto • union connector

CODE	Ø D	Ø P	L	Peso Weight(g)	
HFUC 0400	4	11	32,0	13,0	100
HFUC 0600	6	13	36,1	19,0	50
HFUC 0800	8	15	38,0	24,0	25
HFUC 1000	10	18	42,3	42,0	25
HFUC 1200	12	21	45,8	62,0	10

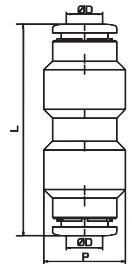

**HFUL**



intermedio a gomito • union elbow

CODE	Ø D	Ø P	L	Peso Weight(g)	
HFUL 0400	4	9	17,3	9,0	100
HFUL 0600	6	11	20,6	14,0	50
HFUL 0800	8	13	23,0	18,0	50
HFUL 1000	10	16	26,4	30,0	25
HFUL 1200	12	19	28,9	50,0	20

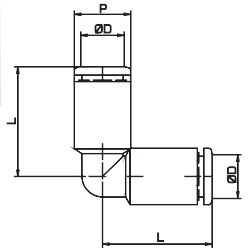

**HFUT**



intermedio a T • union tee

CODE	Ø D	Ø P	L	Peso Weight(g)	
HFUT 0400	4	9	17,3	14,0	50
HFUT 0600	6	11	20,6	20,0	50
HFUT 0800	8	13	23,0	30,0	25
HFUT 1000	10	16	26,4	41,0	10
HFUT 1200	12	19	28,9	69,0	10

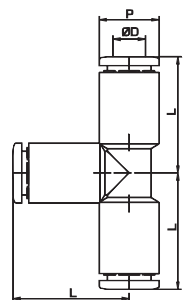

riduzione codolo tubo • reducer stem-tube

**HFGJ**



CODE	Ø D1	Ø D2	Ø P	L	Peso Weight(g)	
HFGJ 0604	6	4	9	32,5	7,0	50
HFGJ 0806	8	6	11	36,3	10,0	50
HFGJ 1008	10	8	13	39,0	14,0	50
HFGJ 1210	12	10	16	41,4	21,0	25

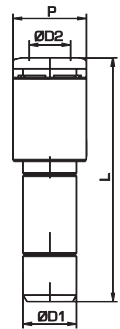

tappo maschio • male plug

**HFPP**



CODE	Ø D	P	L	Peso Weight(g)	
HFPP 04	4	5	26,0	4,0	50
HFPP 06	6	7	29,0	5,0	50
HFPP 08	8	9	31,5	8,0	50
HFPP 10	10	11	35,0	11,0	50
HFPP 12	12	13	37,0	15,0	10

